

Plug

Connector

- 60 Amp 600VAC/250VDC; 50-400 Hertz NEMA 3, 4, 4X<sup>①</sup>
- **PLUGS ONLY**<sup>②</sup>:  
 Class I, Div. 1 & 2, Groups B,C,D; NEMA 7 B,C,D  
 Class I, Zones 1 & 2, IIB+H<sub>2</sub>, IIA  
 Class II, Div. 1 & 2, Groups F & G; NEMA 9 F,G; Class III

**Wire Range**

Regular Stranding: #6 - #4

Extra flex: #6 - #4

File No. E10757 Certified File No. LR111846

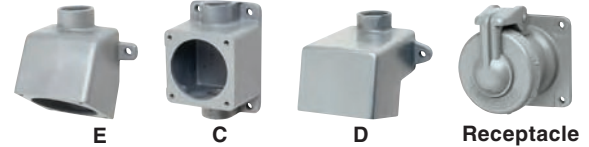

E

C

D

Receptacle

**FEATURES-SPECIFICATIONS**

| 60 AMP PLUGS & CONNECTORS |         |               |                |           |
|---------------------------|---------|---------------|----------------|-----------|
| GROUND STYLE              | CIRCUIT | GROMMET RANGE | CATALOG NUMBER |           |
|                           |         |               | PLUG           | CONNECTOR |
| Style I                   | 2W2P    | .65 - 1.50 IN | VP6275         | VPR6255   |
|                           | 3W3P    | .65 - 1.50 IN | VP6375         | VPR6355   |
|                           | 4W4P    | .65 - 1.50 IN | VP6475         | VPR6455   |
| Style II                  | 2W3P    | .65 - 1.50 IN | VP6385         | VPR6365   |
|                           | 3W4P    | .65 - 1.50 IN | VP6485         | VPR6465   |

| MODIFICATIONS* |   |
|----------------|---|
| CATALOG NUMBER | DESCRIPTION   |
| S39            | Reverse service for receptacles, plugs & connectors |
| S37            | Polarization for receptacles, plugs & connectors    |

\*See page PR5 for more information on these options.

| 60 AMP RECEPTACLES & BACK BOXES |         |                     |                     |                     |                 |
|---------------------------------|---------|---------------------|---------------------|---------------------|-----------------|
| GROUND STYLE                    | CIRCUIT | CATALOG NUMBER      |                     |                     |                 |
|                                 |         | E <sup>③</sup> TYPE | C <sup>③</sup> TYPE | D <sup>③</sup> TYPE | RECEPTACLE ONLY |
| Style I                         | 2W2P    | VR621E4             | VR621C4             | VR621D4             | VR621           |
|                                 | 3W3P    | VR631E4             | VR631C4             | VR631D4             | VR631           |
|                                 | 4W4P    | VR641E4             | VR641C4             | VR641D4             | VR641           |
| Style II                        | 2W3P    | VR632E4             | VR632C4             | VR632D4             | VR632           |
|                                 | 3W4P    | VR642E4             | VR642C4             | VR642D4             | VR642           |
| Splice box only <sup>③</sup>    |         | VRE46               | VRC46               | VRD46               | -               |

<sup>③</sup> 60 Amp Back Boxes are available in 1", 1-1/4" and 1-1/2" conduit sizes. Size listed above is 1-1/4". For other available sizes, change the BOLD "4" in either the assembly or box only number as follows: **3**=1", **4**=1-1/4", **5**=1-1/2". Assembly catalog numbers are listed for ease of ordering or specification and devices are shipped as components. Note: 60 Amp receptacles also fit 100 Amp mounting boxes – see Note<sup>④</sup> on 100 Amp page PR8.

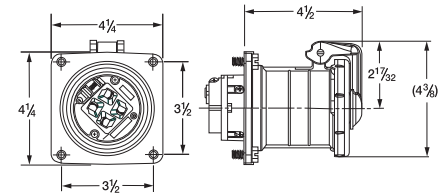

Receptacle

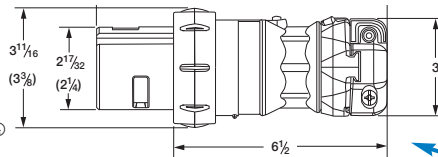

Plug

VersaRange<sup>®</sup> clamps provide a firm fit for one plug (or connector) over a wide range of cable diameters (competitors often need two – requiring additional sizing decisions).

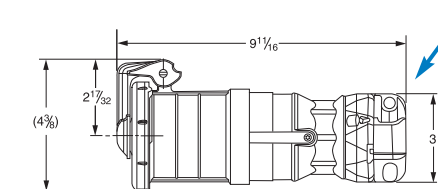

Connector

<sup>①</sup> Components are intermateable & UL classified with other UL1686 configured devices (when installed in accordance with instructions furnished with device). Assemblies containing components from other manufacturers would have the NEMA type rating of the lowest rated device.

<sup>②</sup> Plugs are hazardous suitable when mated with properly rated receptacles configured to use UL1686 type plugs, such as VersaMate VSQ/VBQ.

<sup>④</sup> Dimensions in ( ) are 3 pole devices; balance are 4 pole.

**Back Box Dimensions**

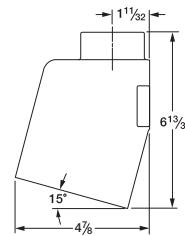

VRE

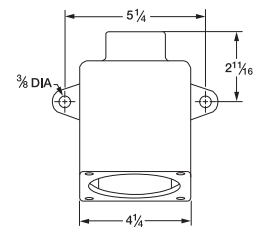

VRC

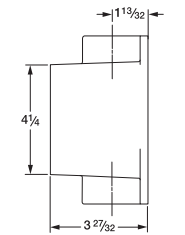

VRD

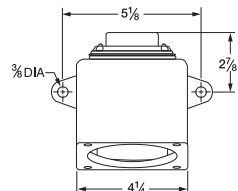
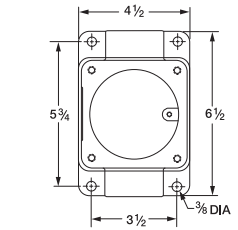
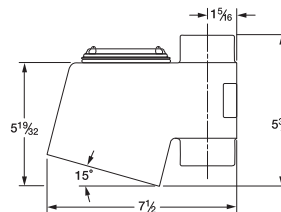

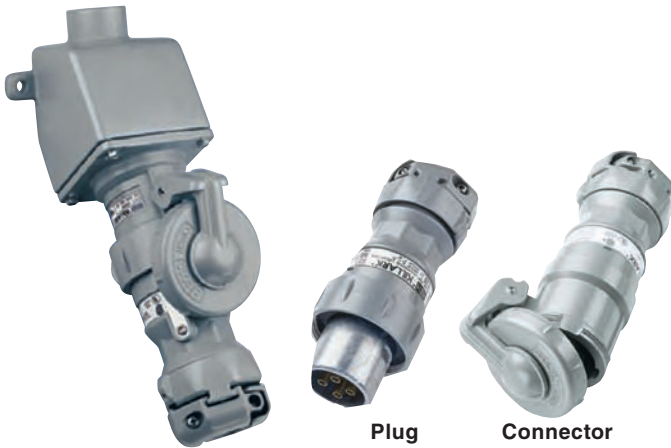

- 60 Amp 600VAC/250VDC; 50-400 Hertz NEMA 3, 4, 4X<sup>①</sup>
- **PLUGS ONLY**<sup>②</sup>:  
 Class I, Div. 1 & 2, Groups B,C,D; NEMA 7 B,C,D  
 Class I, Zones 1 & 2, IIB+H<sub>2</sub>, IIA  
 Class II, Div. 1 & 2, Groups F & G; NEMA 9 F,G; Class III

**Wire Range**

Regular Stranding: #6 - #4

Extra flex: #6 - #4

File No. E10757 Certified File No. LR111846

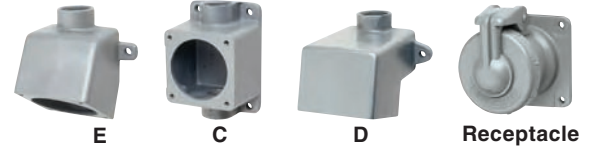

**FEATURES-SPECIFICATIONS**

| 60 AMP PLUGS & CONNECTORS |         |               |                |                |
|---------------------------|---------|---------------|----------------|----------------|
| GROUND STYLE              | CIRCUIT | GROMMET RANGE | CATALOG NUMBER |                |
|                           |         |               | PLUG           | CONNECTOR      |
| Style I                   | 2W2P    | .65 - 1.50 IN | <b>VP6275</b>  | <b>VPR6255</b> |
|                           | 3W3P    | .65 - 1.50 IN | <b>VP6375</b>  | <b>VPR6355</b> |
|                           | 4W4P    | .65 - 1.50 IN | <b>VP6475</b>  | <b>VPR6455</b> |
| Style II                  | 2W3P    | .65 - 1.50 IN | <b>VP6385</b>  | <b>VPR6365</b> |
|                           | 3W4P    | .65 - 1.50 IN | <b>VP6485</b>  | <b>VPR6465</b> |

| MODIFICATIONS* |   |
|----------------|---|
| CATALOG NUMBER | DESCRIPTION   |
| <b>S39</b>     | Reverse service for receptacles, plugs & connectors |
| <b>S37</b>     | Polarization for receptacles, plugs & connectors    |

\*See page PR5 for more information on these options.

| 60 AMP RECEPTACLES & BACK BOXES |         |                     |                     |                     |                 |
|---------------------------------|---------|---------------------|---------------------|---------------------|-----------------|
| GROUND STYLE                    | CIRCUIT | CATALOG NUMBER      |                     |                     |                 |
|                                 |         | E <sup>③</sup> TYPE | C <sup>③</sup> TYPE | D <sup>③</sup> TYPE | RECEPTACLE ONLY |
| Style I                         | 2W2P    | <b>VR621E4</b>      | <b>VR621C4</b>      | <b>VR621D4</b>      | <b>VR621</b>    |
|                                 | 3W3P    | <b>VR631E4</b>      | <b>VR631C4</b>      | <b>VR631D4</b>      | <b>VR631</b>    |
|                                 | 4W4P    | <b>VR641E4</b>      | <b>VR641C4</b>      | <b>VR641D4</b>      | <b>VR641</b>    |
| Style II                        | 2W3P    | <b>VR632E4</b>      | <b>VR632C4</b>      | <b>VR632D4</b>      | <b>VR632</b>    |
|                                 | 3W4P    | <b>VR642E4</b>      | <b>VR642C4</b>      | <b>VR642D4</b>      | <b>VR642</b>    |
| Splice box only <sup>④</sup>    |         | <b>VRE46</b>        | <b>VRC46</b>        | <b>VRD46</b>        | -               |

<sup>③</sup> 60 Amp Back Boxes are available in 1", 1-1/4" and 1-1/2" conduit sizes. Size listed above is 1-1/4". For other available sizes, change the BOLD "4" in either the assembly or box only number as follows: **3**=1", **4**=1-1/4", **5**=1-1/2". Assembly catalog numbers are listed for ease of ordering or specification and devices are shipped as components. Note: 60 Amp receptacles also fit 100 Amp mounting boxes – see Note<sup>④</sup> on 100 Amp page PR8.

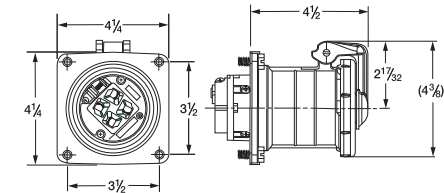

**Receptacle**

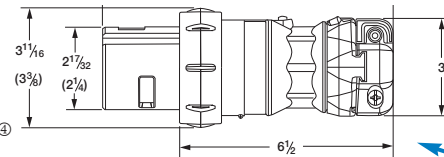

**Plug**

VersaRange<sup>®</sup> clamps provide a firm fit for one plug (or connector) over a wide range of cable diameters (competitors often need two – requiring additional sizing decisions).

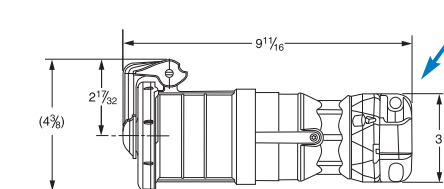

**Connector**

<sup>①</sup> Components are intermateable & UL classified with other UL1686 configured devices (when installed in accordance with instructions furnished with device). Assemblies containing components from other manufacturers would have the NEMA type rating of the lowest rated device.

<sup>②</sup> Plugs are hazardous suitable when mated with properly rated receptacles configured to use UL1686 type plugs, such as VersaMate VSQ/VBQ.

<sup>④</sup> Dimensions in ( ) are 3 pole devices; balance are 4 pole.

**Back Box Dimensions**

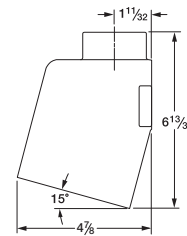

**VRE**

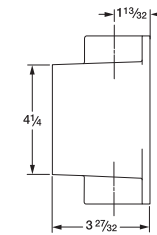
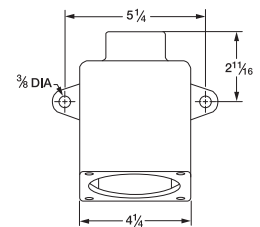

**VRC**

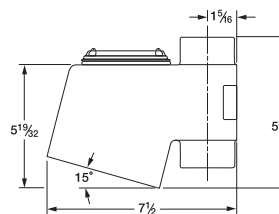
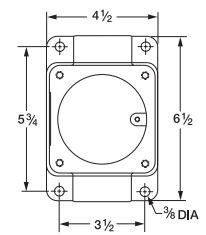

**VRD**

