

38055

WIREMOLD®
Wire Management Systems
60 Woodlawn St. W. Hartford, CT 06110

V5739A

QTY. 1

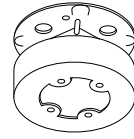

Extension Box Open Base, 6 3/8" (162mm) Diameter
Boite de Prolongation, Base Ouverte, 162mm (6 3/8") de Diametre
Caja Para Extensión, Base Abierta, 162mm (6 3/8") de Diámetro

Use #8 (5/16", 7.9mm head size) flat head fastener or equivalent to mount base to box.

Utiliser une attache à tête plate de calibre 8 (tête de 7.9mm, 5/16" po.) ou une fixation équivalente pour assujettir le tube guide-fils et les raccords à la surface de montage.

Use un sujetador de cabeza plana No. 8 (tamaño de cabeza: 7.9mm, 5/16" de pulgada) o su equivalente para unir la canalita y los accesorios a la superficie de montaje.

1

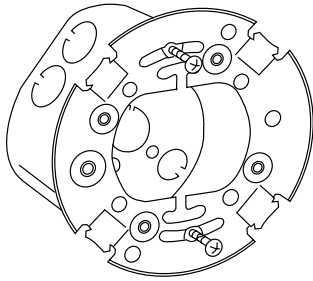

2

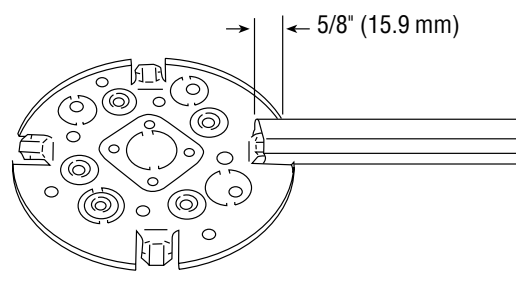

3

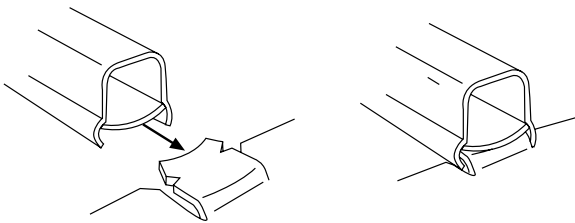

4

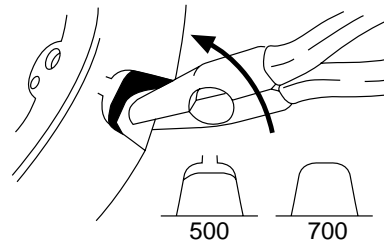

5

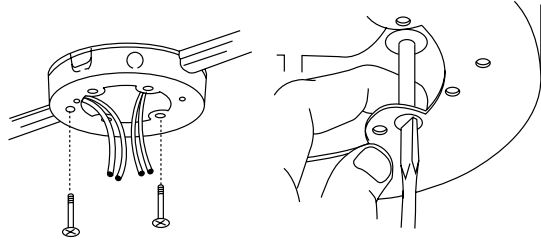

7 86776 07045 3

MADE IN U.S.A.

V5739A
Extension Box Open Base, 6 3/8" (162mm) Diameter
Boite de Prolongation, Base Ouverte, 162mm (6 3/8") de Diametre
Caja Para Extensión, Base Abierta, 162mm (6 3/8") de Diámetro

QTY. 1



60 Woodlawn St. W. Hartford, CT 06110

WIREMOLD®
Wire Management Systems