

Rigid/Intermediate Grade Conduit Fittings

Conduit Locknuts

CONDUIT LOCKNUTS

3/8" - 2" Steel, 2 1/2" - 6" Malleable Iron

UL File No. E-19189



| Cat. # | Size | Unit Qty. | Wt. Lbs. Per 100 |
|--------|--------|-----------|------------------|
| 10 | 3/8" | 100 | 1 |
| 11 | 1/2" | 100 | 1 |
| 12 | 3/4" | 100 | 2 |
| 13 | 1" | 50 | 3 |
| 14 | 1 1/4" | 100 | 4 |
| 15 | 1 1/2" | 50 | 5 |
| 16 | 2" | 50 | 7 |
| 17 | 2 1/2" | 20 | 10 |
| 18 | 3" | 10 | 15 |
| 19 | 3 1/2" | 10 | 18 |
| 20 | 4" | 5 | 22 |
| 22 | 5" | 2 | 79 |
| 23 | 6" | 1 | 166 |

THIN CONSTRUCTION LOCKNUTS – STEEL



| Cat. # | Size | Unit Qty. | Wt. Lbs. Per 100 |
|--------|--------|-----------|------------------|
| 11X | 1/2" | 500 | 1 |
| 12X | 3/4" | 100 | 1 |
| 13X | 1" | 50 | 3 |
| 14X | 1 1/4" | 100 | 3 |
| 15X | 1 1/2" | 50 | 4 |
| 16X | 2" | 50 | 4 |
| 17X | 2 1/2" | 25 | 10 |
| 18X | 3" | 20 | 15 |
| 19X | 3 1/2" | 10 | 18 |
| 20X | 4" | 10 | 22 |

CONDUIT LOCKNUTS – ALUMINUM



| Cat. # | Size | Unit Qty. | Wt. Lbs. Per 100 |
|--------|--------|-----------|------------------|
| 11 SA | 1/2" | 100 | 1 |
| 12 SA | 3/4" | 100 | 1 |
| 13 SA | 1" | 50 | 1 |
| 14 SA | 1 1/4" | 100 | 2 |
| 15 SA | 1 1/2" | 50 | 2 |
| 16 SA | 2" | 50 | 3 |
| 17 SA | 2 1/2" | 20 | 9 |
| 18 SA | 3" | 10 | 13 |
| 19 SA | 3 1/2" | 10 | 16 |
| 20 SA | 4" | 5 | 52 |

CONDUIT LOCKNUTS – ZINC DIE CAST



| Cat. # | Size | Unit Qty. | Wt. Lbs. Per 100 |
|--------|--------|-----------|------------------|
| 11DC | 1/2" | 400 | 1 |
| 12DC | 3/4" | 250 | 1 |
| 13DC | 1" | 100 | 2 |
| 14DC | 1 1/4" | 60 | 3 |
| 15DC | 1 1/2" | 50 | 5 |
| 16DC | 2" | 30 | 8 |
| 17DC | 2 1/2" | 20 | 10 |
| 18DC | 3" | 15 | 15 |
| 19DC | 3 1/2" | 10 | 16 |
| 20DC | 4" | 10 | 19 |

BONDING LOCKNUTS – STEEL

Applications:

- For use with bushing to bond 1/2" to 4" rigid conduit to boxes, cabinets or other enclosures, only where a locknut is exposed.

UL File No. E-6225



| Cat. # | Size | Unit Qty. | Wt. Lbs. Per 100 |
|--------|--------|-----------|------------------|
| GL 11 | 1/2" | 100 | 2 |
| GL 12 | 3/4" | 50 | 3 |
| GL 13 | 1" | 50 | 4 |
| GL 14 | 1 1/4" | 50 | 6 |
| GL 15 | 1 1/2" | 50 | 7 |
| GL 16 | 2" | 25 | 9 |
| GL 17 | 2 1/2" | 20 | 28 |
| GL 18 | 3" | 10 | 38 |
| GL 19 | 3 1/2" | 10 | 48 |
| GL 20 | 4" | 5 | 52 |

SELF-RETAINING PVC GASKET WITH STEEL RING

UL File No. E-22133



| Cat. # | Size | Unit Qty. | Wt. Lbs. Per 100 |
|--------|-------------|-----------|------------------|
| SG1 | 3/8" - 1/2" | 100 | 1 |
| SG2 | 3/4" | 50 | 2 |
| SG3 | 1" | 50 | 2 |
| SG4 | 1 1/4" | 25 | 2 |
| SG5 | 1 1/2" | 25 | 4 |
| SG6 | 2" | 25 | 3 |
| SG7 | 2 1/2" | 10 | 5 |
| SG8 | 3" | 10 | 10 |
| SG9 | 3 1/2" | 10 | 12 |
| SG10 | 4" | 10 | 10 |
| SG11 | 5" | 5 | 15 |
| SG12 | 6" | 5 | 22 |

Rigid/Intermediate Grade Conduit Fittings

Sealing Locknuts & Bush-Lok™ Bushing/Locknut Combination Fittings

SEALING LOCKNUTS

Applications:

Only one sealing locknut is required to:

- Functionally replace rigid threaded enclosure connectors
- Provide raintight, watertight or oiltight seal in any position
- Provide positive ground connection
- Provide economies in installation and fitting costs

Features:

- Integrally fused PVC gasket provides positive seal against water, oils and other liquids
- Designed for use with raintight, watertight and oiltight enclosures, NEMA 2, 3, 3R, 4 and 12
- UL Listed raintight
- UL Listed liquidtight
- Can be used with either sheet metal or standard cast metal boxes
- 1/2" to 2" heavy duty steel
- 2 1/2" to 6" malleable iron

UL File No. E-19189

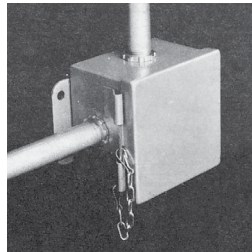
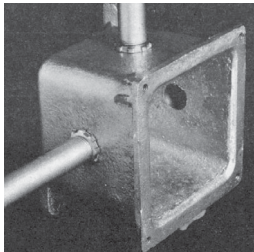

| Cat. # | Size | Unit Qty. | Wt. Lbs. Per 100 |
|--------|--------|-----------|------------------|
| SL1 | 1/2" | 100 | 1 |
| SL2 | 3/4" | 50 | 2 |
| SL3 | 1" | 25 | 4 |
| SL4 | 1 1/4" | 25 | 4 |
| SL5 | 1 1/2" | 25 | 5 |
| SL6 | 2" | 25 | 8 |
| SL7 | 2 1/2" | 10 | 28 |
| SL8 | 3" | 10 | 38 |
| SL9 | 3 1/2" | 10 | 46 |
| SL10 | 4" | 5 | 52 |
| SL11 | 5" | 2 | 125 |
| SL12 | 6" | 1 | 140 |

BUSH-LOK™ BUSHING/LOCKNUT COMBINATION FITTINGS – STEEL 150°C Rated

Patented!

Applications:

- The Bush-Lok eliminates the need to use a locknut and bushing when entering a box or enclosure; it's an all-in-one bushing/locknut combination that allows the installer to use one fitting instead of having to piece together parts; also solves the problem of not enough thread left to engage the bushing after installing a locknut into a box or enclosure
- For use with rigid/IMC conduit and with other threaded fittings

Features:

- Offered in most common trade sizes – 1/2", 3/4" and 1"
- NPSM – straight threads
- The innovative bushing/locknut combination uses one fitting instead of having to piece together parts
- Bush-Lok solves the problem of installing a locknut and a bushing and then not having enough thread left to engage the bushing
- Allows for more working capacity inside a box or enclosure
- Non-metallic insuliner will not chip, crack, swell or shrink; it resists corrosion, chemicals and temperature extremes and provides a smooth pulling surface for conductors
- Angled teeth on body provide solid connection for ground continuity and a secure installation

Certifications and Compliances:

- cULus
- UL File No. E-19189

Standard Materials and Finishes:

- Body – steel, zinc plated
- Insuliner – non-metallic, high temperature rated up to 150°C

UL File No. E-19189

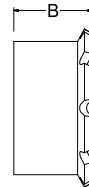
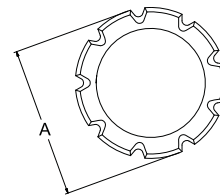

| Cat. # | Size | Dim. A | Dim. B | Unit Qty. | Wt. Lbs. Per 100 |
|--------|------|---------|--------|-----------|------------------|
| BLK50 | 1/2" | 1 1/8" | 5/8" | 50 | 3.5 |
| BLK75 | 3/4" | 1 7/16" | 11/16" | 50 | 5.4 |
| BLK100 | 1" | 1 3/4" | 13/16" | 50 | 9.4 |

Rigid/Intermediate Grade Conduit Fittings

Conduit Locknuts

CONDUIT LOCKNUTS

3/8" - 2" Steel, 2 1/2" - 6" Malleable Iron

UL File No. E-19189



| Cat. # | Size | Unit Qty. | Wt. Lbs. Per 100 |
|--------|--------|-----------|------------------|
| 10 | 3/8" | 100 | 1 |
| 11 | 1/2" | 100 | 1 |
| 12 | 3/4" | 100 | 2 |
| 13 | 1" | 50 | 3 |
| 14 | 1 1/4" | 100 | 4 |
| 15 | 1 1/2" | 50 | 5 |
| 16 | 2" | 50 | 7 |
| 17 | 2 1/2" | 20 | 10 |
| 18 | 3" | 10 | 15 |
| 19 | 3 1/2" | 10 | 18 |
| 20 | 4" | 5 | 22 |
| 22 | 5" | 2 | 79 |
| 23 | 6" | 1 | 166 |

THIN CONSTRUCTION LOCKNUTS – STEEL



| Cat. # | Size | Unit Qty. | Wt. Lbs. Per 100 |
|--------|--------|-----------|------------------|
| 11X | 1/2" | 500 | 1 |
| 12X | 3/4" | 100 | 1 |
| 13X | 1" | 50 | 3 |
| 14X | 1 1/4" | 100 | 3 |
| 15X | 1 1/2" | 50 | 4 |
| 16X | 2" | 50 | 4 |
| 17X | 2 1/2" | 25 | 10 |
| 18X | 3" | 20 | 15 |
| 19X | 3 1/2" | 10 | 18 |
| 20X | 4" | 10 | 22 |

CONDUIT LOCKNUTS – ALUMINUM



| Cat. # | Size | Unit Qty. | Wt. Lbs. Per 100 |
|--------|--------|-----------|------------------|
| 11 SA | 1/2" | 100 | 1 |
| 12 SA | 3/4" | 100 | 1 |
| 13 SA | 1" | 50 | 1 |
| 14 SA | 1 1/4" | 100 | 2 |
| 15 SA | 1 1/2" | 50 | 2 |
| 16 SA | 2" | 50 | 3 |
| 17 SA | 2 1/2" | 20 | 9 |
| 18 SA | 3" | 10 | 13 |
| 19 SA | 3 1/2" | 10 | 16 |
| 20 SA | 4" | 5 | 52 |

CONDUIT LOCKNUTS – ZINC DIE CAST



| Cat. # | Size | Unit Qty. | Wt. Lbs. Per 100 |
|--------|--------|-----------|------------------|
| 11DC | 1/2" | 400 | 1 |
| 12DC | 3/4" | 250 | 1 |
| 13DC | 1" | 100 | 2 |
| 14DC | 1 1/4" | 60 | 3 |
| 15DC | 1 1/2" | 50 | 5 |
| 16DC | 2" | 30 | 8 |
| 17DC | 2 1/2" | 20 | 10 |
| 18DC | 3" | 15 | 15 |
| 19DC | 3 1/2" | 10 | 16 |
| 20DC | 4" | 10 | 19 |

BONDING LOCKNUTS – STEEL

Applications:

- For use with bushing to bond 1/2" to 4" rigid conduit to boxes, cabinets or other enclosures, only where a locknut is exposed.

UL File No. E-6225



| Cat. # | Size | Unit Qty. | Wt. Lbs. Per 100 |
|--------|--------|-----------|------------------|
| GL 11 | 1/2" | 100 | 2 |
| GL 12 | 3/4" | 50 | 3 |
| GL 13 | 1" | 50 | 4 |
| GL 14 | 1 1/4" | 50 | 6 |
| GL 15 | 1 1/2" | 50 | 7 |
| GL 16 | 2" | 25 | 9 |
| GL 17 | 2 1/2" | 20 | 28 |
| GL 18 | 3" | 10 | 38 |
| GL 19 | 3 1/2" | 10 | 48 |
| GL 20 | 4" | 5 | 52 |

SELF-RETAINING PVC GASKET WITH STEEL RING

UL File No. E-22133



| Cat. # | Size | Unit Qty. | Wt. Lbs. Per 100 |
|--------|-------------|-----------|------------------|
| SG1 | 3/8" - 1/2" | 100 | 1 |
| SG2 | 3/4" | 50 | 2 |
| SG3 | 1" | 50 | 2 |
| SG4 | 1 1/4" | 25 | 2 |
| SG5 | 1 1/2" | 25 | 4 |
| SG6 | 2" | 25 | 3 |
| SG7 | 2 1/2" | 10 | 5 |
| SG8 | 3" | 10 | 10 |
| SG9 | 3 1/2" | 10 | 12 |
| SG10 | 4" | 10 | 10 |
| SG11 | 5" | 5 | 15 |
| SG12 | 6" | 5 | 22 |

Rigid/Intermediate Grade Conduit Fittings

Sealing Locknuts & Bush-Lok™ Bushing/Locknut Combination Fittings

SEALING LOCKNUTS

Applications:

Only one sealing locknut is required to:

- Functionally replace rigid threaded enclosure connectors
- Provide raintight, watertight or oiltight seal in any position
- Provide positive ground connection
- Provide economies in installation and fitting costs

Features:

- Integrally fused PVC gasket provides positive seal against water, oils and other liquids
- Designed for use with raintight, watertight and oiltight enclosures, NEMA 2, 3, 3R, 4 and 12
- UL Listed raintight
- UL Listed liquidtight
- Can be used with either sheet metal or standard cast metal boxes
- ½" to 2" heavy duty steel
- 2½" to 6" malleable iron

UL File No. E-19189

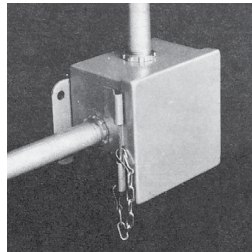
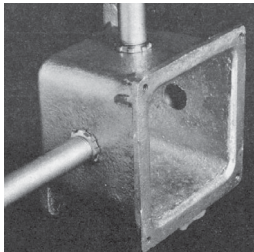

| Cat. # | Size | Unit Qty. | Wt. Lbs. Per 100 |
|--------|------|-----------|------------------|
| SL1 | ½" | 100 | 1 |
| SL2 | ¾" | 50 | 2 |
| SL3 | 1" | 25 | 4 |
| SL4 | 1¼" | 25 | 4 |
| SL5 | 1½" | 25 | 5 |
| SL6 | 2" | 25 | 8 |
| SL7 | 2½" | 10 | 28 |
| SL8 | 3" | 10 | 38 |
| SL9 | 3½" | 10 | 46 |
| SL10 | 4" | 5 | 52 |
| SL11 | 5" | 2 | 125 |
| SL12 | 6" | 1 | 140 |

BUSH-LOK™ BUSHING/LOCKNUT COMBINATION FITTINGS – STEEL

150°C Rated

Patented!

Applications:

- The Bush-Lok eliminates the need to use a locknut and bushing when entering a box or enclosure; it's an all-in-one bushing/locknut combination that allows the installer to use one fitting instead of having to piece together parts; also solves the problem of not enough thread left to engage the bushing after installing a locknut into a box or enclosure
- For use with rigid/IMC conduit and with other threaded fittings

Features:

- Offered in most common trade sizes – ½", ¾" and 1"
- NPSM – straight threads
- The innovative bushing/locknut combination uses one fitting instead of having to piece together parts
- Bush-Lok solves the problem of installing a locknut and a bushing and then not having enough thread left to engage the bushing
- Allows for more working capacity inside a box or enclosure
- Non-metallic insuliner will not chip, crack, swell or shrink; it resists corrosion, chemicals and temperature extremes and provides a smooth pulling surface for conductors
- Angled teeth on body provide solid connection for ground continuity and a secure installation

Certifications and Compliances:

- cULus
- UL File No. E-19189

Standard Materials and Finishes:

- Body – steel, zinc plated
- Insuliner – non-metallic, high temperature rated up to 150°C

UL File No. E-19189

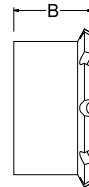
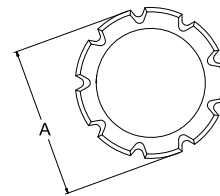

| Cat. # | Size | Dim. A | Dim. B | Unit Qty. | Wt. Lbs. Per 100 |
|--------|------|---------|--------|-----------|------------------|
| BLK50 | ½" | 1 1/8" | 5/8" | 50 | 3.5 |
| BLK75 | ¾" | 1 7/16" | 11/16" | 50 | 5.4 |
| BLK100 | 1" | 1 3/4" | 13/16" | 50 | 9.4 |