

## FLEXIBLE METAL CONDUITS - STEEL

# UL Reduced Wall Steel Type RW FSC (5500 Series)

### Description

- Reduced Wall Flexible Steel Conduit
- High grade hot dipped zinc galvanized low carbon steel
- Interlocking design
- Corrosion resistant
- Trade sizes 1-1/2 through 4 are made with no solder joints

### Applications

*Suitable for use in:*

- Flexible Steel Conduit (FSC): A raceway of circular cross-section made of helically wound, interlocked galvanized steel strip.
- Accordance with NEC® Article 348 Flexible Metal Conduit Type FMC
- Exposed and concealed locations
- Utilization equipment per NEC® 348.20(A)(2)(a)
- Suitable as part of a listed assembly per NEC® 348.20(A)(2)(b)
- Equipment ground in accordance with NEC® 250.118(5)
- Other Spaces Used for Environmental Air (Plenums) per NEC® 300.22(C)
- Cable Trays per NEC® 392.10(A) and Table 392.10(A)
- Raceway for Tap Conductors for Luminaires per NEC® 348.20(A)(2)(c) and 410.117(C)
- Connection to a motor terminal enclosure per NEC® 430.223
- Class I Division 2 per NEC® 501.10(B)(2)(2)
- Neon Secondary-Circuit Wiring 1000V or Less per NEC® 600.31(A)
- Neon Secondary-Circuit Wiring Over 1000V per NEC® 600.32(A)(1)
- Manufactured Wiring Systems per 604.100(A)(2)
- Elevators, Dumbwaiters, Escalators, Moving walks, Platform and Stairway Chairlifts per NEC® 620.21
- Under Raised Floors per NEC® 645.5(E)(1)(b)(10)
- Solar Photovoltaic (PV) Systems per NEC® 690.31(A)
- Fuel Cell Systems per NEC® 692.31
- Wind Electric Systems per NEC® 694.30(A)
- Critical Operations Power Systems (COPS) where flexibility is required per NEC® 708.10(C)(1)(3)(b)
- Optical Fiber Cables for installation within buildings per NEC® 770.110(A)(1)
- Communications Circuit Wires and Cables for installation within buildings per NEC® 800.110(A)(1)
- Community Antenna Television and Radio Coaxial Cables for installation within buildings per NEC® 820.110(A)(1)
- Low and Medium Power Network-Powered Broadband Cables for installation within buildings per NEC® 830.110(A)(1)

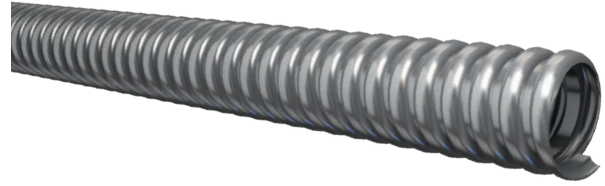

### References & Ratings

- NFPA 70 National Electric Code (NEC®) Articles 348, 250, 300, 392, 410, 423, 430, 501, 600, 604, 620, 645, 690, 692, 694, 708, 770, 800, 820 and 830
- UL 1 Standard for Flexible Metal Conduit UL File Number E11831  
Federal Specification WW-C-566C  
superseded by UL 1
- UL 1479 Fire Tests of Through-Penetration Firestops UL File Number R14141  
UL Classified Through-Penetrating Product for Use in  
Through-Penetration Firestop Systems
- NEMA RV 3 Application and Installation Guidelines for Flexible and  
Liquidtight Flexible Metal Conduits
- C22.2 No. 56 CSA Standard for Flexible Metal Conduit and Liquid-Tight  
Flexible Metal Conduit  
The 3/8 Trade Size is the only Type RW FMC that is CSA Certified

ORDERING INFORMATION						PRODUCT DIMENSIONS/BEND RADIUS		
Product Code	Trade Size (inches)	Trade Size (mm)	Coil Length (feet)	Reel Length (feet)	Approx. Weight/100 feet (pounds)	Internal Diameter (min/max) (inches)	External Diameter (min/max) (inches)	Bend Radius inches
5501-22-00*	3/8	12	25	–	17	0.375/0.393	0.560/0.610	2
5501-24-00*	3/8	12	50	–	17	0.375/0.393	0.560/0.610	2
5501-30-00*	3/8	12	100	–	17	0.375/0.393	0.560/0.610	2
5501-42-00*	3/8	12	250	–	17	0.375/0.393	0.560/0.610	2
5501-45-00*	3/8	12	–	500	17	0.375/0.393	0.560/0.610	2
5501-60-00*	3/8	12	–	1000	17	0.375/0.393	0.560/0.610	2
5502-22-00	1/2	16	25	–	27	0.625/0.645	0.860/0.920	3
5502-24-00	1/2	16	50	–	27	0.625/0.645	0.860/0.920	3
5502-30-00	1/2	16	100	–	27	0.625/0.645	0.860/0.920	3
5502-45-00	1/2	16	–	500	27	0.625/0.645	0.860/0.920	3
5502-60-00	1/2	16	–	1000	27	0.625/0.645	0.860/0.920	3
5503-22-00	3/4	21	25	–	35	0.812/0.835	1.045/1.105	4
5503-24-00	3/4	21	50	–	35	0.812/0.835	1.045/1.105	4
5503-30-00	3/4	21	100	–	35	0.812/0.835	1.045/1.105	4
5503-45-00	3/4	21	–	500	35	0.812/0.835	1.045/1.105	4
5503-60-00	3/4	21	–	1000	35	0.812/0.835	1.045/1.105	4
5504-24-00	1	27	50	–	51	1.000/1.040	1.300/1.380	5
5504-80-00	1	27	–	300	51	1.000/1.040	1.300/1.380	5
5505-24-00	1-1/4	35	50	–	63	1.250/1.300	1.550/1.630	6.25
5505-40-00	1-1/4	35	–	200	63	1.250/1.300	1.550/1.630	6.25
5506-22-00	1-1/2	41	25	–	76	1.500/1.575	1.850/1.950	7.50
5506-35-00	1-1/2	41	–	150	76	1.500/1.575	1.850/1.950	7.50
5506-80-00	1-1/2	41	–	300	76	1.500/1.575	1.850/1.950	7.50
5507-22-00	2	53	25	–	100	2.000/2.080	2.350/2.450	10
5507-30-00	2	53	–	100	100	2.000/2.080	2.350/2.450	10
5507-35-00	2	53	–	150	100	2.000/2.080	2.350/2.450	10
5508-22-00	2-1/2	63	25	–	165	2.500/–	2.860/3.060	12.5
5508-35-00	2-1/2	63	–	150	165	2.500/–	2.860/3.060	12.5
5509-22-00	3	78	25	–	197	3.000/–	3.360/3.560	15
5509-30-00	3	78	–	100	197	3.000/–	3.360/3.560	15
5510-22-00	3-1/2	91	25	–	230	3.500/–	3.860/4.060	17.5
5510-30-00	3-1/2	91	–	100	230	3.500/–	3.860/4.060	17.5
5511-22-00	4	103	25	–	263	4.000/–	4.360/4.560	20
5511-30-00	4	103	–	100	263	4.000/–	4.360/4.560	20

NOTE: All dimensions and weights are subject to normal manufacturing tolerances. \*CSA certified. Review NEC® 348.60 and 250.118(5) for grounding requirements. Continuous length reels with no solder joints or connectors are available on sizes. Review NEC® 348.60 and 250.118(5) for grounding requirements.