

Cast Device Box Covers

FS/FD SINGLE GANG COVER CONFIGURATIONS

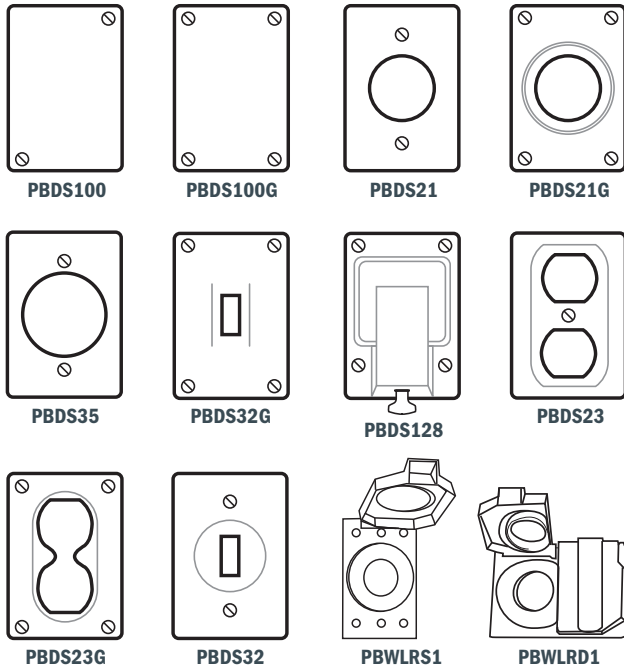

FS/FD 2 GANG COVER CONFIGURATIONS

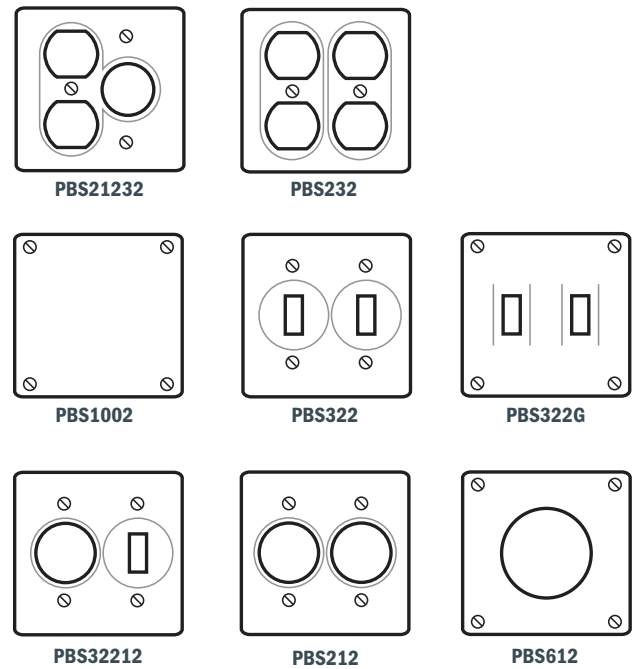

FERROUS COVERS - ONE GANG

| CATALOG # | DESCRIPTION | NOMINAL WEIGHT |
|-----------|---|----------------|
| PBDS32 | GENERAL USE SNAP ON OR TOGGLE (S) | 0.4 |
| PBDS23G | DUPLEX CONVENIENCE RECEPTACLE (S,F) | 0.4 |
| PBDS35 | PLUG RECEPTACLE 1 5/8" DIAMETER (S) | 0.4 |
| PBDS21 | 3P 2W GROUNDING ROUND FLUSH RECEPTACLES (S) | 0.3 |
| PBDS21G | 3P 2W GROUNDING ROUND FLUSH RECEPTACLES (S,F) | 0.3 |
| PBDS23 | DUPLEX CONVENIENCE RECEPTACLE (S) | 0.3 |
| PBDS32G | SQUARE HANDLE SNAP OR TOGGLE (S, F) | 0.4 |

FERROUS COVERS - TWO GANG

| CATALOG # | DESCRIPTION | NOMINAL WEIGHT |
|-----------|---------------------------------------|----------------|
| PBS1002 | BLANK COVER SHEET STEEL (S) | 1.0 |
| PBS1002G | BLANK COVER IRON ALLOY (S,F) | 1.0 |
| PBS21232 | ROUND RECEPTACLE + DUPLEX CONVENIENCE | 1.2 |
| PBS232 | DUPLEX CONVENIENCE (S) | 1.2 |
| PBS322 | SNAP SWITCH (S) | 1.0 |
| PBS32212 | ROUND RECEPTACLE + SNAP SWITCH (S) | 1.2 |
| PBS212 | TWO ROUND RECEPTACLES (S) | 2.0 |
| PBS612 | 20 AMP, 250 VOLT RECEPTACLE (S) | 1.2 |
| PBS322G | SNAP SWITCHES IRON ALLOY (S,F) | 1.2 |

ALUMINUM COVERS - ONE GANG

| CATALOG # | DESCRIPTION | NOMINAL WEIGHT |
|-----------|---|----------------|
| PBDS23SA | DUPLEX CONVENIENCE RECEPTACLE (S) | 0.1 |
| PBDS100 | BLANK COVER (S) | 0.1 |
| PBDS128 | SNAP SWITCH | 0.5 |
| PBDS100G | BLANK COVER CAST (S,F) | 0.3 |
| PBWLRD1 | SPRING DOOR DUPLEX COVER 1 3/8" (F) | 0.4 |
| PBWLR1 | SPRING DOOR SINGLE COVER 1 3/8" (F) | 0.3 |
| PBWLR2 | SPRING DOOR SINGLE COVER 1 1/2" (F) | 0.3 |
| PRWLG-FS | SPRING DOOR COVER FOR GFCI (S) - HORIZONTAL | 0.5 |
| PRWLG-FSV | SPRING DOOR COVER FOR GFCI (S) - VERTICAL | 0.5 |
| PRWLG-F | SPRING DOOR COVER FOR GFCI (F) - HORIZONTAL | 0.5 |

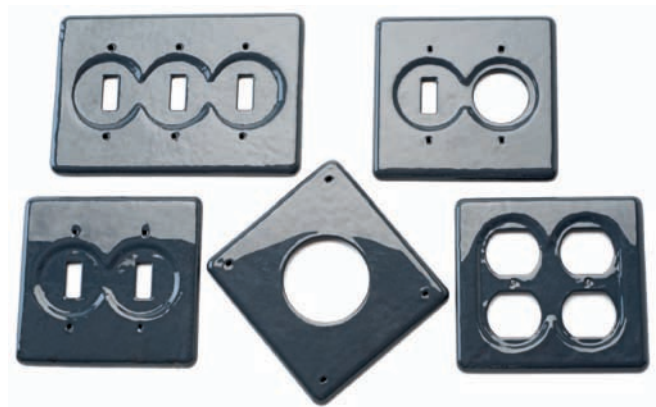

Cast Device Box Covers

FS/FD SINGLE GANG COVER CONFIGURATIONS

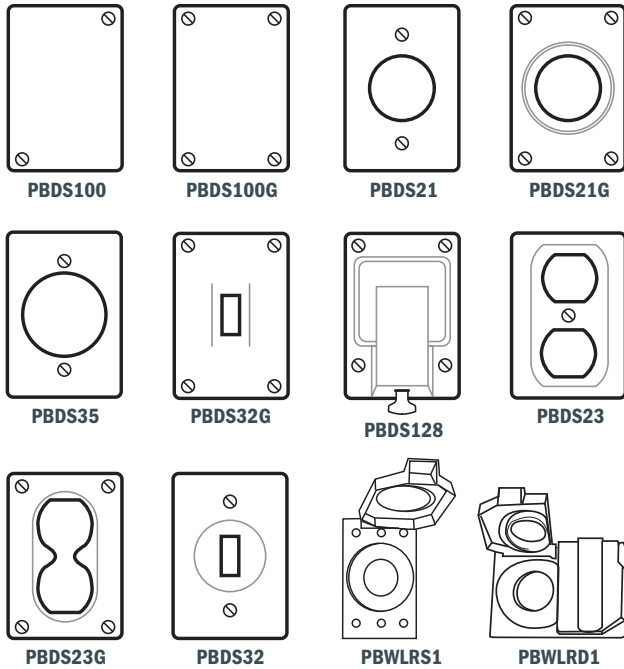

FS/FD 2 GANG COVER CONFIGURATIONS

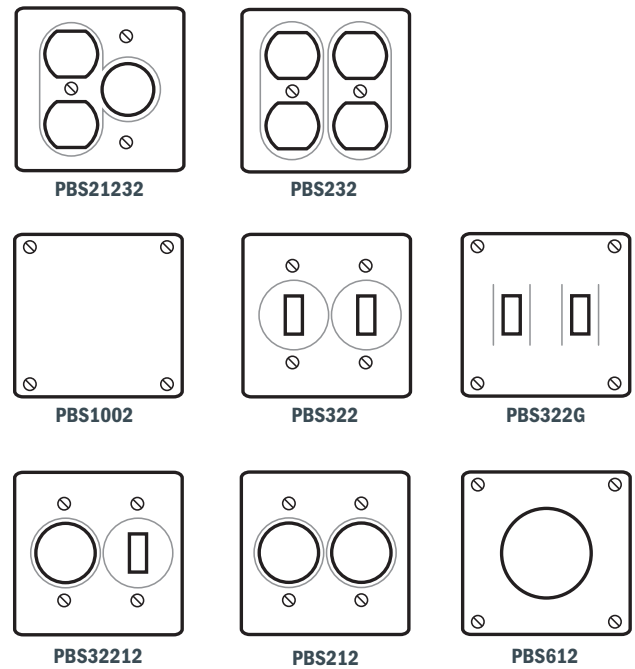

FERROUS COVERS - ONE GANG

| CATALOG # | DESCRIPTION | NOMINAL WEIGHT |
|-----------|---|----------------|
| PBDS32 | GENERAL USE SNAP ON OR TOGGLE (S) | 0.4 |
| PBDS23G | DUPLEX CONVENIENCE RECEPTACLE (S,F) | 0.4 |
| PBDS35 | PLUG RECEPTACLE 1 5/8" DIAMETER (S) | 0.4 |
| PBDS21 | 3P 2W GROUNDING ROUND FLUSH RECEPTACLES (S) | 0.3 |
| PBDS21G | 3P 2W GROUNDING ROUND FLUSH RECEPTACLES (S,F) | 0.3 |
| PBDS23 | DUPLEX CONVENIENCE RECEPTACLE (S) | 0.3 |
| PBDS32G | SQUARE HANDLE SNAP OR TOGGLE (S, F) | 0.4 |

FERROUS COVERS - TWO GANG

| CATALOG # | DESCRIPTION | NOMINAL WEIGHT |
|-----------|---------------------------------------|----------------|
| PBS1002 | BLANK COVER SHEET STEEL (S) | 1.0 |
| PBS1002G | BLANK COVER IRON ALLOY (S,F) | 1.0 |
| PBS21232 | ROUND RECEPTACLE + DUPLEX CONVENIENCE | 1.2 |
| PBS232 | DUPLEX CONVENIENCE (S) | 1.2 |
| PBS322 | SNAP SWITCH (S) | 1.0 |
| PBS32212 | ROUND RECEPTACLE + SNAP SWITCH (S) | 1.2 |
| PBS212 | TWO ROUND RECEPTACLES (S) | 2.0 |
| PBS612 | 20 AMP, 250 VOLT RECEPTACLE (S) | 1.2 |
| PBS322G | SNAP SWITCHES IRON ALLOY (S,F) | 1.2 |

ALUMINUM COVERS - ONE GANG

| CATALOG # | DESCRIPTION | NOMINAL WEIGHT |
|-----------|---|----------------|
| PBDS23SA | DUPLEX CONVENIENCE RECEPTACLE (S) | 0.1 |
| PBDS100 | BLANK COVER (S) | 0.1 |
| PBDS128 | SNAP SWITCH | 0.5 |
| PBDS100G | BLANK COVER CAST (S,F) | 0.3 |
| PBWLRD1 | SPRING DOOR DUPLEX COVER 1 3/8" (F) | 0.4 |
| PBWLR1 | SPRING DOOR SINGLE COVER 1 3/8" (F) | 0.3 |
| PBWLR2 | SPRING DOOR SINGLE COVER 1 1/2" (F) | 0.3 |
| PRWLG-FS | SPRING DOOR COVER FOR GFCI (S) - HORIZONTAL | 0.5 |
| PRWLG-FSV | SPRING DOOR COVER FOR GFCI (S) - VERTICAL | 0.5 |
| PRWLG-F | SPRING DOOR COVER FOR GFCI (F) - HORIZONTAL | 0.5 |

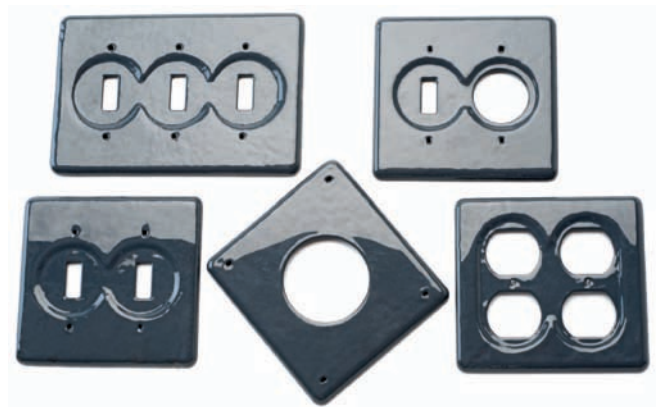

Contact us:
customerservice@plastibond.com

Visit www.plastibond.com
For more information