

CONNECTORS

Compression Connectors

Long Barrel, Copper Lugs Two Hole LN Series Cont'd



FEATURES

- Produced from high conductivity copper tubing.
- Allows easy inspection of the termination to assure complete cable insertion.
- Tin-plated to provide corrosion and low contact resistance.
- Marked with die index and color coded.
- Listed for 35KV maximum when properly installed.
- For applications greater than 2000V, install to cable Manufacturer voltage stress relief instructions.
- **Part Numbers ending in "P" have a "peep" or sight inspection hole.**

SPECIFICATIONS

- UL486A Listed Wire Connector.
- UL467 Grounding & Bonding (Sizes 8 AWG - 3/0 AWG).
- Max ampacity is based on NEC 310.15, insulation type, and conductor material. Please consult your current NEC manual.
- * CLASS B OR C BUILDING WIRE CU CABLE ONLY.
- **Temperature Rating:** 90 °C.
- **Voltage:** 600V.
- 9CU.

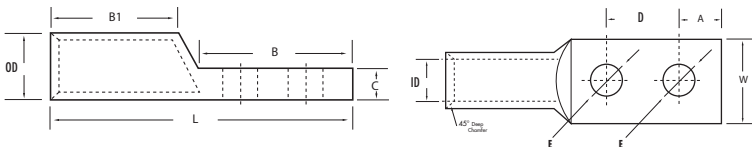

***EXPANDED WIRE RANGE** when installed with NSI N12ID dieless compression tool.
UL Listed with other tools:
FOR TOOL/DIE CRIMPING INFORMATION, PLEASE SEE TABLE ON PAGE 87

CAT. NO.	WIRE RANGE	EXPANDED WIRE RANGE*	COLOR	BOLT SIZE (IN.)	MTG. HOLE SPACING (D) (IN.)	BARREL I.D.	BARREL O.D.	LENGTH (L) (IN.)	WIDTH (W)	END OF CONN TO CTR. (A) (IN.)	TANG LENGTH (B) (IN.)	BARREL LENGTH (B1) (IN.)	TANG THICKNESS (C) (IN.)	MTG. HOLE DIA. (E) (IN.)	STD. CTN. QTY.
L30N-38	3/0 AWG	3/0 - 2 AWG	Orange	3/8"	1.000	0.490	0.620	3.500	0.900	0.380	1.810	1.380	0.130	0.410	25
L30N-38P	3/0 AWG	3/0 - 2 AWG	Orange	3/8"	1.000	0.490	0.620	3.500	0.900	0.380	1.810	1.380	0.130	0.410	25
L30N-56	3/0 AWG	3/0 - 2 AWG	Orange	5/16"	1.000	0.490	0.620	4.650	0.900	0.620	2.990	1.380	0.130	0.312	25
L30N-56P	3/0 AWG	3/0 - 2 AWG	Orange	5/16"	1.000	0.490	0.620	4.650	0.900	0.620	2.990	1.380	0.130	0.312	25
L30N	3/0 AWG	3/0 - 2 AWG	Orange	1/2"	1.750	0.490	0.620	4.650	0.900	0.620	2.990	1.380	0.130	0.510	25
L30NP	3/0 AWG	3/0 - 2 AWG	Orange	1/2"	1.750	0.490	0.620	4.650	0.900	0.620	2.990	1.380	0.130	0.510	25
L40N-141	4/0 AWG	4/0 - 1 AWG	Purple	1/4"	0.625	0.550	0.690	2.991	1.002	0.287	1.253	1.378	0.140	0.252	25
L40N-141P	4/0 AWG	4/0 - 1 AWG	Purple	1/4"	0.625	0.550	0.690	2.991	1.002	0.287	1.253	1.378	0.140	0.252	25
L40N-142	4/0 AWG	4/0 - 1 AWG	Purple	1/4"	0.750	0.550	0.690	3.109	0.994	0.287	1.408	1.365	0.140	0.252	25
L40N-142P	4/0 AWG	4/0 - 1 AWG	Purple	1/4"	0.750	0.550	0.690	3.109	0.994	0.287	1.408	1.365	0.140	0.252	25
L40N-38	4/0 AWG	4/0 - 1 AWG	Purple	3/8"	1.000	0.550	0.690	3.540	2.002	0.370	1.820	1.407	0.135	0.410	25
L40N-38P	4/0 AWG	4/0 - 1 AWG	Purple	3/8"	1.000	0.550	0.690	3.540	1.002	0.370	1.820	1.407	0.135	0.410	25
L40N-383	4/0 AWG	4/0 - 1 AWG	Purple	3/8"	1.750	0.550	0.690	4.732	1.005	0.590	2.952	1.375	0.142	0.410	25
L40N-383P	4/0 AWG	4/0 - 1 AWG	Purple	3/8"	1.750	0.550	0.690	4.732	1.005	0.590	2.952	1.375	0.142	0.410	25
L40N	4/0 AWG	4/0 - 1 AWG	Purple	1/2"	1.750	0.550	0.690	4.720	1.000	0.620	2.990	1.420	0.130	0.510	25
L40NP	4/0 AWG	4/0 - 1 AWG	Purple	1/2"	1.750	0.550	0.690	4.720	1.000	0.620	2.990	1.420	0.130	0.510	25
L250N	250 MCM	250 MCM - 1/0 AWG	Yellow	1/2"	1.750	0.590	0.750	4.960	1.090	0.620	2.990	1.610	0.150	0.510	25
L250N-38	250 MCM	250 MCM - 1/0 AWG	Yellow	3/8"	1.000	0.590	0.750	3.780	1.090	0.380	1.810	1.610	0.150	0.410	25
L300N	300 MCM	300 MCM - 2/0 AWG	White	1/2"	1.750	0.660	0.810	5.310	1.190	0.620	2.990	1.970	0.150	0.510	12
L350N	350 MCM	350 MCM - 3/0 AWG	Red	1/2"	1.750	0.700	0.870	5.390	1.280	0.620	2.990	1.970	0.170	0.510	12
L350N-38	350 MCM	350 MCM - 3/0 AWG	Red	3/8"	1.000	0.700	0.870	4.210	1.280	0.380	1.810	1.970	0.170	0.410	12
L400N	400 MCM	400 MCM - 4/0 AWG	Blue	1/2"	1.750	0.760	0.950	5.470	1.390	0.620	2.990	1.970	0.180	0.510	6
L500N	500 MCM	500 - 250 MCM	Brown	1/2"	1.750	0.840	1.060	5.750	1.540	0.620	2.990	2.240	0.220	0.510	6
L500N-38	500 MCM	500 - 250 MCM	Brown	3/8"	1.000	0.840	1.060	4.570	1.540	0.380	1.810	2.240	0.220	0.410	6
L600N	600 MCM	600 - 250 MCM	Green	1/2"	1.750	0.930	1.190	5.790	1.720	0.620	2.990	2.240	0.250	0.510	6
L600N-38	600 MCM	600 - 250 MCM	Green	3/8"	1.000	0.930	1.190	4.610	1.720	0.380	1.810	2.240	0.250	0.410	6
L750N	750 MCM	750 - 500 MCM	Black	1/2"	1.750	1.040	1.310	6.300	1.900	0.620	2.990	2.640	0.270	0.510	3
L750N-38	750 MCM	750 - 500 MCM	Black	3/8"	1.000	1.040	1.310	5.120	1.900	0.380	1.810	2.640	0.270	0.410	3
L1000N	1000 MCM	1000 - 750 MCM	White	1/2"	1.750	1.150	1.500	7.125	2.160	0.630	3.060	3.160	0.340	0.510	3

CONNECTORS

Compression Connectors

Long Barrel, Copper Lugs Two Hole LN Series Cont'd



FEATURES

- Produced from high conductivity copper tubing.
- Allows easy inspection of the termination to assure complete cable insertion.
- Tin-plated to provide corrosion and low contact resistance.
- Marked with die index and color coded.
- Listed for 35KV maximum when properly installed.
- For applications greater than 2000V, install to cable Manufacturer voltage stress relief instructions.
- **Part Numbers ending in "P" have a "peep" or sight inspection hole.**

SPECIFICATIONS

- UL486A Listed Wire Connector.
- UL467 Grounding & Bonding (Sizes 8 AWG - 3/0 AWG).
- Max ampacity is based on NEC 310.15, insulation type, and conductor material. Please consult your current NEC manual.
- * CLASS B OR C BUILDING WIRE CU CABLE ONLY.
- **Temperature Rating:** 90 °C.
- **Voltage:** 600V.
- 9CU.

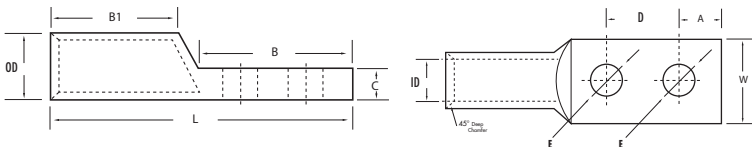

***EXPANDED WIRE RANGE** when installed with NSI N12ID dieless compression tool.
UL Listed with other tools:
FOR TOOL/DIE CRIMPING INFORMATION, PLEASE SEE TABLE ON PAGE 87

CAT. NO.	WIRE RANGE	EXPANDED WIRE RANGE*	COLOR	BOLT SIZE (IN.)	MTG. HOLE SPACING (D) (IN.)	BARREL I.D.	BARREL O.D.	LENGTH (L) (IN.)	WIDTH (W)	END OF CONN TO CTR. (A) (IN.)	TANG LENGTH (B) (IN.)	BARREL LENGTH (B1) (IN.)	TANG THICKNESS (C) (IN.)	MTG. HOLE DIA. (E) (IN.)	STD. CTN. QTY.
L30N-38	3/0 AWG	3/0 - 2 AWG	Orange	3/8"	1.000	0.490	0.620	3.500	0.900	0.380	1.810	1.380	0.130	0.410	25
L30N-38P	3/0 AWG	3/0 - 2 AWG	Orange	3/8"	1.000	0.490	0.620	3.500	0.900	0.380	1.810	1.380	0.130	0.410	25
L30N-56	3/0 AWG	3/0 - 2 AWG	Orange	5/16"	1.000	0.490	0.620	4.650	0.900	0.620	2.990	1.380	0.130	0.312	25
L30N-56P	3/0 AWG	3/0 - 2 AWG	Orange	5/16"	1.000	0.490	0.620	4.650	0.900	0.620	2.990	1.380	0.130	0.312	25
L30N	3/0 AWG	3/0 - 2 AWG	Orange	1/2"	1.750	0.490	0.620	4.650	0.900	0.620	2.990	1.380	0.130	0.510	25
L30NP	3/0 AWG	3/0 - 2 AWG	Orange	1/2"	1.750	0.490	0.620	4.650	0.900	0.620	2.990	1.380	0.130	0.510	25
L40N-141	4/0 AWG	4/0 - 1 AWG	Purple	1/4"	0.625	0.550	0.690	2.991	1.002	0.287	1.253	1.378	0.140	0.252	25
L40N-141P	4/0 AWG	4/0 - 1 AWG	Purple	1/4"	0.625	0.550	0.690	2.991	1.002	0.287	1.253	1.378	0.140	0.252	25
L40N-142	4/0 AWG	4/0 - 1 AWG	Purple	1/4"	0.750	0.550	0.690	3.109	0.994	0.287	1.408	1.365	0.140	0.252	25
L40N-142P	4/0 AWG	4/0 - 1 AWG	Purple	1/4"	0.750	0.550	0.690	3.109	0.994	0.287	1.408	1.365	0.140	0.252	25
L40N-38	4/0 AWG	4/0 - 1 AWG	Purple	3/8"	1.000	0.550	0.690	3.540	2.002	0.370	1.820	1.407	0.135	0.410	25
L40N-38P	4/0 AWG	4/0 - 1 AWG	Purple	3/8"	1.000	0.550	0.690	3.540	1.002	0.370	1.820	1.407	0.135	0.410	25
L40N-383	4/0 AWG	4/0 - 1 AWG	Purple	3/8"	1.750	0.550	0.690	4.732	1.005	0.590	2.952	1.375	0.142	0.410	25
L40N-383P	4/0 AWG	4/0 - 1 AWG	Purple	3/8"	1.750	0.550	0.690	4.732	1.005	0.590	2.952	1.375	0.142	0.410	25
L40N	4/0 AWG	4/0 - 1 AWG	Purple	1/2"	1.750	0.550	0.690	4.720	1.000	0.620	2.990	1.420	0.130	0.510	25
L40NP	4/0 AWG	4/0 - 1 AWG	Purple	1/2"	1.750	0.550	0.690	4.720	1.000	0.620	2.990	1.420	0.130	0.510	25
L250N	250 MCM	250 MCM - 1/0 AWG	Yellow	1/2"	1.750	0.590	0.750	4.960	1.090	0.620	2.990	1.610	0.150	0.510	25
L250N-38	250 MCM	250 MCM - 1/0 AWG	Yellow	3/8"	1.000	0.590	0.750	3.780	1.090	0.380	1.810	1.610	0.150	0.410	25
L300N	300 MCM	300 MCM - 2/0 AWG	White	1/2"	1.750	0.660	0.810	5.310	1.190	0.620	2.990	1.970	0.150	0.510	12
L350N	350 MCM	350 MCM - 3/0 AWG	Red	1/2"	1.750	0.700	0.870	5.390	1.280	0.620	2.990	1.970	0.170	0.510	12
L350N-38	350 MCM	350 MCM - 3/0 AWG	Red	3/8"	1.000	0.700	0.870	4.210	1.280	0.380	1.810	1.970	0.170	0.410	12
L400N	400 MCM	400 MCM - 4/0 AWG	Blue	1/2"	1.750	0.760	0.950	5.470	1.390	0.620	2.990	1.970	0.180	0.510	6
L500N	500 MCM	500 - 250 MCM	Brown	1/2"	1.750	0.840	1.060	5.750	1.540	0.620	2.990	2.240	0.220	0.510	6
L500N-38	500 MCM	500 - 250 MCM	Brown	3/8"	1.000	0.840	1.060	4.570	1.540	0.380	1.810	2.240	0.220	0.410	6
L600N	600 MCM	600 - 250 MCM	Green	1/2"	1.750	0.930	1.190	5.790	1.720	0.620	2.990	2.240	0.250	0.510	6
L600N-38	600 MCM	600 - 250 MCM	Green	3/8"	1.000	0.930	1.190	4.610	1.720	0.380	1.810	2.240	0.250	0.410	6
L750N	750 MCM	750 - 500 MCM	Black	1/2"	1.750	1.040	1.310	6.300	1.900	0.620	2.990	2.640	0.270	0.510	3
L750N-38	750 MCM	750 - 500 MCM	Black	3/8"	1.000	1.040	1.310	5.120	1.900	0.380	1.810	2.640	0.270	0.410	3
L1000N	1000 MCM	1000 - 750 MCM	White	1/2"	1.750	1.150	1.500	7.125	2.160	0.630	3.060	3.160	0.340	0.510	3