

# CONNECTORS

## Compression Connectors

### Long Barrel One Hole Copper Lugs L Series



#### FEATURES

- Produced from high conductivity copper tubing.
- Tin-plated to provide corrosion low contact resistance.
- Marked with die index and color coded.
- Listed for 35KV max when properly installed and to cable manufacturer instructions.
- For applications greater than 2000V, consult the cable Manufacturer voltage stress relief instructions.
- **Part Numbers ending in "P" have a "peep" or sight inspection hole.**

#### SPECIFICATIONS

- UL486A Listed Wire Connector.
- UL467 Grounding & Bonding (Sizes 8 AWG - 3/0 AWG).
- Max ampacity is based on NEC 310.15, insulation type, and conductor material. Please consult your current NEC manual.
- \* CLASS B OR C BUILDING WIRE CU CABLE ONLY.
- Temperature Rating: 90 °C.
- Voltage: 600V

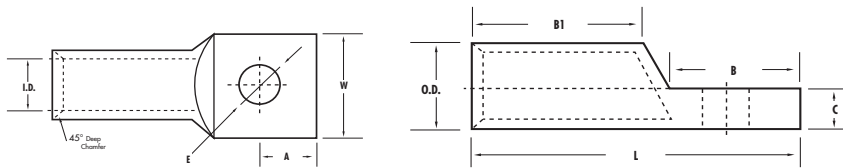

**\*EXPANDED WIRE RANGE** when installed with NSI N121D dieless compression tool.  
UL Listed with other tools:  
**FOR TOOL/DIE CRIMPING INFORMATION, PLEASE SEE TABLE ON PAGE 87**

CAT. NO.	WIRE RANGE	EXPANDED WIRE RANGE**	BOLT SIZE (IN.)	BARREL I.D.	BARREL O.D.	LENGTH (L) (IN.)	WIDTH (W) (IN.)	A (IN.)	B (IN.)	B1 (IN.)	C (IN.)	E (IN.)	COLOR	STD. CTN. QTY.
L810	8 AWG	8 - 10 AWG	#10	0.205	0.295	1.520	0.420	0.280	0.590	0.810	0.080	0.210	Red	100
L810P	8 AWG	8 - 10 AWG	#10	0.205	0.295	1.520	0.420	0.280	0.590	0.810	0.080	0.210	Red	100
L814	8 AWG	8 - 10 AWG	1/4"	0.205	0.295	1.520	0.420	0.280	0.590	0.810	0.080	0.252	Red	100
L814P	8 AWG	8 - 10 AWG	1/4"	0.205	0.295	1.520	0.420	0.280	0.590	0.810	0.080	0.252	Red	100
L838	8 AWG	8 - 10 AWG	3/8"	0.205	0.295	1.520	0.420	0.280	0.590	0.810	0.080	0.413	Red	100
L838P	8 AWG	8 - 10 AWG	3/8"	0.205	0.295	1.520	0.420	0.280	0.590	0.810	0.080	0.413	Red	100
L610	6 AWG	6 - 8 AWG	#10	0.205	0.295	1.770	0.420	0.300	0.640	0.980	0.083	0.210	Blue	100
L614	6 AWG	6 - 8 AWG	1/4"	0.205	0.295	1.772	0.421	0.295	0.669	0.984	0.083	0.252	Blue	100
L614P	6 AWG	6 - 8 AWG	1/4"	0.205	0.295	1.772	0.421	0.295	0.669	0.984	0.083	0.252	Blue	100
L638	6 AWG	6 - 8 AWG	3/8"	0.205	0.295	1.913	0.591	0.370	0.811	0.984	0.083	0.413	Blue	100
L638P	6 AWG	6 - 8 AWG	3/8"	0.205	0.295	1.913	0.591	0.370	0.811	0.984	0.083	0.413	Blue	100
L656	6 AWG	6 - 8 AWG	5/16"	0.205	0.295	1.910	0.590	0.370	0.810	0.980	0.083	0.330	Blue	100
L656P	6 AWG	6 - 8 AWG	5/16"	0.205	0.295	1.910	0.590	0.370	0.810	0.980	0.083	0.330	Blue	100
L410	4 AWG	4 - 6 AWG	#10	0.252	0.343	1.770	0.488	0.315	0.669	0.980	0.087	0.210	Gray	100
L414	4 AWG	4 - 6 AWG	1/4"	0.252	0.343	1.772	0.488	0.315	0.669	0.984	0.087	0.252	Gray	100
L414P	4 AWG	4 - 6 AWG	1/4"	0.252	0.343	1.772	0.488	0.315	0.669	0.984	0.087	0.252	Gray	100
L438	4 AWG	4 - 6 AWG	3/8"	0.252	0.343	1.913	0.591	0.370	0.811	0.984	0.087	0.413	Gray	100
L438P	4 AWG	4 - 6 AWG	3/8"	0.252	0.343	1.913	0.591	0.370	0.811	0.984	0.087	0.413	Gray	100
L456	4 AWG	4 - 6 AWG	5/16"	0.252	0.343	1.772	0.488	0.315	0.669	0.984	0.087	0.331	Gray	100
L456P	4 AWG	4 - 6 AWG	5/16"	0.252	0.343	1.772	0.488	0.315	0.669	0.984	0.087	0.331	Gray	100
L314	3 AWG	3 - 6 AWG	1/4"	0.270	0.377	2.344	0.531	0.323	0.828	1.169	0.097	0.277	White	100
L356	3 AWG	3 - 6 AWG	5/16"	0.270	0.377	2.157	0.538	0.346	0.767	1.120	0.091	0.336	White	50

# CONNECTORS

## Compression Connectors

### Long Barrel One Hole Copper Lugs L Series



#### FEATURES

- Produced from high conductivity copper tubing.
- Tin-plated to provide corrosion low contact resistance.
- Marked with die index and color coded.
- Listed for 35KV max when properly installed and to cable manufacturer instructions.
- For applications greater than 2000V, consult the cable Manufacturer voltage stress relief instructions.
- **Part Numbers ending in "P" have a "peep" or sight inspection hole.**

#### SPECIFICATIONS

- UL486A Listed Wire Connector.
- UL467 Grounding & Bonding (Sizes 8 AWG - 3/0 AWG).
- Max ampacity is based on NEC 310.15, insulation type, and conductor material. Please consult your current NEC manual.
- \* CLASS B OR C BUILDING WIRE CU CABLE ONLY.
- Temperature Rating: 90 °C.
- Voltage: 600V

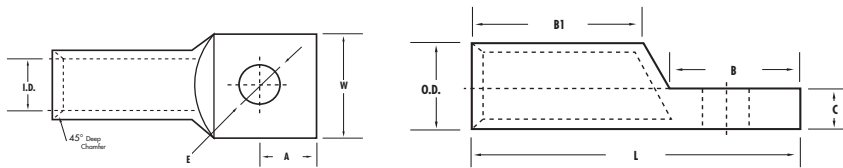

**\*EXPANDED WIRE RANGE** when installed with NSI N121D dieless compression tool.  
UL Listed with other tools:  
**FOR TOOL/DIE CRIMPING INFORMATION, PLEASE SEE TABLE ON PAGE 87**

CAT. NO.	WIRE RANGE	EXPANDED WIRE RANGE**	BOLT SIZE (IN.)	BARREL I.D.	BARREL O.D.	LENGTH (L) (IN.)	WIDTH (W) (IN.)	A (IN.)	B (IN.)	B1 (IN.)	C (IN.)	E (IN.)	COLOR	STD. CTN. QTY.
L810	8 AWG	8 - 10 AWG	#10	0.205	0.295	1.520	0.420	0.280	0.590	0.810	0.080	0.210	Red	100
L810P	8 AWG	8 - 10 AWG	#10	0.205	0.295	1.520	0.420	0.280	0.590	0.810	0.080	0.210	Red	100
L814	8 AWG	8 - 10 AWG	1/4"	0.205	0.295	1.520	0.420	0.280	0.590	0.810	0.080	0.252	Red	100
L814P	8 AWG	8 - 10 AWG	1/4"	0.205	0.295	1.520	0.420	0.280	0.590	0.810	0.080	0.252	Red	100
L838	8 AWG	8 - 10 AWG	3/8"	0.205	0.295	1.520	0.420	0.280	0.590	0.810	0.080	0.413	Red	100
L838P	8 AWG	8 - 10 AWG	3/8"	0.205	0.295	1.520	0.420	0.280	0.590	0.810	0.080	0.413	Red	100
L610	6 AWG	6 - 8 AWG	#10	0.205	0.295	1.770	0.420	0.300	0.640	0.980	0.083	0.210	Blue	100
L614	6 AWG	6 - 8 AWG	1/4"	0.205	0.295	1.772	0.421	0.295	0.669	0.984	0.083	0.252	Blue	100
L614P	6 AWG	6 - 8 AWG	1/4"	0.205	0.295	1.772	0.421	0.295	0.669	0.984	0.083	0.252	Blue	100
L638	6 AWG	6 - 8 AWG	3/8"	0.205	0.295	1.913	0.591	0.370	0.811	0.984	0.083	0.413	Blue	100
L638P	6 AWG	6 - 8 AWG	3/8"	0.205	0.295	1.913	0.591	0.370	0.811	0.984	0.083	0.413	Blue	100
L656	6 AWG	6 - 8 AWG	5/16"	0.205	0.295	1.910	0.590	0.370	0.810	0.980	0.083	0.330	Blue	100
L656P	6 AWG	6 - 8 AWG	5/16"	0.205	0.295	1.910	0.590	0.370	0.810	0.980	0.083	0.330	Blue	100
L410	4 AWG	4 - 6 AWG	#10	0.252	0.343	1.770	0.488	0.315	0.669	0.980	0.087	0.210	Gray	100
L414	4 AWG	4 - 6 AWG	1/4"	0.252	0.343	1.772	0.488	0.315	0.669	0.984	0.087	0.252	Gray	100
L414P	4 AWG	4 - 6 AWG	1/4"	0.252	0.343	1.772	0.488	0.315	0.669	0.984	0.087	0.252	Gray	100
L438	4 AWG	4 - 6 AWG	3/8"	0.252	0.343	1.913	0.591	0.370	0.811	0.984	0.087	0.413	Gray	100
L438P	4 AWG	4 - 6 AWG	3/8"	0.252	0.343	1.913	0.591	0.370	0.811	0.984	0.087	0.413	Gray	100
L456	4 AWG	4 - 6 AWG	5/16"	0.252	0.343	1.772	0.488	0.315	0.669	0.984	0.087	0.331	Gray	100
L456P	4 AWG	4 - 6 AWG	5/16"	0.252	0.343	1.772	0.488	0.315	0.669	0.984	0.087	0.331	Gray	100
L314	3 AWG	3 - 6 AWG	1/4"	0.270	0.377	2.344	0.531	0.323	0.828	1.169	0.097	0.277	White	100
L356	3 AWG	3 - 6 AWG	5/16"	0.270	0.377	2.157	0.538	0.346	0.767	1.120	0.091	0.336	White	50