

CONNECTORS

Compression Connectors

Long Barrel One Hole Copper Lugs

L Series Cont'd



FEATURES

- Produced from high conductivity copper tubing.
- Tin-plated to provide corrosion low contact resistance.
- Marked with die index and color coded.
- Listed for 35KV max when properly installed and to cable manufacturer instructions.
- For applications greater than 2000V, consult the cable Manufacturer for voltage stress relief instructions.
- **Part Numbers ending in "P" have a "peep" or sight inspection hole.**

SPECIFICATIONS

- UL486A Listed Wire Connector.
- UL467 Grounding & Bonding (Sizes 8 AWG - 3/0 AWG).
- Max ampacity is based on NEC 310.15, insulation type, and conductor material. Please consult your current NEC manual.
- * CLASS B OR C BUILDING WIRE CU CABLE ONLY.
- Temperature Rating: 90 °C.
- Voltage: 600V

CONNECTORS

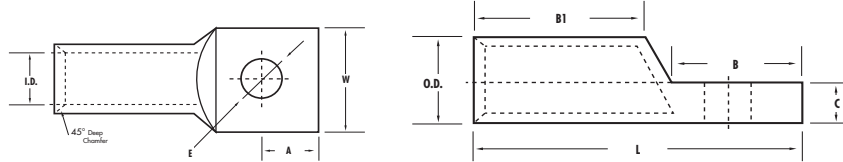

***EXPANDED WIRE RANGE** when installed with NSI N12ID dieless compression tool.
UL Listed with other tools:
FOR TOOL/DIE CRIMPING INFORMATION, PLEASE SEE TABLE ON PAGE 87

| CAT. NO. | WIRE RANGE | EXPANDED WIRE RANGE** | BOLT SIZE (IN.) | BARREL I.D. | BARREL O.D. | LENGTH (L) (IN.) | WIDTH (W) (IN.) | A (IN.) | B (IN.) | B1 (IN.) | C (IN.) | E (IN.) | COLOR | STD. CTN. QTY. |
|----------|------------|-----------------------|-----------------|-------------|-------------|------------------|-----------------|---------|---------|----------|---------|---------|-------|----------------|
| L356 | 3 AWG | 3 - 6 AWG | 5/16" | 0.270 | 0.377 | 2.157 | 0.538 | 0.346 | 0.767 | 1.120 | 0.091 | 0.336 | White | 50 |
| L338 | 3 AWG | 3 - 6 AWG | 3/8" | 0.270 | 0.377 | 2.351 | 0.550 | 0.418 | 0.823 | 1.188 | 0.083 | 0.397 | White | 50 |
| L214 | 2 AWG | 2 - 6 AWG | 1/4" | 0.315 | 0.421 | 2.071 | 0.602 | 0.206 | 0.811 | 1.102 | 0.102 | 0.252 | Brown | 50 |
| L214P | 2 AWG | 2 - 6 AWG | 1/4" | 0.315 | 0.421 | 2.071 | 0.602 | 0.206 | 0.811 | 1.102 | 0.102 | 0.252 | Brown | 50 |
| L256 | 2 AWG | 2 - 6 AWG | 5/16" | 0.315 | 0.421 | 2.071 | 0.602 | 0.370 | 0.811 | 1.102 | 0.102 | 0.331 | Brown | 50 |
| L256P | 2 AWG | 2 - 6 AWG | 5/16" | 0.315 | 0.421 | 2.071 | 0.602 | 0.370 | 0.811 | 1.102 | 0.102 | 0.331 | Brown | 50 |
| L238 | 2 AWG | 2 - 6 AWG | 3/8" | 0.315 | 0.421 | 2.071 | 0.602 | 0.370 | 0.811 | 1.102 | 0.102 | 0.413 | Brown | 50 |
| L238P | 2 AWG | 2 - 6 AWG | 3/8" | 0.315 | 0.421 | 2.071 | 0.602 | 0.370 | 0.811 | 1.102 | 0.102 | 0.413 | Brown | 50 |
| L156 | 1 AWG | 1 - 6 AWG | 5/16" | 0.358 | 0.469 | 2.110 | 0.673 | 0.370 | 0.811 | 1.102 | 0.106 | 0.331 | Green | 50 |
| L138 | 1 AWG | 1 - 6 AWG | 3/8" | 0.358 | 0.469 | 2.209 | 0.673 | 0.370 | 0.811 | 1.102 | 0.106 | 0.413 | Green | 50 |
| L1014 | 1/0 AWG | 1/0 - 6 AWG | 1/4" | 0.390 | 0.520 | 2.210 | 0.744 | 0.370 | 0.811 | 1.201 | 0.126 | 0.210 | Pink | 50 |
| L1014P | 1/0 AWG | 1/0 - 6 AWG | 1/4" | 0.390 | 0.520 | 2.210 | 0.744 | 0.370 | 0.811 | 1.201 | 0.126 | 0.210 | Pink | 50 |
| L1038 | 1/0 AWG | 1/0 - 6 AWG | 3/8" | 0.390 | 0.520 | 2.209 | 0.744 | 0.370 | 0.811 | 1.201 | 0.126 | 0.413 | Pink | 50 |
| L1038P | 1/0 AWG | 1/0 - 6 AWG | 3/8" | 0.390 | 0.520 | 2.209 | 0.744 | 0.370 | 0.811 | 1.201 | 0.126 | 0.413 | Pink | 50 |
| L1056 | 1/0 AWG | 1/0 - 6 AWG | 5/16" | 0.390 | 0.520 | 2.210 | 0.744 | 0.370 | 0.811 | 1.201 | 0.126 | 0.330 | Pink | 50 |
| L1056P | 1/0 AWG | 1/0 - 6 AWG | 5/16" | 0.390 | 0.520 | 2.210 | 0.744 | 0.370 | 0.811 | 1.201 | 0.126 | 0.330 | Pink | 50 |
| L1048 | 1/0 AWG | 1/0 - 6 AWG | 1/2" | 0.390 | 0.520 | 2.500 | 0.744 | 0.472 | 1.063 | 1.201 | 0.126 | 0.512 | Pink | 50 |
| L2014 | 2/0 AWG | 2/0 - 4 AWG | 1/4" | 0.441 | 0.563 | 2.677 | 0.815 | 0.472 | 1.063 | 1.378 | 0.118 | 0.252 | Black | 25 |
| L2014P | 2/0 AWG | 2/0 - 4 AWG | 1/4" | 0.441 | 0.563 | 2.677 | 0.815 | 0.472 | 1.063 | 1.378 | 0.118 | 0.252 | Black | 25 |
| L2038 | 2/0 AWG | 2/0 - 4 AWG | 3/8" | 0.441 | 0.563 | 2.677 | 0.815 | 0.472 | 1.063 | 1.378 | 0.118 | 0.413 | Black | 25 |
| L2038P | 2/0 AWG | 2/0 - 4 AWG | 3/8" | 0.441 | 0.563 | 2.677 | 0.815 | 0.472 | 1.063 | 1.378 | 0.118 | 0.413 | Black | 25 |
| L2048 | 2/0 AWG | 2/0 - 4 AWG | 1/2" | 0.441 | 0.563 | 2.677 | 0.815 | 0.472 | 1.063 | 1.378 | 0.118 | 0.512 | Black | 25 |

CONNECTORS

Compression Connectors

Long Barrel One Hole Copper Lugs

L Series Cont'd



FEATURES

- Produced from high conductivity copper tubing.
- Tin-plated to provide corrosion low contact resistance.
- Marked with die index and color coded.
- Listed for 35KV max when properly installed and to cable manufacturer instructions.
- For applications greater than 2000V, consult the cable Manufacturer for voltage stress relief instructions.
- **Part Numbers ending in "P" have a "peep" or sight inspection hole.**

SPECIFICATIONS

- UL486A Listed Wire Connector.
- UL467 Grounding & Bonding (Sizes 8 AWG - 3/0 AWG).
- Max ampacity is based on NEC 310.15, insulation type, and conductor material. Please consult your current NEC manual.
- * CLASS B OR C BUILDING WIRE CU CABLE ONLY.
- Temperature Rating: 90 °C.
- Voltage: 600V

CONNECTORS

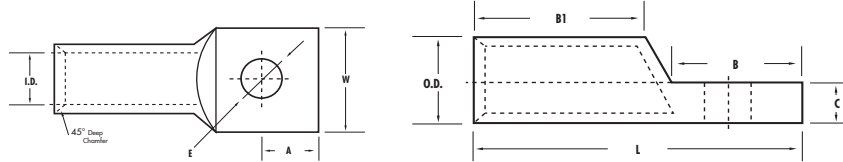

***EXPANDED WIRE RANGE** when installed with NSI N12ID dieless compression tool.
 UL Listed with other tools:
FOR TOOL/DIE CRIMPING INFORMATION, PLEASE SEE TABLE ON PAGE 87

| CAT. NO. | WIRE RANGE | EXPANDED WIRE RANGE** | BOLT SIZE (IN.) | BARREL I.D. | BARREL O.D. | LENGTH (L) (IN.) | WIDTH (W) (IN.) | A (IN.) | B (IN.) | B1 (IN.) | C (IN.) | E (IN.) | COLOR | STD. CTN. QTY. |
|----------|------------|-----------------------|-----------------|-------------|-------------|------------------|-----------------|---------|---------|----------|---------|---------|-------|----------------|
| L356 | 3 AWG | 3 - 6 AWG | 5/16" | 0.270 | 0.377 | 2.157 | 0.538 | 0.346 | 0.767 | 1.120 | 0.091 | 0.336 | White | 50 |
| L338 | 3 AWG | 3 - 6 AWG | 3/8" | 0.270 | 0.377 | 2.351 | 0.550 | 0.418 | 0.823 | 1.188 | 0.083 | 0.397 | White | 50 |
| L214 | 2 AWG | 2 - 6 AWG | 1/4" | 0.315 | 0.421 | 2.071 | 0.602 | 0.206 | 0.811 | 1.102 | 0.102 | 0.252 | Brown | 50 |
| L214P | 2 AWG | 2 - 6 AWG | 1/4" | 0.315 | 0.421 | 2.071 | 0.602 | 0.206 | 0.811 | 1.102 | 0.102 | 0.252 | Brown | 50 |
| L256 | 2 AWG | 2 - 6 AWG | 5/16" | 0.315 | 0.421 | 2.071 | 0.602 | 0.370 | 0.811 | 1.102 | 0.102 | 0.331 | Brown | 50 |
| L256P | 2 AWG | 2 - 6 AWG | 5/16" | 0.315 | 0.421 | 2.071 | 0.602 | 0.370 | 0.811 | 1.102 | 0.102 | 0.331 | Brown | 50 |
| L238 | 2 AWG | 2 - 6 AWG | 3/8" | 0.315 | 0.421 | 2.071 | 0.602 | 0.370 | 0.811 | 1.102 | 0.102 | 0.413 | Brown | 50 |
| L238P | 2 AWG | 2 - 6 AWG | 3/8" | 0.315 | 0.421 | 2.071 | 0.602 | 0.370 | 0.811 | 1.102 | 0.102 | 0.413 | Brown | 50 |
| L156 | 1 AWG | 1 - 6 AWG | 5/16" | 0.358 | 0.469 | 2.110 | 0.673 | 0.370 | 0.811 | 1.102 | 0.106 | 0.331 | Green | 50 |
| L138 | 1 AWG | 1 - 6 AWG | 3/8" | 0.358 | 0.469 | 2.209 | 0.673 | 0.370 | 0.811 | 1.102 | 0.106 | 0.413 | Green | 50 |
| L1014 | 1/0 AWG | 1/0 - 6 AWG | 1/4" | 0.390 | 0.520 | 2.210 | 0.744 | 0.370 | 0.811 | 1.201 | 0.126 | 0.210 | Pink | 50 |
| L1014P | 1/0 AWG | 1/0 - 6 AWG | 1/4" | 0.390 | 0.520 | 2.210 | 0.744 | 0.370 | 0.811 | 1.201 | 0.126 | 0.210 | Pink | 50 |
| L1038 | 1/0 AWG | 1/0 - 6 AWG | 3/8" | 0.390 | 0.520 | 2.209 | 0.744 | 0.370 | 0.811 | 1.201 | 0.126 | 0.413 | Pink | 50 |
| L1038P | 1/0 AWG | 1/0 - 6 AWG | 3/8" | 0.390 | 0.520 | 2.209 | 0.744 | 0.370 | 0.811 | 1.201 | 0.126 | 0.413 | Pink | 50 |
| L1056 | 1/0 AWG | 1/0 - 6 AWG | 5/16" | 0.390 | 0.520 | 2.210 | 0.744 | 0.370 | 0.811 | 1.201 | 0.126 | 0.330 | Pink | 50 |
| L1056P | 1/0 AWG | 1/0 - 6 AWG | 5/16" | 0.390 | 0.520 | 2.210 | 0.744 | 0.370 | 0.811 | 1.201 | 0.126 | 0.330 | Pink | 50 |
| L1048 | 1/0 AWG | 1/0 - 6 AWG | 1/2" | 0.390 | 0.520 | 2.500 | 0.744 | 0.472 | 1.063 | 1.201 | 0.126 | 0.512 | Pink | 50 |
| L2014 | 2/0 AWG | 2/0 - 4 AWG | 1/4" | 0.441 | 0.563 | 2.677 | 0.815 | 0.472 | 1.063 | 1.378 | 0.118 | 0.252 | Black | 25 |
| L2014P | 2/0 AWG | 2/0 - 4 AWG | 1/4" | 0.441 | 0.563 | 2.677 | 0.815 | 0.472 | 1.063 | 1.378 | 0.118 | 0.252 | Black | 25 |
| L2038 | 2/0 AWG | 2/0 - 4 AWG | 3/8" | 0.441 | 0.563 | 2.677 | 0.815 | 0.472 | 1.063 | 1.378 | 0.118 | 0.413 | Black | 25 |
| L2038P | 2/0 AWG | 2/0 - 4 AWG | 3/8" | 0.441 | 0.563 | 2.677 | 0.815 | 0.472 | 1.063 | 1.378 | 0.118 | 0.413 | Black | 25 |
| L2048 | 2/0 AWG | 2/0 - 4 AWG | 1/2" | 0.441 | 0.563 | 2.677 | 0.815 | 0.472 | 1.063 | 1.378 | 0.118 | 0.512 | Black | 25 |