

Watertight Hubs

Aluminum Die Cast, Insulated and Gasketed

Suitable for use in Class I, Division 2

Applications

- Used to connect rigid metal conduit or IMC to a threadless opening in an enclosure.
- May be used in wet or dry locations, indoors or outdoors.

Features

- Rugged metallic construction ensures mechanical protection.
- Insulated throat, rated up to 302 °F/150 °C, prevents wire abrasion.
- Integral O-ring provides watertight seal.
- Grounding version provides positive ground for external conductor.
- Unique profile permits easy wrenching.
- Smooth, accurately tapped threads facilitate installation.
- Watertight and corrosion resistant.
- NEMA Types 2, 3, 3R, 4, 4X, 5, 12, 13

Material/Finish

- Bodies and nuts: aluminum die cast
- O-ring: BUNA-N
- Insulator: polypropylene
- Ground screw: stainless steel

Certifications and Compliances

- UL Standard: 514B
- UL Listed: E14814
- CSA Standard: C22.2 No. 18.3
- CSA Certified: 065178
- NEMA: FB-1

Options

- PVC coating available on select hubs. Add suffix **-PVC** to catalog number.



HUB



HUBG

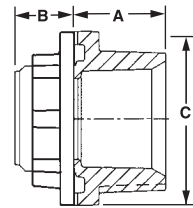

HUB Series

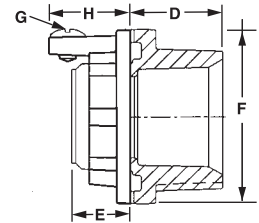

HUBG Series

COMMERCIAL PRODUCTS: RIGID AND IMC FITTINGS

Hub Spacing

| Knockout Hole Size (in./mm.) | Trade Size (Inches) | Trade Size Dimensions in Inches | | | | | |
|------------------------------|---------------------|---------------------------------|------------------|------------------|------------------|------------------|------------------|
| | | 1/2" | 3/4" | 1" | 1-1/4" | 1-1/2" | 2" |
| 0.88/22.2 | 1/2 | 1.56/39.6 | | | | | |
| 1.13/3.2 | 3/4 | 1.69/42.9 | 1.81/45.9 | | | | |
| 1.38/9.5 | 1 | 1.84/46.7 | 1.99/50.5 | 2.13/54.1 | | | |
| 1.75/19.1 | 1-1/4 | 2.03/51.6 | 2.16/54.9 | 2.31/58.7 | 2.50/63.5 | | |
| 2.00/50.8 | 1-1/2 | 2.22/56.4 | 2.34/59.4 | 2.50/63.5 | 2.69/68.3 | 2.88/73.2 | |
| 2.50/63.5 | 2 | 2.47/62.7 | 2.59/65.8 | 2.75/69.9 | 2.94/74.7 | 3.13/79.5 | 3.38/85.9 |

Dimensions in **bold** are for centers of conduits of same size, all other dimensions are for centers of conduits of a different size.

Watertight Hubs

Aluminum Die Cast, Insulated and Gasketed

Suitable for use in Class I, Division 2

Aluminum Die Cast Hubs — Insulated

| Catalog Number | Trade Size (Inches) | Dimensions in Inches/Millimeters | | Dimensions in Inches/Millimeters | | |
|----------------|---------------------|----------------------------------|-----------------------------|----------------------------------|-----------|------------|
| | | Hole Diameter Min. — Max. | Panel Thickness Min. — Max. | A | B | C |
| HUB-50A † | 1/2 | 0.86 — 0.91/ 21.8 — 23.1 | 0.03 — 0.25/ 0.8 — 6.4 | .83/21.08 | .57/14.49 | 1.44/36.58 |
| HUB-75A † | 3/4 | 1.08 — 1.14/ 27.4 — 28.9 | 0.03 — 0.25/ 0.8 — 6.4 | .90/22.86 | .59/14.99 | 1.67/42.42 |
| HUB-100A † | 1 | 1.33 — 1.41/ 33.8 — 35.8 | 0.03 — 0.25/ 0.8 — 6.4 | 1.06/26.92 | .67/17.02 | 1.99/50.55 |
| HUB-125A † | 1-1/4 | 1.67 — 1.77/ 42.4 — 44.9 | 0.03 — 0.25/ 0.8 — 6.4 | 1.02/25.91 | .69/17.53 | 2.36/59.94 |
| HUB-150A † | 1-1/2 | 1.92 — 2.02/ 48.8 — 51.3 | 0.06 — 0.25/ 1.5 — 6.4 | 1.02/25.91 | .69/17.53 | 2.74/69.60 |
| HUB-200A † | 2 | 2.36 — 2.50/ 59.9 — 63.5 | 0.06 — 0.25/ 1.5 — 6.4 | 1.08/27.43 | .66/16.76 | 3.23/82.04 |

Grounding Style Hubs — Insulated

| Catalog Number | Trade Size (Inches) | Dimensions in Inches/Millimeters | | Dimensions in Inches/Millimeters | | | | |
|----------------|---------------------|----------------------------------|-----------------------------|----------------------------------|-----------|------------|--------------|-----------|
| | | Hole Diameter Min. — Max. | Panel Thickness Min. — Max. | D | E | F | G | H |
| HUBG-50A | 1/2 | 0.86 — 0.91/ 21.8 — 23.1 | 0.03 — 0.25/ 0.8 — 6.4 | .83/21.08 | .57/14.48 | 1.44/36.58 | 10-32x0.3 | .59/14.99 |
| HUBG-75A | 3/4 | 1.08 — 1.14/ 27.4 — 28.9 | 0.03 — 0.25/ 0.8 — 6.4 | .90/22.86 | .59/14.99 | 1.67/42.42 | 10-32x0.3 | .59/14.99 |
| HUBG-100A | 1 | 1.33 — 1.41/ 33.8 — 35.8 | 0.03 — 0.25/ 0.8 — 6.4 | 1.06/26.92 | .67/17.02 | 1.99/50.55 | 10-32x0.3 | .63/16.00 |
| HUBG-125A | 1-1/4 | 1.67 — 1.77/ 42.4 — 44.9 | 0.03 — 0.25/ 0.8 — 6.4 | 1.02/25.91 | .69/17.53 | 2.36/59.94 | 1/4-20x0.333 | .69/17.53 |
| HUBG-150A | 1-1/2 | 1.92 — 2.02/ 48.8 — 51.3 | 0.06 — 0.25/ 1.5 — 6.4 | 1.02/25.91 | .69/17.53 | 2.74/69.60 | 1/4-20x0.333 | .81/20.57 |
| HUBG-200A | 2 | 2.36 — 2.50/ 59.9 — 63.5 | 0.06 — 0.25/ 1.5 — 6.4 | 1.08/27.43 | .66/16.76 | 3.23/82.04 | 1/4-20x0.333 | .81/20.57 |

† PVC coating available on select hubs. Add suffix **-PVC** to catalog number.

COMMERCIAL PRODUCTS: RIGID AND IMC FITTINGS

Commercial Products

Visit our website at www.appletonelec.com or contact us at (800) 621-1506.

© August 2011



Watertight Hubs

Aluminum Die Cast, Insulated and Gasketed

Suitable for use in Class I, Division 2

Applications

- Used to connect rigid metal conduit or IMC to a threadless opening in an enclosure.
- May be used in wet or dry locations, indoors or outdoors.

Features

- Rugged metallic construction ensures mechanical protection.
- Insulated throat, rated up to 302 °F/150 °C, prevents wire abrasion.
- Integral O-ring provides watertight seal.
- Grounding version provides positive ground for external conductor.
- Unique profile permits easy wrenching.
- Smooth, accurately tapped threads facilitate installation.
- Watertight and corrosion resistant.
- NEMA Types 2, 3, 3R, 4, 4X, 5, 12, 13

Material/Finish

- Bodies and nuts: aluminum die cast
- O-ring: BUNA-N
- Insulator: polypropylene
- Ground screw: stainless steel

Certifications and Compliances

- UL Standard: 514B
- UL Listed: E14814
- CSA Standard: C22.2 No. 18.3
- CSA Certified: 065178
- NEMA: FB-1

Options

- PVC coating available on select hubs. Add suffix **-PVC** to catalog number.



HUB



HUBG

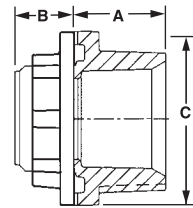

HUB Series

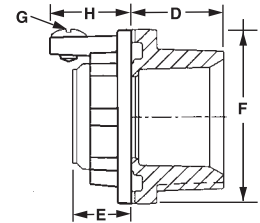

HUBG Series

COMMERCIAL PRODUCTS: RIGID AND IMC FITTINGS

Hub Spacing

| Knockout Hole Size (in./mm.) | Trade Size (Inches) | Trade Size Dimensions in Inches | | | | | |
|------------------------------|---------------------|---------------------------------|------------------|------------------|------------------|------------------|------------------|
| | | 1/2" | 3/4" | 1" | 1-1/4" | 1-1/2" | 2" |
| 0.88/22.2 | 1/2 | 1.56/39.6 | | | | | |
| 1.13/3.2 | 3/4 | 1.69/42.9 | 1.81/45.9 | | | | |
| 1.38/9.5 | 1 | 1.84/46.7 | 1.99/50.5 | 2.13/54.1 | | | |
| 1.75/19.1 | 1-1/4 | 2.03/51.6 | 2.16/54.9 | 2.31/58.7 | 2.50/63.5 | | |
| 2.00/50.8 | 1-1/2 | 2.22/56.4 | 2.34/59.4 | 2.50/63.5 | 2.69/68.3 | 2.88/73.2 | |
| 2.50/63.5 | 2 | 2.47/62.7 | 2.59/65.8 | 2.75/69.9 | 2.94/74.7 | 3.13/79.5 | 3.38/85.9 |

Dimensions in **bold** are for centers of conduits of same size, all other dimensions are for centers of conduits of a different size.

Watertight Hubs

Aluminum Die Cast, Insulated and Gasketed

Suitable for use in Class I, Division 2

Aluminum Die Cast Hubs — Insulated

| Catalog Number | Trade Size (Inches) | Dimensions in Inches/Millimeters | | Dimensions in Inches/Millimeters | | |
|----------------|---------------------|----------------------------------|-----------------------------|----------------------------------|-----------|------------|
| | | Hole Diameter Min. — Max. | Panel Thickness Min. — Max. | A | B | C |
| HUB-50A † | 1/2 | 0.86 — 0.91/ 21.8 — 23.1 | 0.03 — 0.25/ 0.8 — 6.4 | .83/21.08 | .57/14.49 | 1.44/36.58 |
| HUB-75A † | 3/4 | 1.08 — 1.14/ 27.4 — 28.9 | 0.03 — 0.25/ 0.8 — 6.4 | .90/22.86 | .59/14.99 | 1.67/42.42 |
| HUB-100A † | 1 | 1.33 — 1.41/ 33.8 — 35.8 | 0.03 — 0.25/ 0.8 — 6.4 | 1.06/26.92 | .67/17.02 | 1.99/50.55 |
| HUB-125A † | 1-1/4 | 1.67 — 1.77/ 42.4 — 44.9 | 0.03 — 0.25/ 0.8 — 6.4 | 1.02/25.91 | .69/17.53 | 2.36/59.94 |
| HUB-150A † | 1-1/2 | 1.92 — 2.02/ 48.8 — 51.3 | 0.06 — 0.25/ 1.5 — 6.4 | 1.02/25.91 | .69/17.53 | 2.74/69.60 |
| HUB-200A † | 2 | 2.36 — 2.50/ 59.9 — 63.5 | 0.06 — 0.25/ 1.5 — 6.4 | 1.08/27.43 | .66/16.76 | 3.23/82.04 |

Grounding Style Hubs — Insulated

| Catalog Number | Trade Size (Inches) | Dimensions in Inches/Millimeters | | Dimensions in Inches/Millimeters | | | | |
|----------------|---------------------|----------------------------------|-----------------------------|----------------------------------|-----------|------------|--------------|-----------|
| | | Hole Diameter Min. — Max. | Panel Thickness Min. — Max. | D | E | F | G | H |
| HUBG-50A | 1/2 | 0.86 — 0.91/ 21.8 — 23.1 | 0.03 — 0.25/ 0.8 — 6.4 | .83/21.08 | .57/14.48 | 1.44/36.58 | 10-32x0.3 | .59/14.99 |
| HUBG-75A | 3/4 | 1.08 — 1.14/ 27.4 — 28.9 | 0.03 — 0.25/ 0.8 — 6.4 | .90/22.86 | .59/14.99 | 1.67/42.42 | 10-32x0.3 | .59/14.99 |
| HUBG-100A | 1 | 1.33 — 1.41/ 33.8 — 35.8 | 0.03 — 0.25/ 0.8 — 6.4 | 1.06/26.92 | .67/17.02 | 1.99/50.55 | 10-32x0.3 | .63/16.00 |
| HUBG-125A | 1-1/4 | 1.67 — 1.77/ 42.4 — 44.9 | 0.03 — 0.25/ 0.8 — 6.4 | 1.02/25.91 | .69/17.53 | 2.36/59.94 | 1/4-20x0.333 | .69/17.53 |
| HUBG-150A | 1-1/2 | 1.92 — 2.02/ 48.8 — 51.3 | 0.06 — 0.25/ 1.5 — 6.4 | 1.02/25.91 | .69/17.53 | 2.74/69.60 | 1/4-20x0.333 | .81/20.57 |
| HUBG-200A | 2 | 2.36 — 2.50/ 59.9 — 63.5 | 0.06 — 0.25/ 1.5 — 6.4 | 1.08/27.43 | .66/16.76 | 3.23/82.04 | 1/4-20x0.333 | .81/20.57 |

† PVC coating available on select hubs. Add suffix **-PVC** to catalog number.