

**Description**

The Halo E5 series consists of compact and efficient recessed housings optimized and listed for PAR20 and PAR30, EISA compliant, tungsten-halogen, CFL and LED lamps as well as incandescent. The Halo E5 housing is suitable for residential or light commercial applications. For installation in insulated ceilings\* and non-insulated ceilings; with airtight code compliant construction. Use with a variety of trims and finishes to create different lighting effects or to match any decor. May be retrofit with HALO LED lighting systems.

Catalog #		Type
Project		
Comments		Date
Prepared by		

**Specification Features**

**Housing**

- Single wall die-formed aluminum housing
- Housing features a precision rolled interlocking collar which maintains aperture geometry for greater assurance of installation results
- Integral Air-Tite gasket for code-required gasket between fixture and finished ceiling - seals aperture without need for additional caulk
- Shipped with socket overspray protector installed
- May be removed from the plaster frame to provide access to junction box

**Socket Plate**

- Rigid socket plate adjusts and locks without tools for various lamp sizes.
- Socket plate and bracket may be removed when using socket supporting trims

**Plaster Frame**

- Galvanized steel frame. Housing adjusts in plaster frame to accommodate up to 3/8" - 1" ceiling thickness
- (2) Regressed locking screws for securing hanger bars
- Integral Air-Tite gasket seals housing and meets code-required gasket between fixture and finished ceiling

**Includes:**

**Bar Hangers**

**All Nail!™**

- Integral precisely positioned nail for engineered and natural framing
- Mini-foot leveling flange
- Integral T-Grid Clip, no accessory clips required

**q-Channel bars with Pass-N-Thru™**

- Unique inverted "q" interlocking channel for rigidity and stability
- Pass-N-Thru™ feature allows bars to cross-over for tool-less shortening in tight spaces

**Hinged junction box w/**

**Slide-N-Side™**

- (4) 1/2" conduit pry-outs
- (3) Slide-N-Side™ Non-Metallic (NM) wire traps, allow wiring outside the box
- For 14-2, 14-3, 12-2, 12-3 U.S. and 14-2, 14-3, 12-2 Canadian
- Hinged door for easy access
- Box is repositionable 90° on frame to avoid obstructions

**Quick Connect™**

- (3) Push wire nuts included, for speed & reliability
- Clear caps for wire connection visibility

**cULus Listed**

- Compact 16 in³ volume
- Listed for max. (10) No. 12 AWG or (14) No. 14 AWG 90° C splice conductors in box

**Air-Tite™ code compliant**

- Certified under ASTM E283
- Exclusive gasket seals aperture, frame & ceiling
- No additional caulk required

**Socket**

- Porcelain socket with nickel plated brass screw shell
- Snap-in springs secure socket to socket plate, and may be detached when using socket supporting trims

**Thermal Protector**

- Self resetting thermal protector deactivates fixture if overheating occurs due to improper lamping or misapplied insulation

**Trims**

- Halo Fit-All concept offers multiple trim options in a variety of design styles, and functional beam distributions to control beam angle and lumen delivery in accommodating various lamp types including Halogen, CFL and LED

**Compliance**

- cULus Listed 1598 Luminaire
- cULus Listed Damp Location
- cULus Listed for Wet Location, covered ceiling, with select trims
- cULus Listed for direct contact with insulation and combustible material\*
- Air-Tite code compliant. Certified under ASTM E283; not exceeding 2.0 cfm (0.944 L/s) air leakage rate tested at a 1.57 psf (75 Pa) pressure differential
- RoHS compliant

\*Not to be used in direct contact with spray foam insulation (Consult NEMA LSD57-2013)



**E5ICAT**

**5" IC, Air-Tite, New Construction Housing**

**E26 Screw base housing**

**Dimensions**

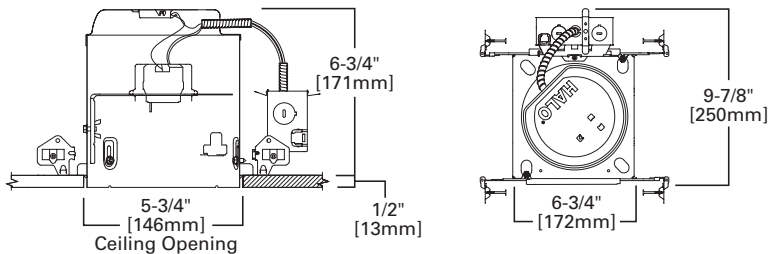

**FOR USE IN INSULATED CEILINGS**

**FOR DIRECT CONTACT WITH INSULATION\***

**Special Features**

- All-Nail!™ bar hangers
- q-Channel bars with Pass-N-Thru™
- Hinged J-Box with Slide-N-Side™
- Quick Connect™ push wire nuts
- Air-Tite™ code compliant

## Ordering Information

Sample Number: E5ICAT 5110WB

Order housing, trim and lamp (by others) separately for a complete luminaire.

### Housing

E5ICAT = 5" insulated ceiling, airtight recessed housing, new construction, 120V

### Trims

<p><b>Reflectors</b></p> <p><b>5020 PAR Reflector</b> OD: 6-3/8" [162mm] 5020P=White Reflector and Trim 5020H=Haze Reflector, White Trim 5020SC=Clear Specular Reflector, White Trim 5020BL=Black Specular Reflector, White Trim 5020SN=Satin Nickel Reflector and Trim 5020TBZ=Tuscan Bronze Reflector and Trim</p>	<p><b>5125 Full Cone Baffle, Self-flange</b> OD: 6-3/4" [172mm] 5125WB=White Baffle and Trim 5125BB=Black Baffle, White Trim</p> <p><b>5126 Shallow Full Cone Baffle, Self-flange</b> OD: 6-3/4" [172mm] 5126WH=White Baffle and Trim 5126BB=Black Baffle, White Trim</p>	<p><b>5162 Drop Opal Plastic Lens, Self-flange - Showerlight</b> OD: 6-3/8" [162mm] 5162WH=Drop Opal Plastic Lens with Reflector, White Plastic Trim</p> <p><b>5230 Squirrel Frost Lens, Metal Trim, Self-flange - Showerlight</b> OD: 6-3/4" [172mm] 5230AH=Frost Glass Lens, Aluminum Haze Squirrel Trim 5230PN=Frost Glass Lens, Polished Nickel Squirrel Trim 5230AH=Frost Glass Lens, Satin Nickel Squirrel Trim 5230AH=Frost Glass Lens, Tuscan Bronze Squirrel Trim</p>
<p><b>5021 Full Reflector</b> OD: 6-3/8" [162mm] 5021H=Haze Reflector, White Trim 5021SC=Specular Clear Reflector, White Trim 5021SN=Satin Nickel Reflector and Trim 5021TBZ=Tuscan Bronze Reflector and Trim</p>	<p><b>Adjustable - Eyeballs &amp; Gimbals</b></p> <p><b>5060 PAR30 Adjustable Gimbal 20° Tilt, Self-flange</b> OD: 6-3/8" [162mm] 5060P=White Gimbal and Trim</p>	
<p><b>5107 Specular Reflector, Self-flange</b> OD: 6-5/8" [168mm] 5107SC=Specular Reflector, White Trim</p>	<p><b>5070 PAR30 Adjustable Eyeball 30° Tilt, Self-flange</b> OD: 6-3/4" [172mm] 5070P=White Eyeball and Trim 5070SN=Satin Nickel Eyeball and Trim 5070TBZ=Tuscan Bronze Eyeball and Trim</p>	<p><b>5255 Soft Square, Frost Curve Glass Lens, Self-flange - Showerlight</b> OD: 6-3/4" [172mm] 5255WH=Frost Curve Glass Lens with Reflector, White Plastic Trim 5255SN=Frost Curve Glass Lens with Reflector, Satin Nickel Plastic Trim 5230TBZ=Frost Curve Glass Lens with Reflector, Tuscan Bronze Plastic Trim</p>
<p><b>5120 Full Cone, Self-flange</b> OD: 6-5/8" [168mm] 5120WH=White Reflector and Trim 5120SN=Satin Nickel Reflector and Trim 5120TBZ=Tuscan Bronze Reflector and Trim</p>	<p><b>5071 PAR20 Adjustable Eyeball 30° Tilt, Self-flange</b> OD: 6-3/8" [162mm] 5071P=White Eyeball and Trim</p>	
<p><b>5121 Shallow Full Cone, Self-flange</b> OD: 6-5/8" [168mm] 5121WH=White Reflector and Trim</p>	<p><b>5130 PAR30 Eyeball 35° Tilt, Self-flange</b> OD: 6-3/8" [162mm] 5130WH=White Eyeball and Trim</p>	<p><b>5145 Open Wet Location, Shallow Reflector, Self-flange - Showerlight*</b> OD: 6-3/4" [172mm] 5145WH=White Reflector and Trim 5145SN=Satin Nickel Reflector and Trim 5145TBZ=Tuscan Bronze Reflector and Trim</p>
<p><b>Baffles</b></p> <p><b>5001 PAR Metal Baffle Splay</b> OD: 6-3/8" [162mm] 5001P=White Baffle and Trim 5001MB=Black Baffle, White Trim 5001SN=Satin Nickel Baffle and Trim 5001TBZ=Tuscan Bronze Baffle and Trim</p>	<p><b>5135 PAR20 Eyeball 35° Tilt, Self-flange</b> OD: 6-3/8" [162mm] 5135WH=White Eyeball and Trim</p> <p><b>5165 PAR30 Gimbal 25° Tilt, Self-flange</b> OD: 6-3/4" [172mm] 5165WH=White Gimbal and Trim 5165BK=Black Gimbal and Trim 5165SN=Satin Nickel Gimbal and Trim 5165TBZ=Tuscan Bronze Gimbal and Trim</p>	<p><b>5146 Open Wet Location, Full Reflector, Self-flange - Showerlight*</b> OD: 6-3/4" [172mm] 5146WH=White Reflector and Trim 5146SN=Satin Nickel Reflector and Trim 5146TBZ=Tuscan Bronze Reflector and Trim</p>
<p><b>5010 PAR Metal Step Baffle</b> OD: 6-3/8" [162mm] 5010W=White Baffle and Trim 5010=Black Baffle, White Trim</p>	<p><b>5222 Regressed PAR30 Adjustable, 35° Tilt, Self-flange</b> OD: 6-3/4" [172mm] 5222WB=White Baffle and Trim 5222BB=Black Baffle, White Trim 5222SC=Specular Clear Reflector, White Trim 5222H=Haze Reflector, White Trim</p>	<p><b>Open, Splay &amp; Wall Wash</b></p> <p><b>5000 PAR Metal Splay, Self-flange</b> OD: 6-3/8" [162mm] 5000P=White Splay and Trim 5000SN=Satin Nickel Splay and Trim 5000TBZ=Tuscan Bronze Splay and Trim</p>
<p><b>5014 Shallow Metal Baffle, Self-flange</b> OD: 6-3/8" [162mm] 5014P=White Baffle and Trim 5014MB=Black Baffle, White Trim</p>	<p><b>5051 Frosted Lens - Showerlight</b> OD: 6-3/8" [162mm] 5051PS=Frosted Glass Lens, White Trim</p>	<p><b>5175 Open, Wide, Self-flange</b> OD: 6-3/8" [162mm] 5175WH=White Trim 5175SN=Satin Nickel Trim 5175TBZ=Tuscan Bronze Trim</p>
<p><b>5016 Coilex® Baffle with Reflector and Torsion Springs</b> OD: 6-3/8" [162mm] 5016W=White Coilex Baffle and Trim 5016P=Black Coilex Baffle, White Trim</p>	<p><b>Lenses &amp; Wet Location Showerlights</b></p> <p><b>5054 Air-Tite Frosted Dome Lens - Showerlight</b> OD: 6-3/8" [162mm] 5054PS=Frosted Glass Dome, White Plastic Trim 5054SNS=Frosted Glass Dome, Satin Nickel Plastic Trim 5054TBZS=Frosted Glass Dome, Tuscan Bronze Plastic Trim</p>	<p><b>5176 Open, Wide with Fixed Socket Basket, Self-flange</b> OD: 6-3/8" [162mm] 5176WH=White Trim 5176SN=Satin Nickel Trim 5176TBZ=Tuscan Bronze Trim</p>
<p><b>5102 Tapered Metal Baffle, Self-flange</b> OD: 6-3/8" [162mm] 5102WB=White Baffle and Trim 5102BB=Black Baffle, White Trim</p>	<p><b>5150 Frost Dome Glass Lens, Self-flange - Showerlight</b> OD: 6-3/8" [162mm] 5150WH=Frost Dome Glass Lens with Reflector, White Plastic Trim 5150SN=Frost Dome Glass Lens with Reflector, Satin Nickel Plastic Trim 5150TBZ=Frost Dome Glass Lens with Reflector, Tuscan Bronze Plastic Trim</p>	<p><b>5176 Open, Wide, Self-flange</b> OD: 6-3/8" [162mm] 5176WH=White Trim 5176SN=Satin Nickel Trim 5176TBZ=Tuscan Bronze Trim</p>
<p><b>5109 Coilex® Tapered Baffle, Self-flange</b> OD: 6-3/8" [162mm] 5109WB=White Plastic Straight Coilex Baffle and Trim 5109BB=Black Plastic Straight Coilex Baffle, White Trim 5109BKBB=Black Plastic Straight Coilex Baffle and Black Trim</p>		<p><b>5185 Open, Splay, Self-flange</b> OD: 6-3/8" [162mm] 5185WH=White Trim 5185SN=Satin Nickel Trim 5185TBZ=Tuscan Bronze Trim</p>
<p><b>5110 Pertex Baffle, Self-flange</b> OD: 6-3/4" [172mm] 5110WB=White Pertex Baffle and Trim 5110BB=Black Pertex Baffle, White Trim 5110BKBB=Black Pertex Baffle and Black Trim</p>		<p><b>5186 Splay with Fixed Socket Bracket, Self-flange</b> OD: 6-3/8" [162mm] 5186WH=White Trim 5186SN=Satin Nickel Trim 5186TBZ=Tuscan Bronze Trim</p>

\*Outdoor rated lamp only (purchase separately)

**Description**

The Halo E5 series consists of compact and efficient recessed housings optimized and listed for PAR20 and PAR30, EISA compliant, tungsten-halogen, CFL and LED lamps as well as incandescent. The Halo E5 housing is suitable for residential or light commercial applications. For installation in insulated ceilings\* and non-insulated ceilings; with airtight code compliant construction. Use with a variety of trims and finishes to create different lighting effects or to match any decor. May be retrofit with HALO LED lighting systems.

Catalog #		Type
Project		
Comments		Date
Prepared by		

**Specification Features**

**Housing**

- Single wall die-formed aluminum housing
- Housing features a precision rolled interlocking collar which maintains aperture geometry for greater assurance of installation results
- Integral Air-Tite gasket for code-required gasket between fixture and finished ceiling - seals aperture without need for additional caulk
- Shipped with socket overspray protector installed
- May be removed from the plaster frame to provide access to junction box

**Socket Plate**

- Rigid socket plate adjusts and locks without tools for various lamp sizes.
- Socket plate and bracket may be removed when using socket supporting trims

**Plaster Frame**

- Galvanized steel frame. Housing adjusts in plaster frame to accommodate up to 3/8" - 1" ceiling thickness
- (2) Regressed locking screws for securing hanger bars
- Integral Air-Tite gasket seals housing and meets code-required gasket between fixture and finished ceiling

**Includes:**

**Bar Hangers**

**All Nail!™**

- Integral precisely positioned nail for engineered and natural framing
- Mini-foot leveling flange
- Integral T-Grid Clip, no accessory clips required

**q-Channel bars with Pass-N-Thru™**

- Unique inverted "q" interlocking channel for rigidity and stability
- Pass-N-Thru™ feature allows bars to cross-over for tool-less shortening in tight spaces

**Hinged junction box w/**

**Slide-N-Side™**

- (4) 1/2" conduit pry-outs
- (3) Slide-N-Side™ Non-Metallic (NM) wire traps, allow wiring outside the box
- For 14-2, 14-3, 12-2, 12-3 U.S. and 14-2, 14-3, 12-2 Canadian
- Hinged door for easy access
- Box is repositionable 90° on frame to avoid obstructions

**Quick Connect™**

- (3) Push wire nuts included, for speed & reliability
- Clear caps for wire connection visibility

**cULus Listed**

- Compact 16 in³ volume
- Listed for max. (10) No. 12 AWG or (14) No. 14 AWG 90° C splice conductors in box

**Air-Tite™ code compliant**

- Certified under ASTM E283
- Exclusive gasket seals aperture, frame & ceiling
- No additional caulk required

**Socket**

- Porcelain socket with nickel plated brass screw shell
- Snap-in springs secure socket to socket plate, and may be detached when using socket supporting trims

**Thermal Protector**

- Self resetting thermal protector deactivates fixture if overheating occurs due to improper lamping or misapplied insulation

**Trims**

- Halo Fit-All concept offers multiple trim options in a variety of design styles, and functional beam distributions to control beam angle and lumen delivery in accommodating various lamp types including Halogen, CFL and LED

**Compliance**

- cULus Listed 1598 Luminaire
- cULus Listed Damp Location
- cULus Listed for Wet Location, covered ceiling, with select trims
- cULus Listed for direct contact with insulation and combustible material\*
- Air-Tite code compliant. Certified under ASTM E283; not exceeding 2.0 cfm (0.944 L/s) air leakage rate tested at a 1.57 psf (75 Pa) pressure differential
- RoHS compliant

\*Not to be used in direct contact with spray foam insulation (Consult NEMA LSD57-2013)



**E5ICAT**

**5" IC, Air-Tite, New Construction Housing**

**E26 Screw base housing**

**Dimensions**

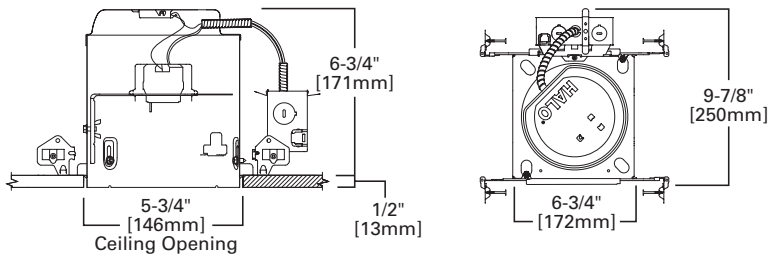

**FOR USE IN INSULATED CEILINGS**

**FOR DIRECT CONTACT WITH INSULATION\***

**Special Features**

- All-Nail!™ bar hangers
- q-Channel bars with Pass-N-Thru™
- Hinged J-Box with Slide-N-Side™
- Quick Connect™ push wire nuts
- Air-Tite™ code compliant

## Ordering Information

Sample Number: E5ICAT 5110WB

Order housing, trim and lamp (by others) separately for a complete luminaire.

### Housing

E5ICAT = 5" insulated ceiling, airtight recessed housing, new construction, 120V

### Trims

	<p><b>Reflectors</b></p> <p><b>5020 PAR Reflector</b> OD: 6-3/8" [162mm] 5020P=White Reflector and Trim 5020H=Haze Reflector, White Trim 5020SC=Clear Specular Reflector, White Trim 5020BL=Black Specular Reflector, White Trim 5020SN=Satin Nickel Reflector and Trim 5020TBZ=Tuscan Bronze Reflector and Trim</p>		<p><b>5125 Full Cone Baffle, Self-flange</b> OD: 6-3/4" [172mm] 5125WB=White Baffle and Trim 5125BB=Black Baffle, White Trim</p>		<p><b>5162 Drop Opal Plastic Lens, Self-flange - Showerlight</b> OD: 6-3/8" [162mm] 5162WH=Drop Opal Plastic Lens with Reflector, White Plastic Trim</p>
	<p><b>5021 Full Reflector</b> OD: 6-3/8" [162mm] 5021H=Haze Reflector, White Trim 5021SC=Specular Clear Reflector, White Trim 5021SN=Satin Nickel Reflector and Trim 5021TBZ=Tuscan Bronze Reflector and Trim</p>		<p><b>5126 Shallow Full Cone Baffle, Self-flange</b> OD: 6-3/4" [172mm] 5126WH=White Baffle and Trim 5126BB=Black Baffle, White Trim</p>		<p><b>5230 Squirrel Frost Lens, Metal Trim, Self-flange - Showerlight</b> OD: 6-3/4" [172mm] 5230AH=Frost Glass Lens, Aluminum Haze Squirrel Trim 5230PN=Frost Glass Lens, Polished Nickel Squirrel Trim 5230AH=Frost Glass Lens, Satin Nickel Squirrel Trim 5230AH=Frost Glass Lens, Tuscan Bronze Squirrel Trim</p>
	<p><b>5107 Specular Reflector, Self-flange</b> OD: 6-5/8" [168mm] 5107SC=Specular Reflector, White Trim</p>		<p><b>Adjustable - Eyeballs &amp; Gimbals</b></p> <p><b>5060 PAR30 Adjustable Gimmel 20° Tilt, Self-flange</b> OD: 6-3/8" [162mm] 5060P=White Gimmel and Trim</p>		<p><b>5255 Soft Square, Frost Curve Glass Lens, Self-flange - Showerlight</b> OD: 6-3/4" [172mm] 5255WH=Frost Curve Glass Lens with Reflector, White Plastic Trim 5255SN=Frost Curve Glass Lens with Reflector, Satin Nickel Plastic Trim 5230TBZ=Frost Curve Glass Lens with Reflector, Tuscan Bronze Plastic Trim</p>
	<p><b>5120 Full Cone, Self-flange</b> OD: 6-5/8" [168mm] 5120WH=White Reflector and Trim 5120SN=Satin Nickel Reflector and Trim 5120TBZ=Tuscan Bronze Reflector and Trim</p>		<p><b>5070 PAR30 Adjustable Eyeball 30° Tilt, Self-flange</b> OD: 6-3/4" [172mm] 5070P=White Eyeball and Trim 5070SN=Satin Nickel Eyeball and Trim 5070TBZ=Tuscan Bronze Eyeball and Trim</p>		<p><b>5145 Open Wet Location, Shallow Reflector, Self-flange - Showerlight*</b> OD: 6-3/4" [172mm] 5145WH=White Reflector and Trim 5145SN=Satin Nickel Reflector and Trim 5145TBZ=Tuscan Bronze Reflector and Trim</p>
	<p><b>5121 Shallow Full Cone, Self-flange</b> OD: 6-5/8" [168mm] 5121WH=White Reflector and Trim</p>		<p><b>5071 PAR20 Adjustable Eyeball 30° Tilt, Self-flange</b> OD: 6-3/8" [162mm] 5071P=White Eyeball and Trim</p>		<p><b>5146 Open Wet Location, Full Reflector, Self-flange - Showerlight*</b> OD: 6-3/4" [172mm] 5146WH=White Reflector and Trim 5146SN=Satin Nickel Reflector and Trim 5146TBZ=Tuscan Bronze Reflector and Trim</p>
	<p><b>Baffles</b></p> <p><b>5001 PAR Metal Baffle Splay</b> OD: 6-3/8" [162mm] 5001P=White Baffle and Trim 5001MB=Black Baffle, White Trim 5001SN=Satin Nickel Baffle and Trim 5001TBZ=Tuscan Bronze Baffle and Trim</p>		<p><b>5130 PAR30 Eyeball 35° Tilt, Self-flange</b> OD: 6-3/8" [162mm] 5130WH=White Eyeball and Trim</p>		<p><b>Open, Splay &amp; Wall Wash</b></p> <p><b>5000 PAR Metal Splay, Self-flange</b> OD: 6-3/8" [162mm] 5000P=White Splay and Trim 5000SN=Satin Nickel Splay and Trim 5000TBZ=Tuscan Bronze Splay and Trim</p>
	<p><b>5010 PAR Metal Step Baffle</b> OD: 6-3/8" [162mm] 5010W=White Baffle and Trim 5010=Black Baffle, White Trim</p>		<p><b>5135 PAR20 Eyeball 35° Tilt, Self-flange</b> OD: 6-3/8" [162mm] 5135WH=White Eyeball and Trim</p>		<p><b>5175 Open, Wide, Self-flange</b> OD: 6-3/8" [162mm] 5175WH=White Trim 5175SN=Satin Nickel Trim 5175TBZ=Tuscan Bronze Trim</p>
	<p><b>5014 Shallow Metal Baffle, Self-flange</b> OD: 6-3/8" [162mm] 5014P=White Baffle and Trim 5014MB=Black Baffle, White Trim</p>		<p><b>5165 PAR30 Gimmel 25° Tilt, Self-flange</b> OD: 6-3/4" [172mm] 5165WH=White Gimmel and Trim 5165BK=Black Gimmel and Trim 5165SN=Satin Nickel Gimmel and Trim 5165TBZ=Tuscan Bronze Gimmel and Trim</p>		<p><b>5176 Open, Wide with Fixed Socket Basket, Self-flange</b> OD: 6-3/8" [162mm] 5176WH=White Trim 5176SN=Satin Nickel Trim 5176TBZ=Tuscan Bronze Trim</p>
	<p><b>5016 Coilex® Baffle with Reflector and Torsion Springs</b> OD: 6-3/8" [162mm] 5016W=White Coilex Baffle and Trim 5016P=Black Coilex Baffle, White Trim</p>		<p><b>5222 Regressed PAR30 Adjustable, 35° Tilt, Self-flange</b> OD: 6-3/4" [172mm] 5222WB=White Baffle and Trim 5222BB=Black Baffle, White Trim 5222SC=Specular Clear Reflector, White Trim 5222H=Haze Reflector, White Trim</p>		<p><b>5185 Open, Splay, Self-flange</b> OD: 6-3/8" [162mm] 5185WH=White Trim 5185SN=Satin Nickel Trim 5185TBZ=Tuscan Bronze Trim</p>
	<p><b>5102 Tapered Metal Baffle, Self-flange</b> OD: 6-3/8" [162mm] 5102WB=White Baffle and Trim 5102BB=Black Baffle, White Trim</p>		<p><b>Lenses &amp; Wet Location Showerlights</b></p> <p><b>5051 Frosted Lens - Showerlight</b> OD: 6-3/8" [162mm] 5051PS=Frosted Glass Lens, White Trim</p>		<p><b>5186 Splay with Fixed Socket Bracket, Self-flange</b> OD: 6-3/8" [162mm] 5186WH=White Trim 5186SN=Satin Nickel Trim 5186TBZ=Tuscan Bronze Trim</p>
	<p><b>5109 Coilex® Tapered Baffle, Self-flange</b> OD: 6-3/8" [162mm] 5109WB=White Plastic Straight Coilex Baffle and Trim 5109BB=Black Plastic Straight Coilex Baffle, White Trim 5109BKBB=Black Plastic Straight Coilex Baffle and Black Trim</p>		<p><b>5054 Air-Tite Frosted Dome Lens - Showerlight</b> OD: 6-3/8" [162mm] 5054PS=Frosted Glass Dome, White Plastic Trim 5054SNS=Frosted Glass Dome, Satin Nickel Plastic Trim 5054TBZS=Frosted Glass Dome, Tuscan Bronze Plastic Trim</p>		<p><b>5150 Frost Dome Glass Lens, Self-flange - Showerlight</b> OD: 6-3/8" [162mm] 5150WH=Frost Dome Glass Lens with Reflector, White Plastic Trim 5150SN=Frost Dome Glass Lens with Reflector, Satin Nickel Plastic Trim 5150TBZ=Frost Dome Glass Lens with Reflector, Tuscan Bronze Plastic Trim</p>
	<p><b>5110 Pertex Baffle, Self-flange</b> OD: 6-3/4" [172mm] 5110WB=White Pertex Baffle and Trim 5110BB=Black Pertex Baffle, White Trim 5110BKBB=Black Pertex Baffle and Black Trim</p>		<p><b>5150 Frost Dome Glass Lens, Self-flange - Showerlight</b> OD: 6-3/8" [162mm] 5150WH=Frost Dome Glass Lens with Reflector, White Plastic Trim 5150SN=Frost Dome Glass Lens with Reflector, Satin Nickel Plastic Trim 5150TBZ=Frost Dome Glass Lens with Reflector, Tuscan Bronze Plastic Trim</p>		<p><b>5186 Splay with Fixed Socket Bracket, Self-flange</b> OD: 6-3/8" [162mm] 5186WH=White Trim 5186SN=Satin Nickel Trim 5186TBZ=Tuscan Bronze Trim</p>

\*Outdoor rated lamp only (purchase separately)