

Contactors, Types DP and DPA—Class 8910

Definite purpose contactors are ideal for heating, air conditioning, refrigeration, data processing, and food service equipment. New, compact 1- and 2-pole contactors are available as well as full-size devices with 2, 3, or 4 poles. They feature the following:

- Quick connect terminals and binder head screws allow for easy wiring.
- Box lugs are standard on 40 A contactors and larger.
- An exclusive DIN track mounting option may reduce installation costs.
- Coils can be changed quickly, without a tool, on the Type DPA, 50–90 A contactors.
- Auxiliary contact modules snap on either side of the Type DPA contactors.

Table 1: Compact 1-Pole Contactors—600 Vac Maximum

| Full Load Amperes | Locked Rotor Amperes | | | Resistive Load Amperes | N.O. Poles | Type [1] |
|-------------------|----------------------|-------|-------|------------------------|------------|----------|
| | 277 V | 460 V | 575 V | | | |
| 20 | 120 | 100 | 80 | 25 | 1 | DP11 |
| 25 | 150 | 125 | 100 | 30 | 1 | DP21 |
| 30 | 150 | 125 | 100 | 40 | 1 | DP31 |
| 40 | 240 | 200 | 160 | 50 [2] | 1 | DP41 |

¹ Specify the voltage code when ordering this product. Refer to Table 7 on page 4.

² 50 A resistive limited to 277 V. Voltages above 277 V are rated 40 A resistive.



**Type DP22V09
2 pole**

Table 2: Compact 2-Pole Contactors—600 Vac Maximum [1]

| Full Load Amperes | Locked Rotor Amperes | | | Resistive Load Amperes | N.O. Poles | Type [2] |
|-------------------|----------------------|-------|-------|------------------------|------------|----------|
| | 277 V | 460 V | 575 V | | | |
| 20 | 120 | 100 | 80 | 30 | 2 | DP12 |
| 25 | 150 | 125 | 100 | 35 | 2 | DP22 |
| 30 | 150 | 125 | 100 | 40 | 2 | DP32 |
| 40 | 240 | 200 | 160 | 50 | 2 | DP42 |

¹ Above 240 V, all lines must be switched.

² Specify the voltage code when ordering this product. Refer to Table 7 on page 4.



**Type DP42V14
2 pole**

Table 3: 2, 3, and 4-Pole Contactors—600 Vac Maximum [1]

| Full Load Amperes | Locked Rotor Amperes | | | Resistance Load Amperes | Horsepower Ratings | | | | N.O. Poles | Type [2] |
|-------------------|----------------------|-------|-------|-------------------------|--------------------|-----------|-----------|---------------|-------------|-------------------------|
| | 230 V | 460 V | 575 V | | 115 V, 1Ø | 230 V, 1Ø | 230 V, 3Ø | 460/575 V, 3Ø | | |
| 20 | 120 | 100 | 80 | 30 | 1.5 | 3 | 7.5 | 7.5 | 2 3 4 | DPA12 DPA13 DPA14 |
| 25 | 150 | 125 | 100 | 35 | 2 | 5 | 10 | 15/20 | 2 3 4 | DPA22 DPA23 DPA24 |
| 30 | 180 | 150 | 120 | 40 | 2 | 5 | 10 | 15/20 | 2 3 4 | DPA32 DPA33 DPA34 |
| 40 | 240 | 200 | 160 | 50 | 3 | 7.5 | 10 | 20/25 | 2 3 4 | DPA42 DPA43 DPA44 |
| 50 | 300 | 250 | 200 | 62 | 3 | 10 | 15 | 30 | 2 3 | DPA52 DPA53 |
| 60 | 360 | 300 | 240 | 75 | 5 | 10 | 25 | 30 | 2 3 | DPA62 DPA63 |
| 75 | 450 | 375 | 300 | 94 | 5 | 15 | 25 | 40 | 2 3 | DPA72 DPA73 |
| 90 | 540 | 450 | 360 | 120 | 7.5 | 20 | 30 | 50 | 2 3 | DPA92 DPA93 |

¹ Above 240 V, all lines must be switched.

² Specify the voltage code when ordering this product. Refer to Table 7 on page 4.



**Type DPA33V04
3 pole**

Definite Purpose Control Contactors, Types DP and DPA—Class 8910

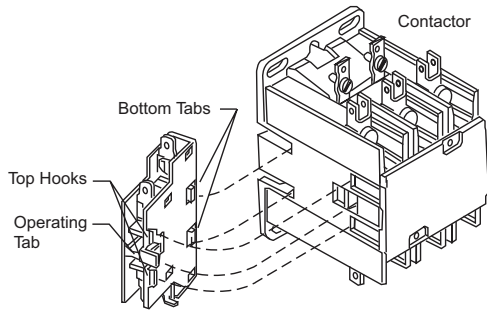

**Auxiliary Contact Installation
for 50–90 A
(no tools required)**

Table 4: 2 N.O. and 2 N.C. 4-Pole Contactors—600 Vac Maximum [1]

| Full Load Amperes | Resistive Load Amperes | N.O. Poles | N.C. Poles [2] | Class 8910 | |
|-------------------|------------------------|------------|----------------|------------|------|
| | | | | Type [3] | Form |
| 20 | 25 | 2 | 2 | DPA14 | Y392 |
| 25 | 35 | 2 | 2 | DPA24 | Y392 |
| 30 | 40 | 2 | 2 | DPA34 | Y392 |

¹ Above 240 V, all lines must be switched.

² The N.C. poles are on the outside. The N.C. poles open before the N.O. poles close.

³ Specify the voltage code when ordering this product. Refer to Table 7.

Table 5: Auxiliary Contacts

| For Use with Class 8910 Type | Contact Arrangement | Class 9999 Type | |
|------------------------------|---------------------|-----------------|---------|
| | | 20–40 A | 50–90 A |
| DPA | 1 N.O. | DD10 | D10 |
| | 1 N.C. | DD01 | D01 |
| | 1 N.O. and 1 N.C. | DD11 | D11 |
| | 2 N.O. | DD20 | D20 |

**Table 6: NEMA Type 1 General Purpose Enclosures
for Type DP and DPA Contactors**



| Class 8910 Type | Full Load Amperes | Poles | Class 9991 Type |
|-----------------|-------------------|---------|-----------------|
| DP | 20–40 | 1 and 2 | DPG1 |
| DPA | 20–40 | 2 and 3 | DPG1 |
| DPA | 50 | 2 and 3 | DPG2 |
| DPA | 20–40 | 4 | DPG2 |
| DPA | 60–75 | 2 and 3 | DPG3 |
| DPA | 90 | 2 and 3 | DPG4 |

Table 7: Coil Voltage Codes

| Voltage | | Code Type DP, DPA |
|---------|-------|----------------------|
| 60 Hz | 50 Hz | |
| 24 | 24 | V14 |
| 24 | — | — |
| 120 | 110 | V02 |
| 208 | — | — |
| 208–240 | 220 | V09 |
| 230–240 | 220 | — |
| 277 | — | V04 |
| 480 | 440 | V06 |
| 600 | 550 | V07 [1] |

¹ Not available for Type DP, 1- and 2-pole devices.

Table 8: Types DP and DPA Specifications

| | |
|---|--|
| Mechanical Life | 500,000 operations [1] |
| Electrical Life Type DP Type DPA | 100,000 operations 200,000 operations |
| Duty Cycle | Continuous |
| Operating Temperature | 0 °C to +65 °C (32 °F to +149 °F) |
| Slip-on Connector Rating | 30 A 75 °C wire |
| Approvals |  UL Recognized File E3190 CCN NLDX2  <small>CSA Certified File 222000 Class 2214 04</small> |

¹ Actual product life will vary based on electrical load, duty cycle, application, and environmental conditions.

Definite Purpose Control Contactors, Types DP and DPA—Class 8910

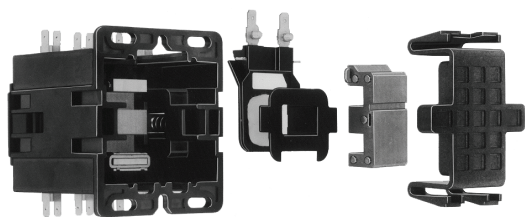

**Coil Replacement 50–60 A
(no tools required)**

Table 9: Class 8910 Type DPA Replacement Coils

| Full Load Amperes | Poles | Class 9998 Type ^[1] | Volt-Amperes ^[2] | |
|-------------------|---------|--------------------------------|-----------------------------|--------|
| | | | Inrush | Sealed |
| 50–60 | 2 and 3 | DA2V | 109 | 10 |
| 75–90 | 2 and 3 | DA3V | 214 | 19 |

¹ Append the suffix from Table 10. For example, the coil for Class 8910 Type DPA53V02 120 V, 60 Hz would be a Class 9998 Type DA2V02.

² For Types DP11 through DP32: Inrush 33 VA; Sealed 8 VA. Coils are not replaceable.
For Types DPA12 through DPA44: Inrush 60 VA, Sealed 6 VA. Coils are not replaceable.

Table 10: Type DPA Coil Voltage Codes

| Voltage, 60 Hz | Voltage, 50 Hz | Voltage Code |
|----------------|----------------|--------------------|
| 24 | 24 | V14 |
| 120 | 110 | V02 |
| 208–240 | 220 | V09 |
| 277 | — | V04 |
| 480 | 440 | V06 |
| 600 | 550 | V07 ^[1] |

¹ Available for Type DPA contactors only.

Table 11: Power Terminals

| Full Load Amperes | Power Terminals | |
|-------------------|-----------------|--|
| | Type of Lug | Sizes, AWG ^[1] Minimum-Maximum |
| 20–30 | binder head | 16-8 |
| 40 | box lug | 14-4 |
| 50–60 | box lug | 14-2 |
| 75–90 | box lug | 14-1/0 |

¹ Solid or stranded copper wire only.

Table 12: Mounting Attachment

| Description | Class 9999 Type |
|---------------------------------|-----------------|
| DIN mounting bracket attachment | DMB1 |

Factory Modifications

Table 13: Factory Modifications

| Modification | Form |
|--|----------------|
| Factory installed auxiliary contacts | ^[1] |
| Pressure wire connectors (20–30 A) | Y122 |
| Box lugs (20–30 A) | Y239 |
| DIN mounting bracket attached (35 mm style) ^[2] | Y135 |

¹ Contact your local Schneider Electric office.

² Available for 20–60 A devices only.

Definite Purpose Control Contactors, Types DP and DPA—Class 8910

**Figure 1: Type DP, 1 Pole
20–40 Full Load Amperes**

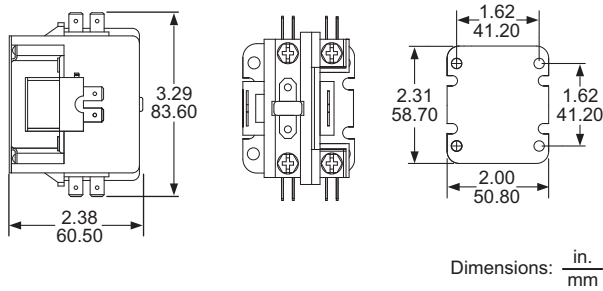

**Figure 2: Type DP, 2 Pole
20–40 Full Load Amperes**

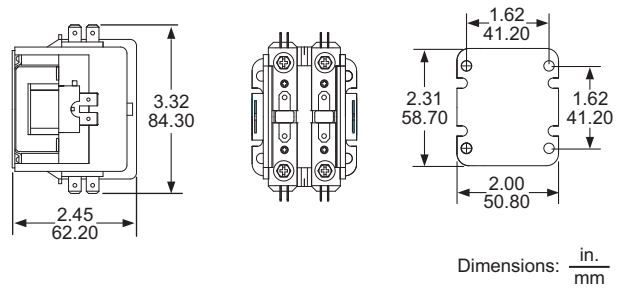

**Figure 3: Type DPA, 2 and 3 Pole
20–40 Full Load Amperes**

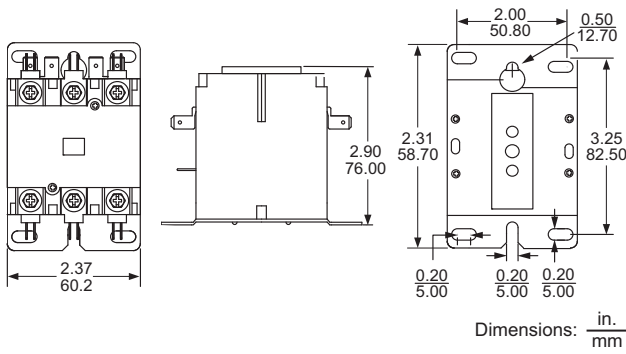

**Figure 4: Type DPA, 4 Pole
20–40 Full Load Amperes**

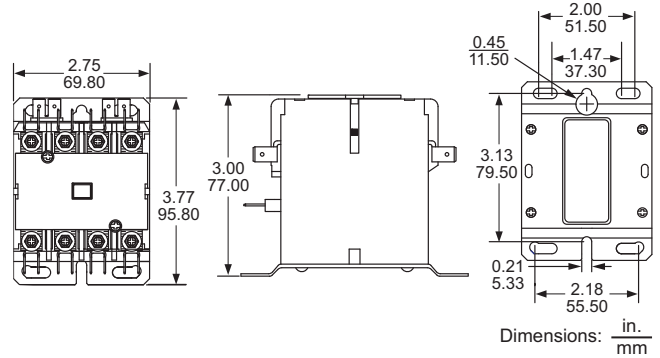

**Figure 5: Type DPA, 2 and 3 Pole
50 and 60 Full Load Amperes**

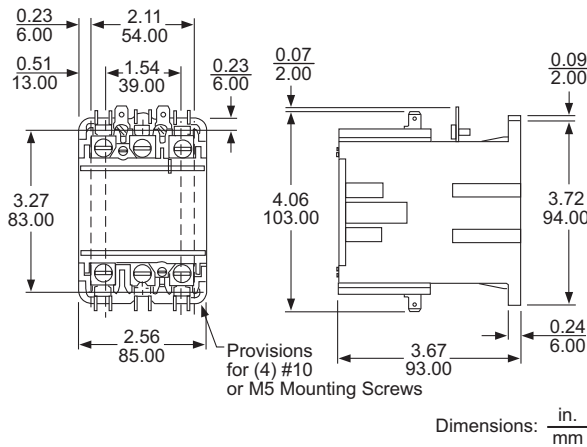

**Figure 6: Type DPA, 2 and 3 Pole
75 and 90 Full Load Amperes**

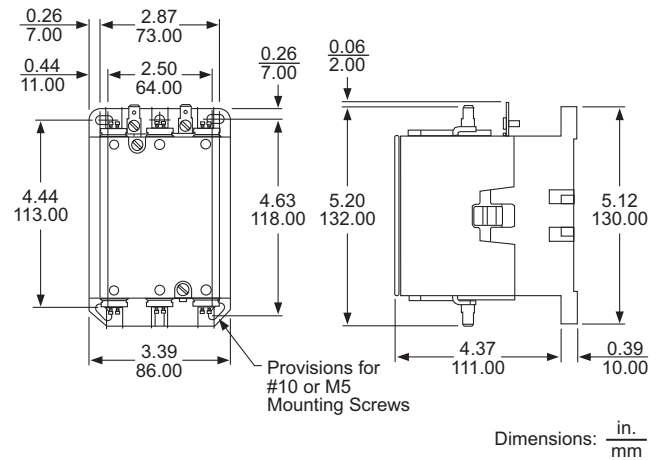

Contactors, Types DP and DPA—Class 8910

Definite purpose contactors are ideal for heating, air conditioning, refrigeration, data processing, and food service equipment. New, compact 1- and 2-pole contactors are available as well as full-size devices with 2, 3, or 4 poles. They feature the following:

- Quick connect terminals and binder head screws allow for easy wiring.
- Box lugs are standard on 40 A contactors and larger.
- An exclusive DIN track mounting option may reduce installation costs.
- Coils can be changed quickly, without a tool, on the Type DPA, 50–90 A contactors.
- Auxiliary contact modules snap on either side of the Type DPA contactors.

Table 1: Compact 1-Pole Contactors—600 Vac Maximum

| Full Load Amperes | Locked Rotor Amperes | | | Resistive Load Amperes | N.O. Poles | Type [1] |
|-------------------|----------------------|-------|-------|------------------------|------------|----------|
| | 277 V | 460 V | 575 V | | | |
| 20 | 120 | 100 | 80 | 25 | 1 | DP11 |
| 25 | 150 | 125 | 100 | 30 | 1 | DP21 |
| 30 | 150 | 125 | 100 | 40 | 1 | DP31 |
| 40 | 240 | 200 | 160 | 50 [2] | 1 | DP41 |

¹ Specify the voltage code when ordering this product. Refer to Table 7 on page 4.

² 50 A resistive limited to 277 V. Voltages above 277 V are rated 40 A resistive.



**Type DP22V09
2 pole**

Table 2: Compact 2-Pole Contactors—600 Vac Maximum [1]

| Full Load Amperes | Locked Rotor Amperes | | | Resistive Load Amperes | N.O. Poles | Type [2] |
|-------------------|----------------------|-------|-------|------------------------|------------|----------|
| | 277 V | 460 V | 575 V | | | |
| 20 | 120 | 100 | 80 | 30 | 2 | DP12 |
| 25 | 150 | 125 | 100 | 35 | 2 | DP22 |
| 30 | 150 | 125 | 100 | 40 | 2 | DP32 |
| 40 | 240 | 200 | 160 | 50 | 2 | DP42 |

¹ Above 240 V, all lines must be switched.

² Specify the voltage code when ordering this product. Refer to Table 7 on page 4.



**Type DP42V14
2 pole**

Table 3: 2, 3, and 4-Pole Contactors—600 Vac Maximum [1]

| Full Load Amperes | Locked Rotor Amperes | | | Resistance Load Amperes | Horsepower Ratings | | | | N.O. Poles | Type [2] |
|-------------------|----------------------|-------|-------|-------------------------|--------------------|-----------|-----------|---------------|-------------|-------------------------|
| | 230 V | 460 V | 575 V | | 115 V, 1Ø | 230 V, 1Ø | 230 V, 3Ø | 460/575 V, 3Ø | | |
| 20 | 120 | 100 | 80 | 30 | 1.5 | 3 | 7.5 | 7.5 | 2 3 4 | DPA12 DPA13 DPA14 |
| 25 | 150 | 125 | 100 | 35 | 2 | 5 | 10 | 15/20 | 2 3 4 | DPA22 DPA23 DPA24 |
| 30 | 180 | 150 | 120 | 40 | 2 | 5 | 10 | 15/20 | 2 3 4 | DPA32 DPA33 DPA34 |
| 40 | 240 | 200 | 160 | 50 | 3 | 7.5 | 10 | 20/25 | 2 3 4 | DPA42 DPA43 DPA44 |
| 50 | 300 | 250 | 200 | 62 | 3 | 10 | 15 | 30 | 2 3 | DPA52 DPA53 |
| 60 | 360 | 300 | 240 | 75 | 5 | 10 | 25 | 30 | 2 3 | DPA62 DPA63 |
| 75 | 450 | 375 | 300 | 94 | 5 | 15 | 25 | 40 | 2 3 | DPA72 DPA73 |
| 90 | 540 | 450 | 360 | 120 | 7.5 | 20 | 30 | 50 | 2 3 | DPA92 DPA93 |

¹ Above 240 V, all lines must be switched.

² Specify the voltage code when ordering this product. Refer to Table 7 on page 4.



**Type DPA33V04
3 pole**

Definite Purpose Control Contactors, Types DP and DPA—Class 8910

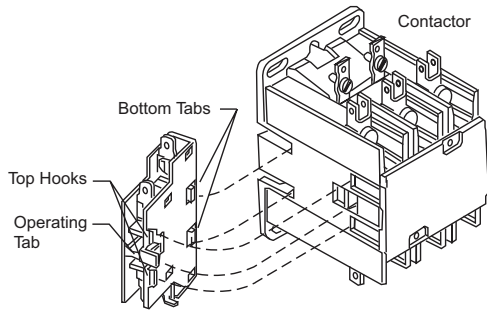

**Auxiliary Contact Installation
for 50–90 A
(no tools required)**

Table 4: 2 N.O. and 2 N.C. 4-Pole Contactors—600 Vac Maximum [1]

| Full Load Amperes | Resistive Load Amperes | N.O. Poles | N.C. Poles [2] | Class 8910 | |
|-------------------|------------------------|------------|----------------|------------|------|
| | | | | Type [3] | Form |
| 20 | 25 | 2 | 2 | DPA14 | Y392 |
| 25 | 35 | 2 | 2 | DPA24 | Y392 |
| 30 | 40 | 2 | 2 | DPA34 | Y392 |

¹ Above 240 V, all lines must be switched.

² The N.C. poles are on the outside. The N.C. poles open before the N.O. poles close.

³ Specify the voltage code when ordering this product. Refer to Table 7.

Table 5: Auxiliary Contacts

| For Use with Class 8910 Type | Contact Arrangement | Class 9999 Type | |
|------------------------------|---------------------|-----------------|---------|
| | | 20–40 A | 50–90 A |
| DPA | 1 N.O. | DD10 | D10 |
| | 1 N.C. | DD01 | D01 |
| | 1 N.O. and 1 N.C. | DD11 | D11 |
| | 2 N.O. | DD20 | D20 |

**Table 6: NEMA Type 1 General Purpose Enclosures
for Type DP and DPA Contactors**



| Class 8910 Type | Full Load Amperes | Poles | Class 9991 Type |
|-----------------|-------------------|---------|-----------------|
| DP | 20–40 | 1 and 2 | DPG1 |
| DPA | 20–40 | 2 and 3 | DPG1 |
| DPA | 50 | 2 and 3 | DPG2 |
| DPA | 20–40 | 4 | DPG2 |
| DPA | 60–75 | 2 and 3 | DPG3 |
| DPA | 90 | 2 and 3 | DPG4 |

Table 7: Coil Voltage Codes

| Voltage | | Code Type DP, DPA |
|---------|-------|----------------------|
| 60 Hz | 50 Hz | |
| 24 | 24 | V14 |
| 24 | — | — |
| 120 | 110 | V02 |
| 208 | — | — |
| 208–240 | 220 | V09 |
| 230–240 | 220 | — |
| 277 | — | V04 |
| 480 | 440 | V06 |
| 600 | 550 | V07 [1] |

¹ Not available for Type DP, 1- and 2-pole devices.

Table 8: Types DP and DPA Specifications

| | |
|---|---|
| Mechanical Life | 500,000 operations [1] |
| Electrical Life Type DP Type DPA | 100,000 operations 200,000 operations |
| Duty Cycle | Continuous |
| Operating Temperature | 0 °C to +65 °C (32 °F to +149 °F) |
| Slip-on Connector Rating | 30 A 75 °C wire |
| Approvals |  UL Recognized File E3190 CCN NLDX2  <small>CSA Certified File 220246 Class 201104</small> |

¹ Actual product life will vary based on electrical load, duty cycle, application, and environmental conditions.

Definite Purpose Control Contactors, Types DP and DPA—Class 8910

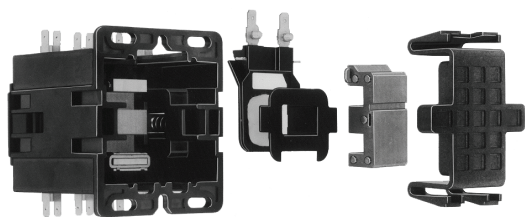

**Coil Replacement 50–60 A
(no tools required)**

Table 9: Class 8910 Type DPA Replacement Coils

| Full Load Amperes | Poles | Class 9998 Type ^[1] | Volt-Amperes ^[2] | |
|-------------------|---------|--------------------------------|-----------------------------|--------|
| | | | Inrush | Sealed |
| 50–60 | 2 and 3 | DA2V | 109 | 10 |
| 75–90 | 2 and 3 | DA3V | 214 | 19 |

¹ Append the suffix from Table 10. For example, the coil for Class 8910 Type DPA53V02 120 V, 60 Hz would be a Class 9998 Type DA2V02.

² For Types DP11 through DP32: Inrush 33 VA; Sealed 8 VA. Coils are not replaceable.
For Types DPA12 through DPA44: Inrush 60 VA, Sealed 6 VA. Coils are not replaceable.

Table 10: Type DPA Coil Voltage Codes

| Voltage, 60 Hz | Voltage, 50 Hz | Voltage Code |
|----------------|----------------|--------------------|
| 24 | 24 | V14 |
| 120 | 110 | V02 |
| 208–240 | 220 | V09 |
| 277 | — | V04 |
| 480 | 440 | V06 |
| 600 | 550 | V07 ^[1] |

¹ Available for Type DPA contactors only.

Table 11: Power Terminals

| Full Load Amperes | Power Terminals | |
|-------------------|-----------------|--|
| | Type of Lug | Sizes, AWG ^[1] Minimum-Maximum |
| 20–30 | binder head | 16-8 |
| 40 | box lug | 14-4 |
| 50–60 | box lug | 14-2 |
| 75–90 | box lug | 14-1/0 |

¹ Solid or stranded copper wire only.

Table 12: Mounting Attachment

| Description | Class 9999 Type |
|---------------------------------|-----------------|
| DIN mounting bracket attachment | DMB1 |

Factory Modifications

Table 13: Factory Modifications

| Modification | Form |
|--|----------------|
| Factory installed auxiliary contacts | ^[1] |
| Pressure wire connectors (20–30 A) | Y122 |
| Box lugs (20–30 A) | Y239 |
| DIN mounting bracket attached (35 mm style) ^[2] | Y135 |

¹ Contact your local Schneider Electric office.

² Available for 20–60 A devices only.

Definite Purpose Control Contactors, Types DP and DPA—Class 8910

**Figure 1: Type DP, 1 Pole
20–40 Full Load Amperes**

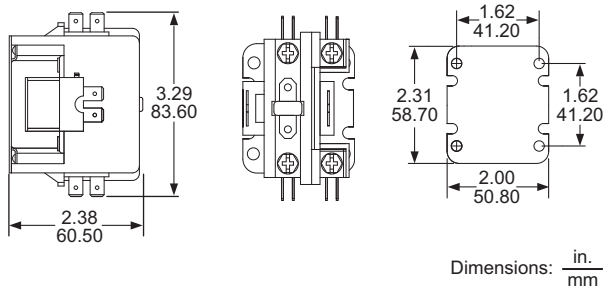

**Figure 2: Type DP, 2 Pole
20–40 Full Load Amperes**

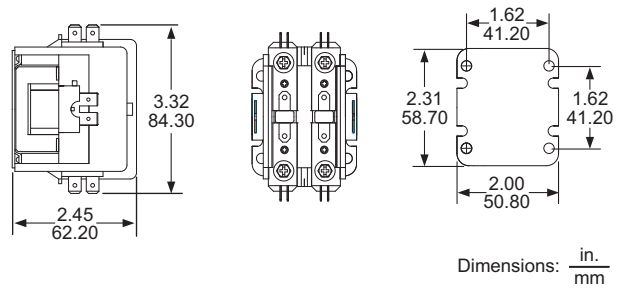

**Figure 3: Type DPA, 2 and 3 Pole
20–40 Full Load Amperes**

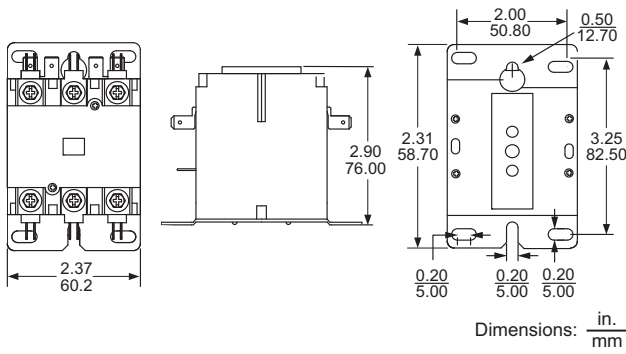

**Figure 4: Type DPA, 4 Pole
20–40 Full Load Amperes**

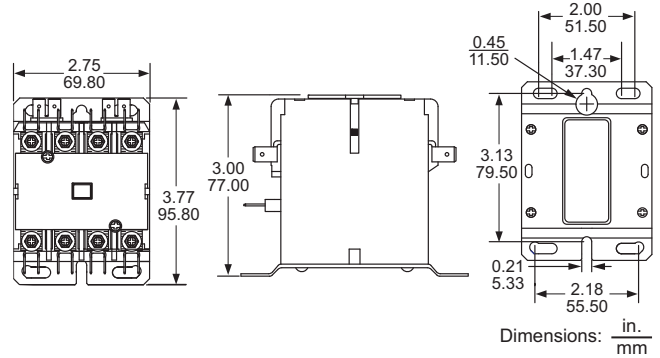

**Figure 5: Type DPA, 2 and 3 Pole
50 and 60 Full Load Amperes**

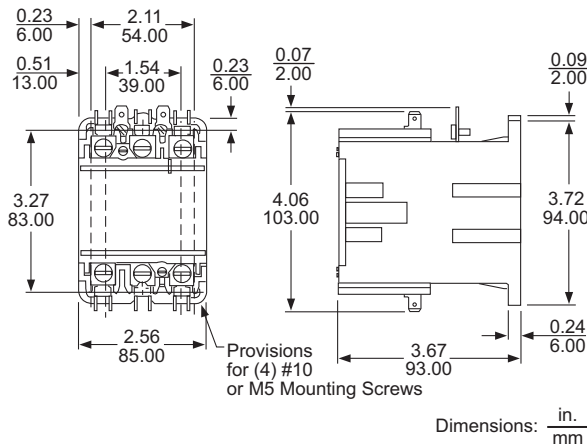

**Figure 6: Type DPA, 2 and 3 Pole
75 and 90 Full Load Amperes**

