



# NVENT CADDY ROD LOCK ANCHOR SCREW, 3/8" ROD, 2.875" X 1.25" X 0.875"

## CATALOG NUMBER

**CRLA37EG**



## CERTIFICATIONS



## FEATURES

For use with concrete and solid brick

Prefabricated assemblies easily lift and lock into place, helping to save time and money

Works with slightly damaged threads and minor burrs on the threaded rod

## PRODUCT ATTRIBUTES

Material: Steel

Finish: Electrogalvanized

Rod Size (RS): 3/8"

A: 2 7/8"

B: 1 1/4"

C: 7/8"

Drill Bit Diameter: 5/16"

Drill Hole Depth: 2"

Static Load (F): 652 lb

## DIAGRAMS

---

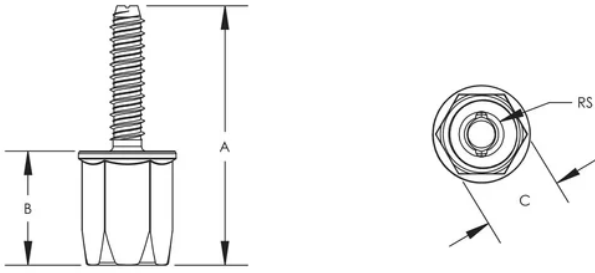

## WARNING

---

nVent products shall be installed and used only as indicated in nVent's product instruction sheets and training materials. Instruction sheets are available at [www.nvent.com](http://www.nvent.com) and from your nVent customer service representative. Improper installation, misuse, misapplication or other failure to completely follow nVent's instructions and warnings may cause product malfunction, property damage, serious bodily injury and death and/or void your warranty.

### North America

+1.800.753.9221  
Option 1 – Customer Care  
Option 2 – Technical Support

### Europe

Netherlands:  
+31 800-0200135  
France:  
+33 800 901 793

### Europe

Germany:  
800 1890272  
Other Countries:  
+31 13 5835404

### APAC

Shanghai:  
+ 86 21 2412 1618/19  
Sydney:  
+61 2 9751 8500



Our powerful portfolio of brands:  
**nVent.com** **CADDY ERICO HOFFMAN RAYCHEM SCHROFF**  
**TRACER**