

# Core & Coil (71A) MH 175W - 450W

## CORE & COIL HID MH BAL 200W M136 QUAD KIT

The basic ballast is the open core and coil which is most often used as a component within a lighting luminaire. The core and coil also forms the nucleus of Philips Advance's five other ballast configurations.

### Product data

General Information	
ANSI Code	M136
Lamp Type	200W MH
Number of Lamps	1 piece/unit
Circuit Type	SUPER-CWA
Ballast Type	Magnetic HID
Base Model	71A5692
Core Size	3 X 4 (2 coil)
Suitable For Outdoor Use	Yes
Ignitor Catalog Number	LI533-H4
Ignitor Temperature Rating	105°C
Capacitor Value	15 MFD
Capacitor Catalog Number	7C150M33
Capacitor Requirements	330V
Capacitor Temperature Rating	105°C
Capacitor Diameter/Oval Dimensions	1.65 in
Capacitor Height	3.75 in
Automatic Restart	No

Operating and Electrical	
Input Voltage	120/208/240/277 V

Input Frequency	60 Hz
Input Current (Open Circuit)	2/1.2/1/0.85 A
Input Current (Starting)	0.75/0.4/0.35/0.3 A
Input Current (Short Circuit)	0.45-0.7/0.25-0.4/0.22-0.35/0.2-0.3 A
Secondary Short Circuit Current	1.9-2.3 A
Constant Wattage Deviation	10%
Ballast Factor (Nom)	1
Power Factor (Nom)	0.90
Open Circuit Voltage	240 V
Input Current (Nom)	2/1.2/1/0.85 A A
Input Power (Nom)	232 W
Rated Lamp Power	200 W

Wiring	
Wire Striplength	0.5 mm
Wire Length by Color	12"
Wire Type	Stranded
Remote Wiring Configuration Allowed	Yes
Max Ballast-Lamp Distance Remote	2'

## Core & Coil (71A) MH 175W - 450W

Recommended Fuse Value	6/4/3/3 A
<b>Approval and Application</b>	
Open Circuit Voltage Test (Volts)	215-265 V
Approval Marks	ULR CSA certificate RoHS Compliant
Temperature Marking	A/B/A/A
UL Recognized	Yes
Hipot Test (1 Minute)	2000 V
Hipot Test (2 Seconds)	2500 V
UL Insulation Class	H(180°C)
UL Temperature Code	1029B

Product Data	
Order product name	CORE & COIL HID MH BAL 200W M136 QUAD KIT
EAN/UPC - Product	781087093474
Order code	913700534409
Numerator - Quantity Per Pack	1
Numerator - Packs per outer box	1
Material Nr. (12NC)	913700534409
Net Weight (Piece)	3.870 kg

### Dimensional drawing

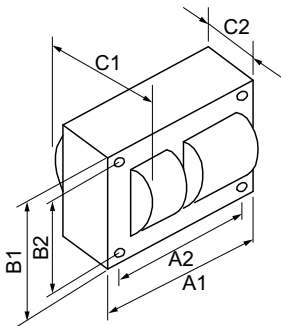

MH BAL 200W M136 QUAD KI

Product	C1	C2	A1	A2	B1	B2
CORE & COIL HID MH BAL 200W M136 QUAD KIT	3.6 in	2.45 in	3.9 in	3.5 in	2.8 in	2.4 in

