

SYLVANIA Lamps

ULTRA LED™ CCT Selectable High Bay Retrofit

Application

ULTRA LED High Bay lamps are ideal replacements for HID indoor high bay applications including retail, factory, garage, warehouse, and other industrial settings.

Benefits and Features

- IP64, enclosed, and damp ratings ensures a durable fixture suitable for many environments
- CCT selectability increases the versatility of this product and facilitates easier inventory management
- The four panels are adjustable up to 90 degrees allowing for customizable light
- Lasts up to 5x longer than HID lamps
- No warm-up time, instant on with full light output and stable color
- Consumes up to 76% less energy than equivalent HID lamps while delivering same light output
- Replacement for 175W-400W HID applications
- Up to 159 LPW
- 3000K, 4000K or 5000K color temperature
- CRI >80
- Offered in two wattage selectable models (60, 70 or 80W and 80, 100 or 120W)
- 117° distribution
- Energy savings up to 73%

Electrical

- 120-277V_{AC}
- Power Factor >90%
- THD <20%
- Step dimming capability when paired with optional motion/daylight sensor and remote control

Rated Life

- 50,000 hours (L₇₀)

Warranty

- 5-year
- NLB Trusted Warranty Program

Ambient Operating Range

- -40°F to +122°F (-40°C to +50°C)



Wattage Comparison

| Traditional Source | Traditional System Wattage | LED System Wattage | Energy Savings | Energy Savings Over Lamp Life |
|--------------------|----------------------------|--------------------|----------------|-------------------------------|
| HID Metal Halide | 175W | 60W | 74% | \$633 |
| HID Metal Halide | 250W | 80W | 73% | \$935 |
| HID Metal Halide | 400W | 100W | 76% | \$1650 |
| HID Metal Halide | 400W | 120W | 69% | \$1540 |

*Energy savings over life of lamp calculated at \$0.11/kWh

Certifications and Listings

- cULus
- RoHS
- FCC
- DLC Premium
- IP64

Installation

- Requires easy ballast bypass
- Lamp operates directly on line voltage, 120-277V_{AC}



Specification Data

| | |
|-------------|------|
| Catalog # | Type |
| Project | |
| Comments | |
| Prepared by | |

Ordering Guide

| LED | XXX | HIBAY | UNV | 8 | SC2 | WH | MOG |
|----------------------|---|--|--------------|---------|--|------------|------------------|
| Product Name | Wattage | Application | Voltage | CRI | Color Temperature | Finish | Base Type |
| LED = LED Technology | 80 = 60, 70 or 80 watt selectable 120 = 80, 100 or 120 watt selectable | HIBAY = Intended for High Bay Applications | UNV=120-277V | 8 = >80 | SC2 = Color Selectable 3000, 4000, or 5000K | WH = White | MOG = Mogul Base |

Wattage Selectable Range per Color Temperature

| Item Number | Wattage Selected | CCT Selectable | | | | | |
|-------------|------------------|-------------------|----------------|-------------------|----------------|-------------------|----------------|
| | | 3000K | | 4000K | | 5000K | |
| | | Total Lumens (lm) | Efficacy (LPW) | Total Lumens (lm) | Efficacy (LPW) | Total Lumens (lm) | Efficacy (LPW) |
| 41411 | 80W | 11,034 | 138 | 11,758 | 147 | 11,570 | 145 |
| | 70W | 10,119 | 145 | 10,742 | 153 | 10,633 | 152 |
| | 60W | 8975 | 150 | 9556 | 159 | 9459 | 158 |
| 41412 | 120W | 16,525 | 138 | 17,648 | 147 | 17,446 | 145 |
| | 100W | 14,794 | 148 | 15,665 | 157 | 15,572 | 156 |
| | 80W | 11,926 | 149 | 12,686 | 159 | 12,742 | 159 |

Ordering Information

| Item Number | Ordering Abbreviation | Total Wattage (W) | Input Voltage (V) | Dimming | CRI | Color Temperature | Distribution | Total Fixture Lumens (lm) | LPW | DLC |
|-------------|-------------------------|-------------------|-------------------|---------|-----|---------------------|--------------|---------------------------|-----------|---------|
| 41411 | LED80HIBAYUNV8SC2WHMOG | 60, 70 or 80 | 120-277 | 0-10V | >80 | 3000, 4000 or 5000K | 117° | up to 12,480 | up to 156 | Premium |
| 41412 | LED120HIBAYUNV8SC2WHMOG | 80, 100 or 120 | 120-277 | 0-10V | >80 | 3000, 4000 or 5000K | 117° | up to 18,240 | up to 152 | Premium |

Physical Information

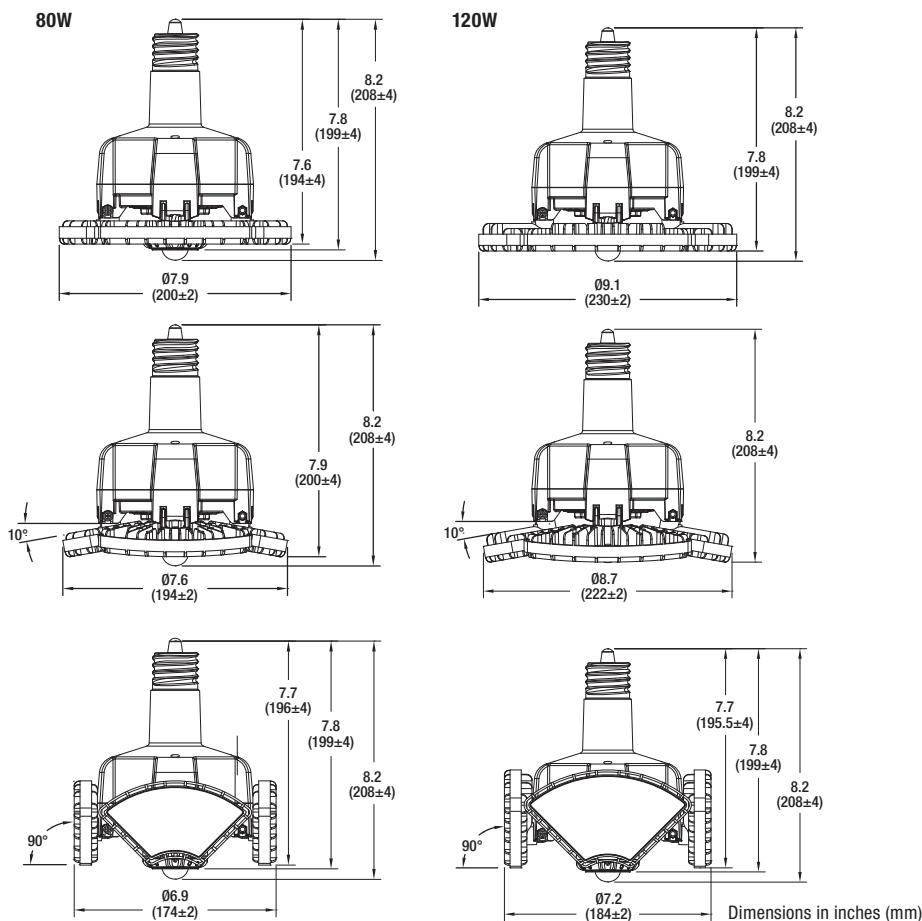

Location of CCT/Lumen Selectable Switches

41411

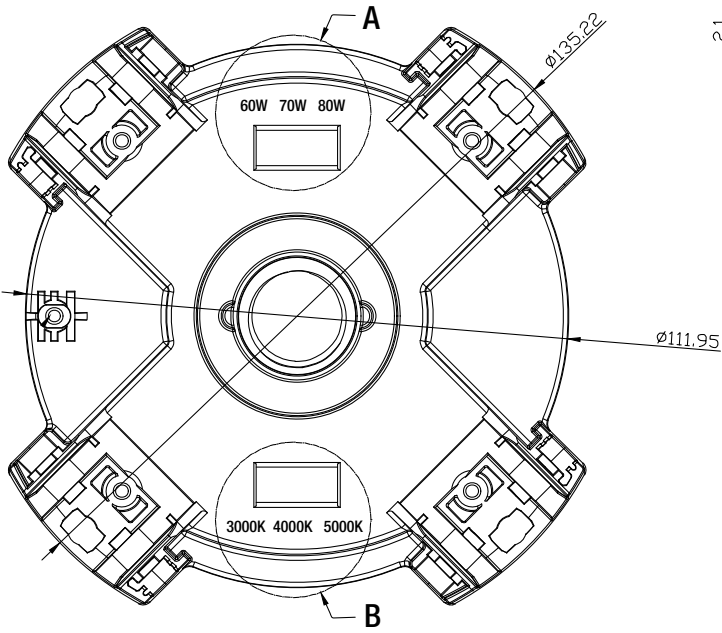

(A) Lumen Selectable Switch

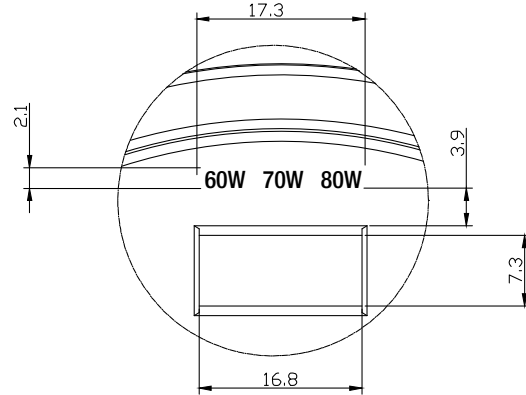

(B) CCT Selectable Switch

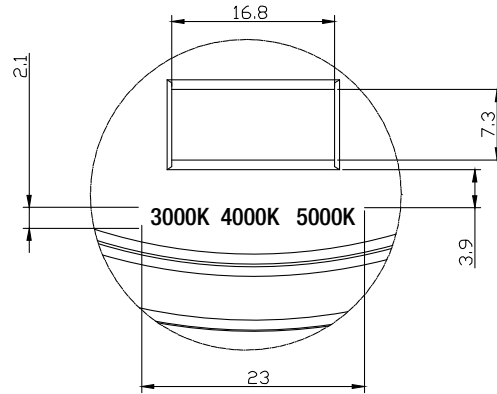

41412

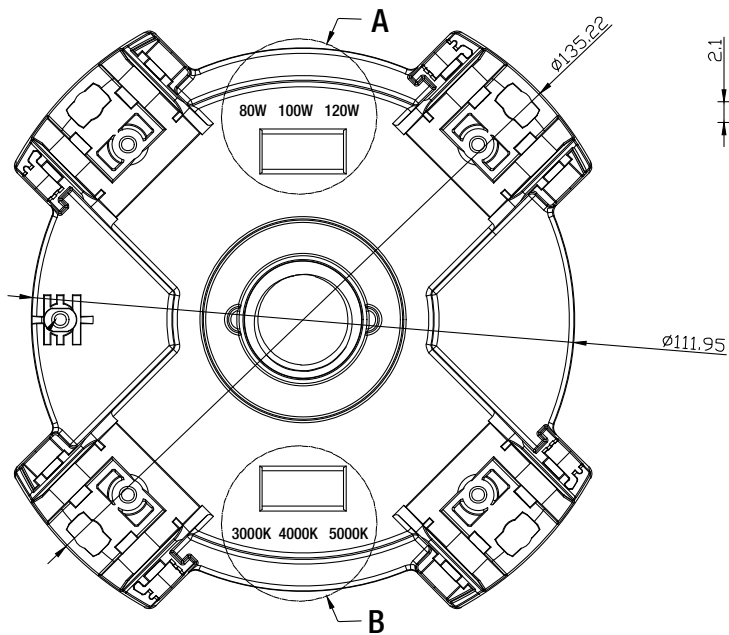

(A) Lumen Selectable Switch

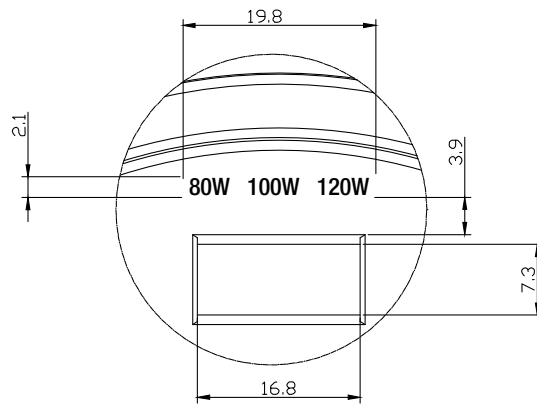

(B) CCT Selectable Switch

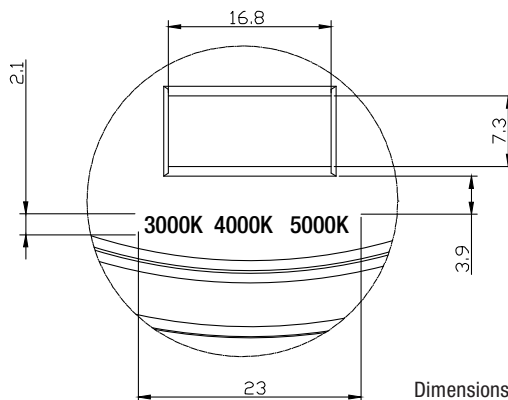

Note: all products will arrive set to default at 4000K and at 70 or 100W.

Dimensions in mm

Accessories

| Item Number | Ordering Abbreviation | Description |
|-------------|----------------------------------|--------------------------------------|
| 41146 | LED/HIDR/SENSORMICROWAVE/MOT/DAY | Microwave sensor for HIDr products |
| 41145 | LED/HIDR/REMOTE | Remote Control for sensor NAED 41146 |



*included with every 80W, 100W or 120W unit

Sensor Features

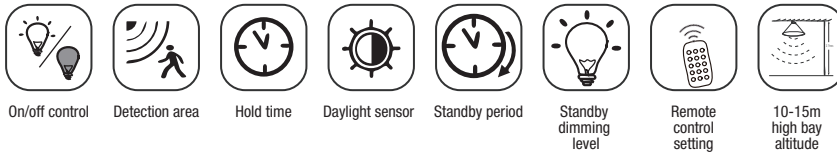

- Microwave motion & daylight sensor operating frequency: 5.8GHz (enables energy savings)
- Dual PD technology: Differentiates between artificial light brightness from natural light. Automatically turns off the light when ambient brightness exceeds present lux level.
- Plug & Play: 3 Pins, 12V, <0.5W standby power
- Detection area: Angle: 30° to 150°, Height: 49.2ft (ceiling mount)
- Superior construction: IP65 Rating
- Brightness: 70%/80%/90%/100%
- Mounting height: Max. 49.2ft (ceiling mounted)
- Detection range: \varnothing 49.2ft (ceiling mounted), Max. 65.6ft (wall mounted)
- Operating temperature: -14°F to +140°F (-25°C to +60°C)

Sensor Dimensions

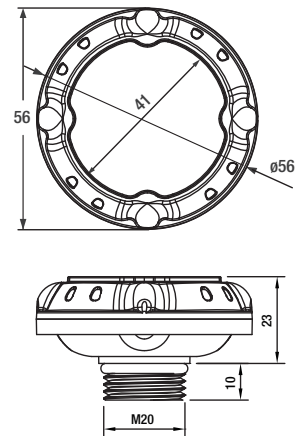

Detection Coverage*

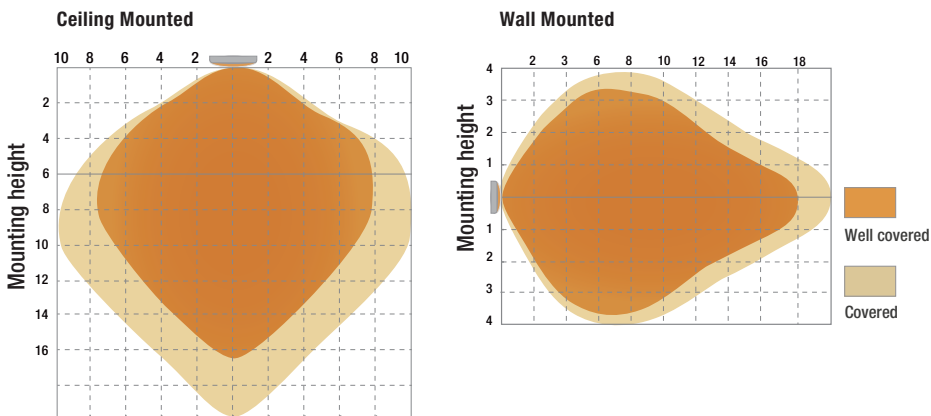

* Range listed in meters

Remote Control Features

- Enables changing settings later after initial installation
- Selection from wider options for each of following features:
 - ON/OFF
 - Detection Area
 - Sensitivity
 - Hold Time: The period for which light brightness is at 100% after moving objects leave the detection area
 - Standby Dimming Level: Low light output level in the standby period
 - Standby Period: The period for which light brightness is at low output before it's completely switched off
 - Daylight Threshold

Photometric Information

80W

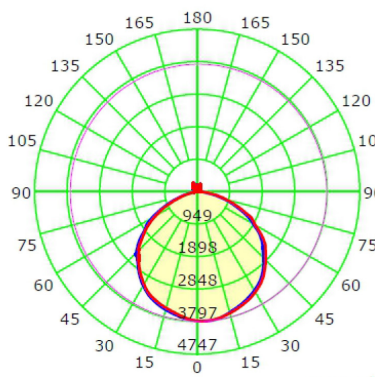

Unit: cd
Average Diffuse Angle(50%): 114.3°

— C0-C180 — C90-C270 — G5

120W

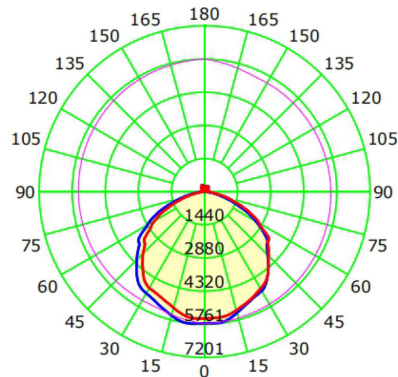

Unit: cd
Average Diffuse Angle(50%): 117.2°

— C0-C180 — C90-C270 — G7

Illuminance Information

80W

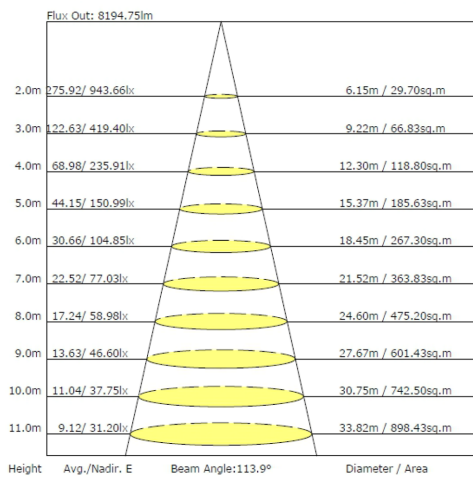

120W

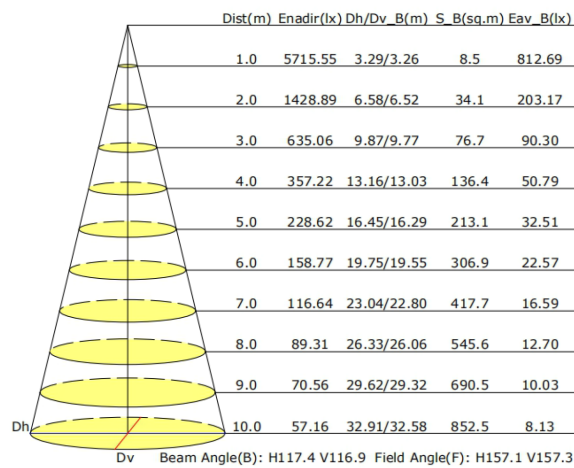

Additional Specifications

- Suitable for enclosed and open fixtures
- Suitable for damp locations
- CEC exempt

LEDVANCE LLC
200 Ballardvale Street
Wilmington, MA 01887 USA
Phone 1-800-LIGHTBULB (1-800-544-4828)
www.ledvanceUS.com

SYLVANIA and LEDVANCE are registered trademarks.
All other trademarks are those of their respective owners.
Licensee of product trademark SYLVANIA in general lighting.
Specifications subject to change without notice.

 /sylvania  /sylvania



SYLVANIA Lamps

ULTRA LED™ CCT Selectable High Bay Retrofit

Application

ULTRA LED High Bay lamps are ideal replacements for HID indoor high bay applications including retail, factory, garage, warehouse, and other industrial settings.

Benefits and Features

- IP64, enclosed, and damp ratings ensures a durable fixture suitable for many environments
- CCT selectability increases the versatility of this product and facilitates easier inventory management
- The four panels are adjustable up to 90 degrees allowing for customizable light
- Lasts up to 5x longer than HID lamps
- No warm-up time, instant on with full light output and stable color
- Consumes up to 76% less energy than equivalent HID lamps while delivering same light output
- Replacement for 175W-400W HID applications
- Up to 159 LPW
- 3000K, 4000K or 5000K color temperature
- CRI >80
- Offered in two wattage selectable models (60, 70 or 80W and 80, 100 or 120W)
- 117° distribution
- Energy savings up to 73%

Electrical

- 120-277V_{AC}
- Power Factor >90%
- THD <20%
- Step dimming capability when paired with optional motion/daylight sensor and remote control

Rated Life

- 50,000 hours (L₇₀)

Warranty

- 5-year
- NLB Trusted Warranty Program

Ambient Operating Range

- -40°F to +122°F (-40°C to +50°C)



Wattage Comparison

| Traditional Source | Traditional System Wattage | LED System Wattage | Energy Savings | Energy Savings Over Lamp Life |
|--------------------|----------------------------|--------------------|----------------|-------------------------------|
| HID Metal Halide | 175W | 60W | 74% | \$633 |
| HID Metal Halide | 250W | 80W | 73% | \$935 |
| HID Metal Halide | 400W | 100W | 76% | \$1650 |
| HID Metal Halide | 400W | 120W | 69% | \$1540 |

*Energy savings over life of lamp calculated at \$0.11/kWh

Certifications and Listings

- cULus
- RoHS
- FCC
- DLC Premium
- IP64

Installation

- Requires easy ballast bypass
- Lamp operates directly on line voltage, 120-277V_{AC}



Specification Data

| | |
|-------------|------|
| Catalog # | Type |
| Project | |
| Comments | |
| Prepared by | |

Ordering Guide

| LED | XXX | HIBAY | UNV | 8 | SC2 | WH | MOG |
|----------------------|---|--|--------------|---------|--|------------|------------------|
| Product Name | Wattage | Application | Voltage | CRI | Color Temperature | Finish | Base Type |
| LED = LED Technology | 80 = 60, 70 or 80 watt selectable 120 = 80, 100 or 120 watt selectable | HIBAY = Intended for High Bay Applications | UNV=120-277V | 8 = >80 | SC2 = Color Selectable 3000, 4000, or 5000K | WH = White | MOG = Mogul Base |

Wattage Selectable Range per Color Temperature

| Item Number | LED Part Number | Wattage Selected | CCT Selectable | | | | | |
|-------------|-------------------------|------------------|-------------------|----------------|-------------------|----------------|-------------------|----------------|
| | | | 3000K | | 4000K | | 5000K | |
| | | | Total Lumens (lm) | Efficacy (LPW) | Total Lumens (lm) | Efficacy (LPW) | Total Lumens (lm) | Efficacy (LPW) |
| 41411 | LED80HIBAYUNV8SC2WHMOG | 80W | 11,034 | 138 | 11,758 | 147 | 11,570 | 145 |
| | | 70W | 10,119 | 145 | 10,742 | 153 | 10,633 | 152 |
| | | 60W | 8975 | 150 | 9556 | 159 | 9459 | 158 |
| 41412 | LED120HIBAYUNV8SC2WHMOG | 120W | 16,525 | 138 | 17,648 | 147 | 17,446 | 145 |
| | | 100W | 14,794 | 148 | 15,665 | 157 | 15,572 | 156 |
| | | 80W | 11,926 | 149 | 12,686 | 159 | 12,742 | 159 |

Ordering Information

| Item Number | Ordering Abbreviation | Total Wattage (W) | Input Voltage (V) | Dimming | CRI | Color Temperature | Distribution | Total Fixture Lumens (lm) | LPW | DLC |
|-------------|-------------------------|-------------------|-------------------|---------|-----|---------------------|--------------|---------------------------|-----------|---------|
| 41411 | LED80HIBAYUNV8SC2WHMOG | 60, 70 or 80 | 120-277 | 0-10V | >80 | 3000, 4000 or 5000K | 117° | up to 12,480 | up to 156 | Premium |
| 41412 | LED120HIBAYUNV8SC2WHMOG | 80, 100 or 120 | 120-277 | 0-10V | >80 | 3000, 4000 or 5000K | 117° | up to 18,240 | up to 152 | Premium |

Physical Information

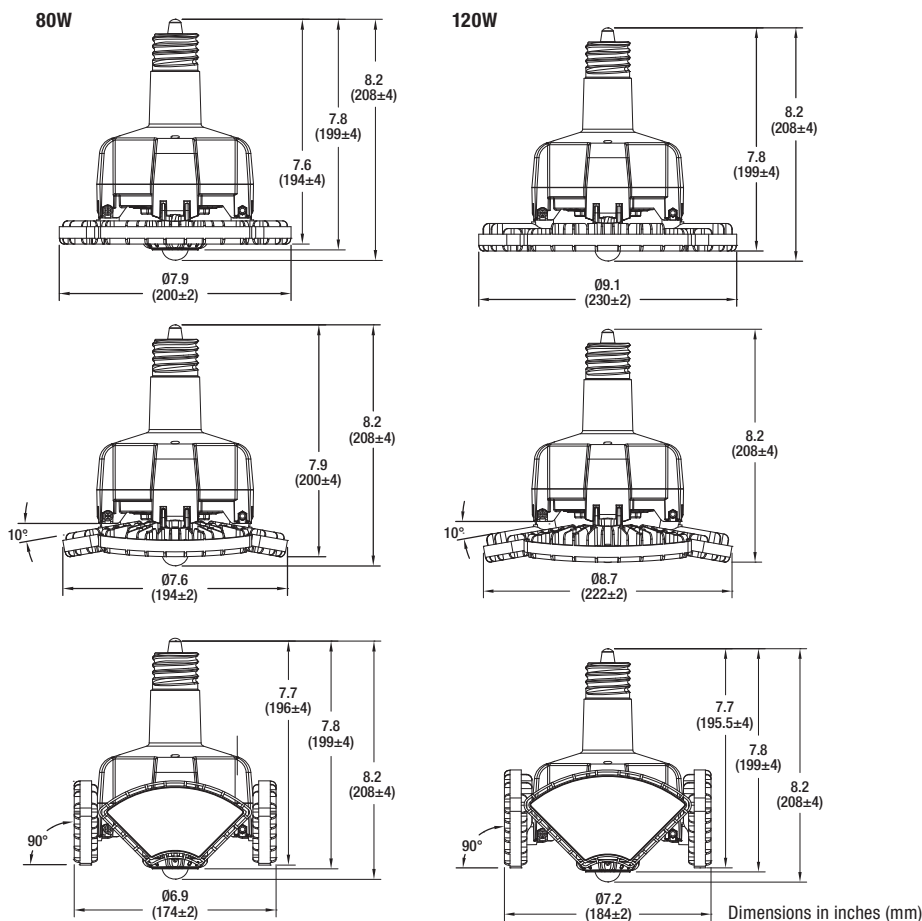

Location of CCT/Lumen Selectable Switches

41411

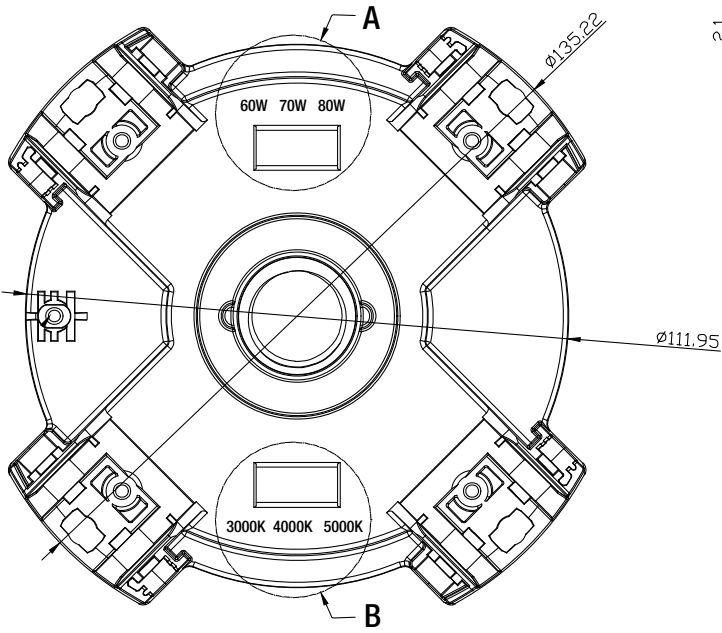

(A) Lumen Selectable Switch

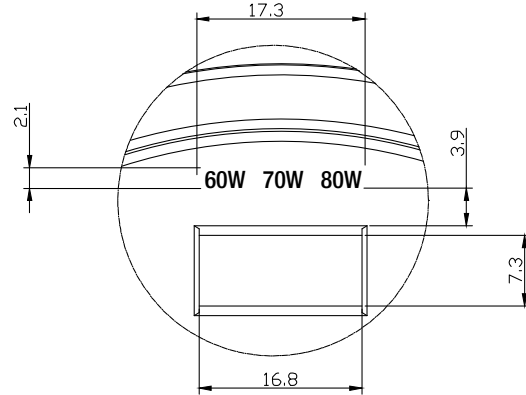

(B) CCT Selectable Switch

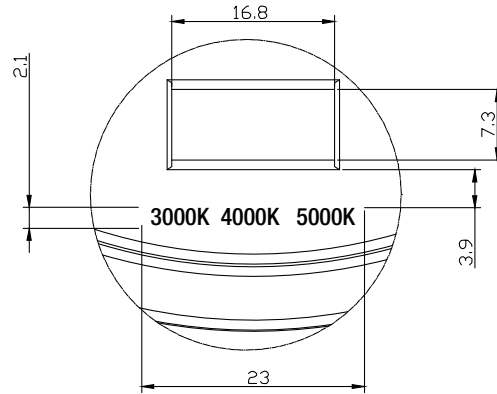

41412

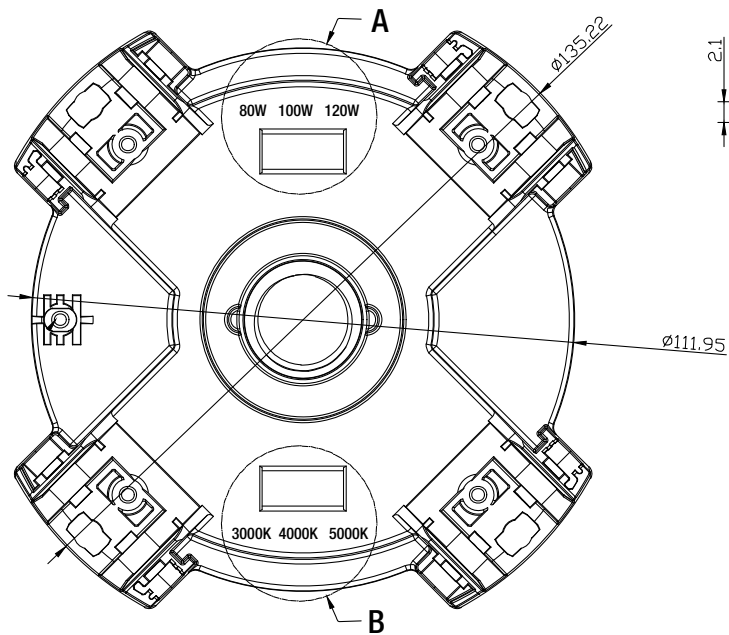

(A) Lumen Selectable Switch

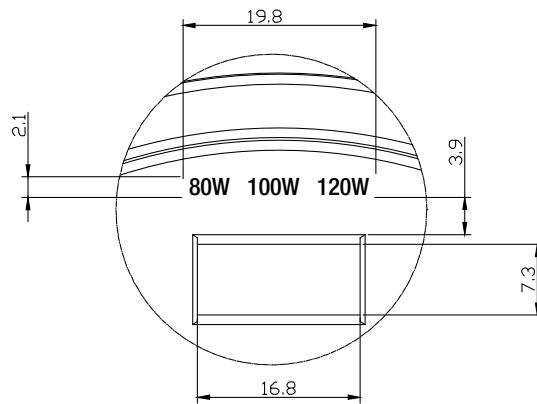

(B) CCT Selectable Switch

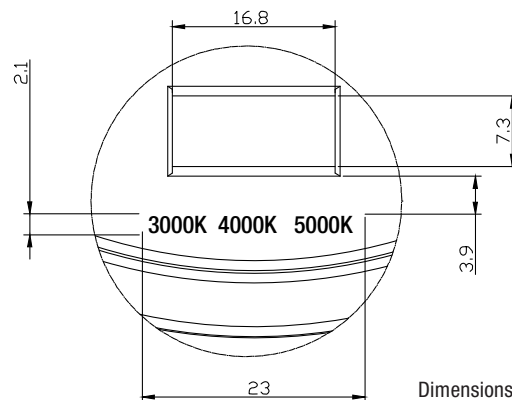

Note: all products will arrive set to default at 4000K and at 70 or 100W.

Dimensions in mm

Accessories

| Item Number | Ordering Abbreviation | Description |
|-------------|----------------------------------|--------------------------------------|
| 41146 | LED/HIDR/SENSORMICROWAVE/MOT/DAY | Microwave sensor for HIDr products |
| 41145 | LED/HIDR/REMOTE | Remote Control for sensor NAED 41146 |



*included with every 80W, 100W or 120W unit

Sensor Features

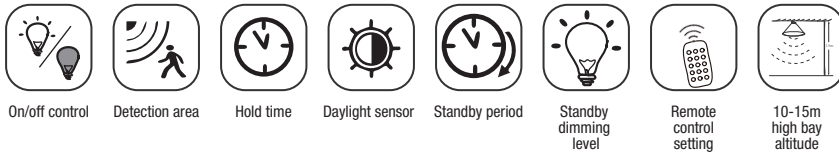

- Microwave motion & daylight sensor operating frequency: 5.8GHz (enables energy savings)
- Dual PD technology: Differentiates between artificial light brightness from natural light. Automatically turns off the light when ambient brightness exceeds present lux level.
- Plug & Play: 3 Pins, 12V, <0.5W standby power
- Detection area: Angle: 30° to 150°, Height: 49.2ft (ceiling mount)
- Superior construction: IP65 Rating
- Brightness: 70%/80%/90%/100%
- Mounting height: Max. 49.2ft (ceiling mounted)
- Detection range: \varnothing 49.2ft (ceiling mounted), Max. 65.6ft (wall mounted)
- Operating temperature: -14°F to +140°F (-25°C to +60°C)

Sensor Dimensions

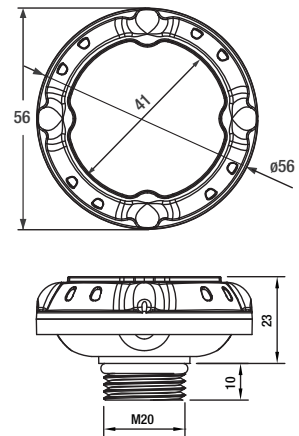

Detection Coverage*

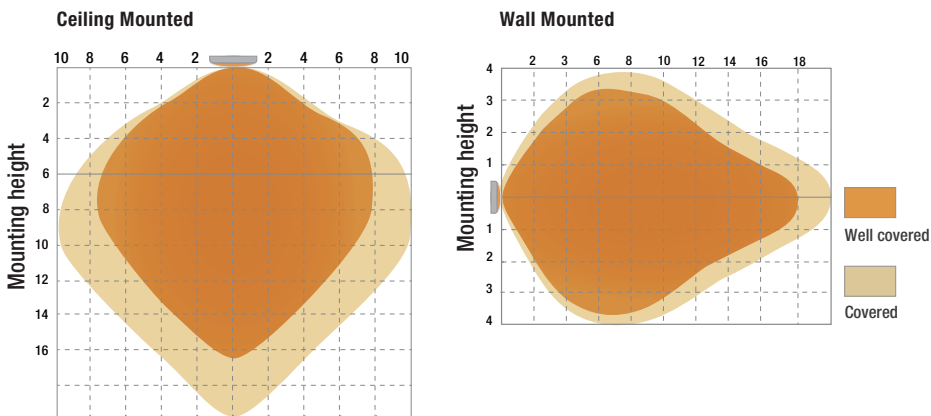

* Range listed in meters

Remote Control Features

- Enables changing settings later after initial installation
- Selection from wider options for each of following features:
 - ON/OFF
 - Detection Area
 - Sensitivity
 - Hold Time: The period for which light brightness is at 100% after moving objects leave the detection area
 - Standby Dimming Level: Low light output level in the standby period
 - Standby Period: The period for which light brightness is at low output before it's completely switched off
 - Daylight Threshold

Photometric Information

80W

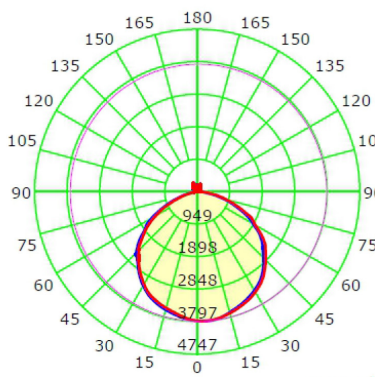

Unit: cd
Average Diffuse Angle(50%): 114.3°
— C0-C180 — C90-C270 — G5

120W

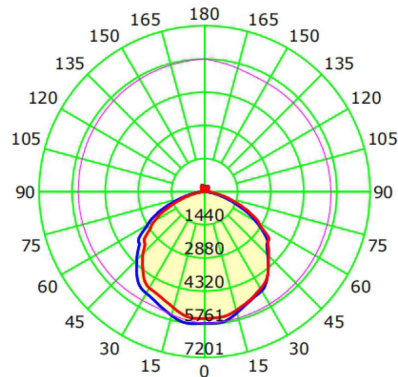

Unit: cd
Average Diffuse Angle(50%): 117.2°
— C0-C180 — C90-C270 — G7

Illuminance Information

80W

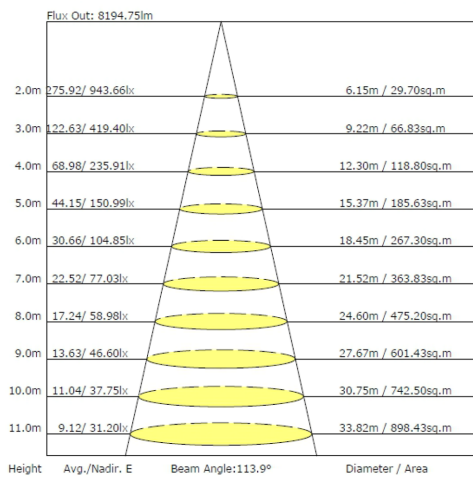

120W

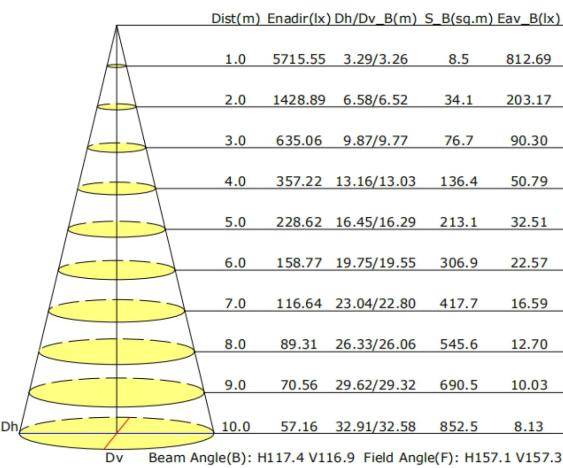

Additional Specifications

- Suitable for enclosed and open fixtures
- Suitable for damp locations
- CEC exempt

LEDVANCE LLC
200 Ballardvale Street
Wilmington, MA 01887 USA
Phone 1-800-LIGHTBULB (1-800-544-4828)
www.ledvanceUS.com

SYLVANIA and LEDVANCE are registered trademarks.
All other trademarks are those of their respective owners.
Licensee of product trademark SYLVANIA in general lighting.
Specifications subject to change without notice.

 /sylvania  /sylvania

