

SNAP²IT[®] Duplex Connectors



3838AST



For EASIER
MC/AC Installations see
383810AST to 404010AST
(above)

Zinc die-cast. For AC • MCI-A • HCF steel and aluminum cable • Flexible metal conduit steel and aluminum (regular and reduced wall) • MCI cable • Continuous corrugated aluminum • AC90. SNAP-TITE[®] and SNAP2IT[®] products have been tested and listed by UL in accordance with UL's ground fault requirements. For additional information see page 7.

| CATALOG NUMBER | UPC/DCI/NAED MFG #018997 | TRADE SIZE | KO SIZE | UNIT PKG | STD PKG | DIM A | DIM B | DIM C | DIM D | CABLE RANGE |
|----------------|--------------------------|------------|---------|----------|---------|-------|-------|-------|-------|-----------------|
| 3838ST | 10935 | 3/8 | 1/2 | 25 | 100 | 1.912 | 1.738 | .970 | .620 | (2) .405 - .612 |
| 3838A | 36200 | 3/8 | 1/2 | 25 | 100 | 1.772 | 1.738 | .840 | .620 | (2) .405 - 6.12 |
| 3838AST* | 36230 | 3/8 | 1/2 | 25 | 100 | 1.772 | 1.605 | .840 | .620 | (2) .405 - .612 |
| 4040AST* | 40351 | 3/8 | 1/2 | 25 | 100 | 1.772 | 1.605 | .840 | .620 | (2) .485 - .612 |
| 4040A | 40350 | 3/8 | 1/2 | 25 | 100 | 1.772 | 1.605 | .840 | .620 | (2) .485 - .612 |

*Provided with insulated throat.

Provided with insulated throat and red tinted inside clip. See comparison on page E-1.

Refer to chart on page E-27 for a list of cable types.

See page E-30 and E-31 for MCI-A cable ranges.

Concrete tight when taped.

PATENTED.

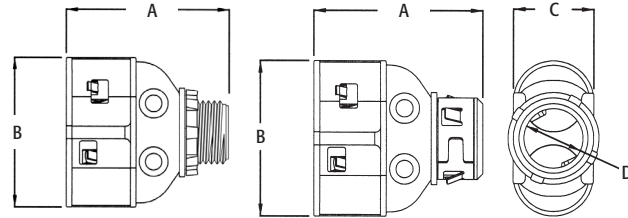

SNAP²IT[®] Duplex Connectors



3838AST



For EASIER
MC/AC Installations see
383810AST to 404010AST
(above)

Zinc die-cast. For AC • MCI-A • HCF steel and aluminum cable • Flexible metal conduit steel and aluminum (regular and reduced wall) • MCI cable • Continuous corrugated aluminum • AC90. SNAP-TITE[®] and SNAP2IT[®] products have been tested and listed by UL in accordance with UL's ground fault requirements. For additional information see page 7.

| CATALOG NUMBER | UPC/DCI/NAED MFG #018997 | TRADE SIZE | KO SIZE | UNIT PKG | STD PKG | DIM A | DIM B | DIM C | DIM D | CABLE RANGE |
|----------------|--------------------------|------------|---------|----------|---------|-------|-------|-------|-------|-----------------|
| 3838ST | 10935 | 3/8 | 1/2 | 25 | 100 | 1.912 | 1.738 | .970 | .620 | (2) .405 - .612 |
| 3838A | 36200 | 3/8 | 1/2 | 25 | 100 | 1.772 | 1.738 | .840 | .620 | (2) .405 - 6.12 |
| 3838AST* | 36230 | 3/8 | 1/2 | 25 | 100 | 1.772 | 1.605 | .840 | .620 | (2) .405 - .612 |
| 4040AST* | 40351 | 3/8 | 1/2 | 25 | 100 | 1.772 | 1.605 | .840 | .620 | (2) .485 - .612 |
| 4040A | 40350 | 3/8 | 1/2 | 25 | 100 | 1.772 | 1.605 | .840 | .620 | (2) .485 - .612 |

*Provided with insulated throat.

Provided with insulated throat and red tinted inside clip. See comparison on page E-1.

Refer to chart on page E-27 for a list of cable types.

See page E-30 and E-31 for MCI-A cable ranges.

Concrete tight when taped.

PATENTED.

