



Catalog Number: 363612-CT3R  
Item Description: CT3R HINGED PADLCKBL ENCL  
UPC Code: 784572161856

Brand Name: Milbank  
Type: Hinge Cover  
Special Features: Double Door  
Application: Current Transformer Enclosure  
Standard: UL Listed  
Material: Steel with Powder Coat Finish  
Cable Entry: No Knockouts  
Mounting: Pad Mount, Wall Mount  
NEMA Rating: Type 3R



*Utility requirements may vary. Always consult the serving utility for their requirements prior to ordering or installing this equipment. This product must always be installed by a licensed electrician. Installation of this equipment may require local electrical inspector approval.*

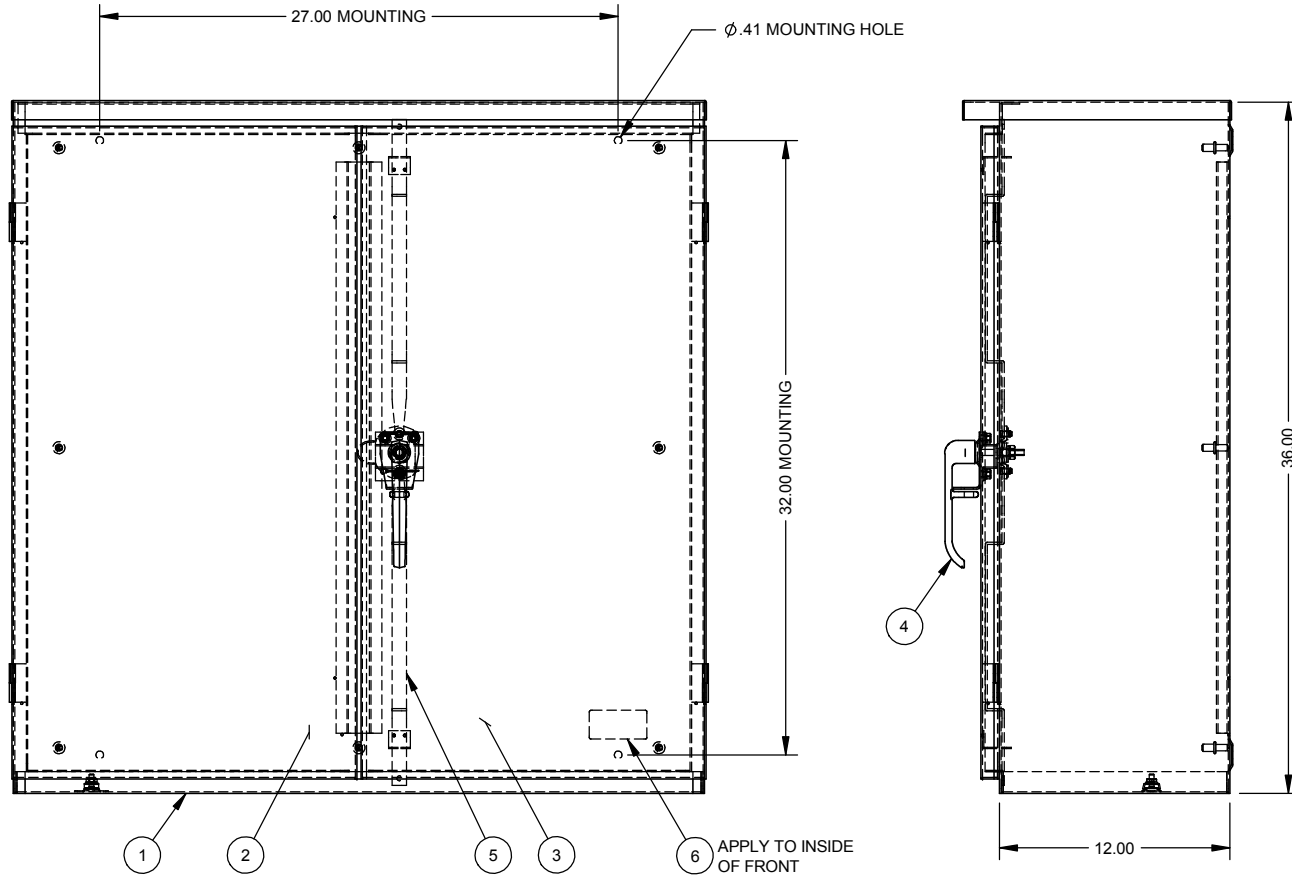

| NO. | QTY. | PART NO. | DESCRIPTION               |
|-----|------|----------|---------------------------|
| 1   | 1    | 1138438  | BACK WELDMENT             |
| 2   | 1    | 1004553  | FRONT WELDMENT, LEFT      |
| 3   | 1    | 1004554  | FRONT WELDMENT, RIGHT     |
| 4   | 1    | 1004575  | ASSY, 3PT LATCH, PADLCKBL |
| 5   | 2    | 1002051  | LATCH SLIDE               |
| 6   | 1    | 1003115  | LABEL (UL)                |
| 7   | 2    | 1002169  | BAG ASSY (NOT SHOWN)      |
| 8   | 1    | 1003466  | CARTON 1-PER (NOT SHOWN)  |

- NOTE:
- 1) PACK INSIDE ENCLOSURE (NOT SHOWN)
  2. FOR CATALOG NUMBER WITH -PI SUFFIX INSTALL 1096550 USING BAG ASSEMBLY(S) IN B.O.M.
  3. FOR CATALOG NUMBER WITH -WB SUFFIX INSTALL 1002359 USING BAG ASSEMBLY(S) IN B.O.M.
  4. WHEN SOLD AS (RC)- PREFIX USE LABEL #1125021 INSTEAD OF #1003115.
  5. SHIP ON 48" PALLET, 3 UNITS PER PALLET.

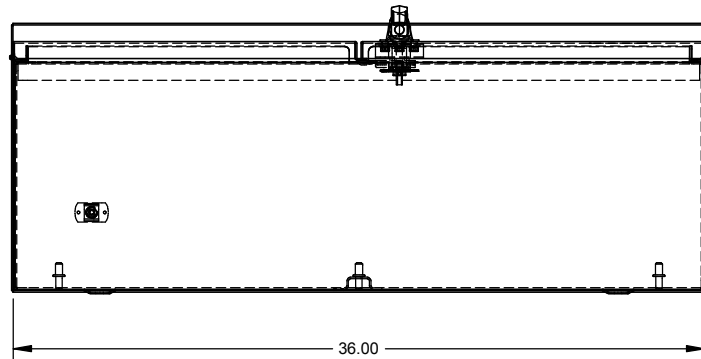

| CAT#           | MATERIAL      | FINISH       |
|----------------|---------------|--------------|
| 363612-CT3R    | GALVANIZED    | ANSI 61 GRAY |
| 363612-CT3R-PI | GALVANIZED    | ANSI 61 GRAY |
| 363612-CT3R-WB | GALVANIZED    | ANSI 61 GRAY |
| 363612-CT3RXS  | 304 STAINLESS | GRAINED      |

|  |           |   |     |    |          |                            |      |           |     |              |  |       |          |       |        |
|--|-----------|---|-----|----|----------|----------------------------|------|-----------|-----|--------------|--|-------|----------|-------|--------|
| Material:  | SEE CHART | <p>General Offices:<br/>Kansas City, MO</p>                   |     |    |          |                            |      |           |     |              |  |       |          |       |        |
| Finish:  | SEE CHART |   |     |    |          |                            |      |           |     |              |  |       |          |       |        |
| <p>Tolerances:<br/>Unless Specified Otherwise<br/>X.X ±.1<br/>X.XX ±.03<br/>X.XXX ±.015<br/>X" ±2°</p> |           | <p>Title: 36 x 36 x 12, 2 DOOR<br/>TYPE 3R, FREE STANDING</p> |     |    |          |                            |      |           |     |              |  |       |          |       |        |
| <p>Third Angle<br/>Projection</p>  |           | <p>Catalog No.: SEE CHART</p>                                 |     |    |          |                            |      |           |     |              |  |       |          |       |        |
|  |           | <p>Customer: MILBANK STANDARD</p>                             |     |    |          |                            |      |           |     |              |  |       |          |       |        |
|  |           | <p>Drawing No.: <b>1001905</b></p>                            |     |    |          |                            |      |           |     |              |  |       |          |       |        |
| K  | 12/05/14  | CHNG'D CARTON (eECR0030019)                                   | AJS | J2 | 5/7/09   | UPDATE TO M2K (ECO #18252) | D.F. | Scale:    | NTS | Checked By:  |  | Date: | 10/22/02 | Sheet | 1 of 1 |
| J1   | 8-22-06   | mECO #15092, ADDED NOTE #4.                                   | CMW | J3 | 10/20/11 | ADD NOTE 5 (ECO #21474)    | D.F. | Drawn By: | MR  | Approved By: |  |       |          |       |        |

NEMA DWG.: #784



Catalog Number: 363612-CT3R  
Item Description: CT3R HINGED PADLCKBL ENCL  
UPC Code: 784572161856

Brand Name: Milbank  
Type: Hinge Cover  
Special Features: Double Door  
Application: Current Transformer Enclosure  
Standard: UL Listed  
Material: Steel with Powder Coat Finish  
Cable Entry: No Knockouts  
Mounting: Pad Mount, Wall Mount  
NEMA Rating: Type 3R



*Utility requirements may vary. Always consult the serving utility for their requirements prior to ordering or installing this equipment. This product must always be installed by a licensed electrician. Installation of this equipment may require local electrical inspector approval.*

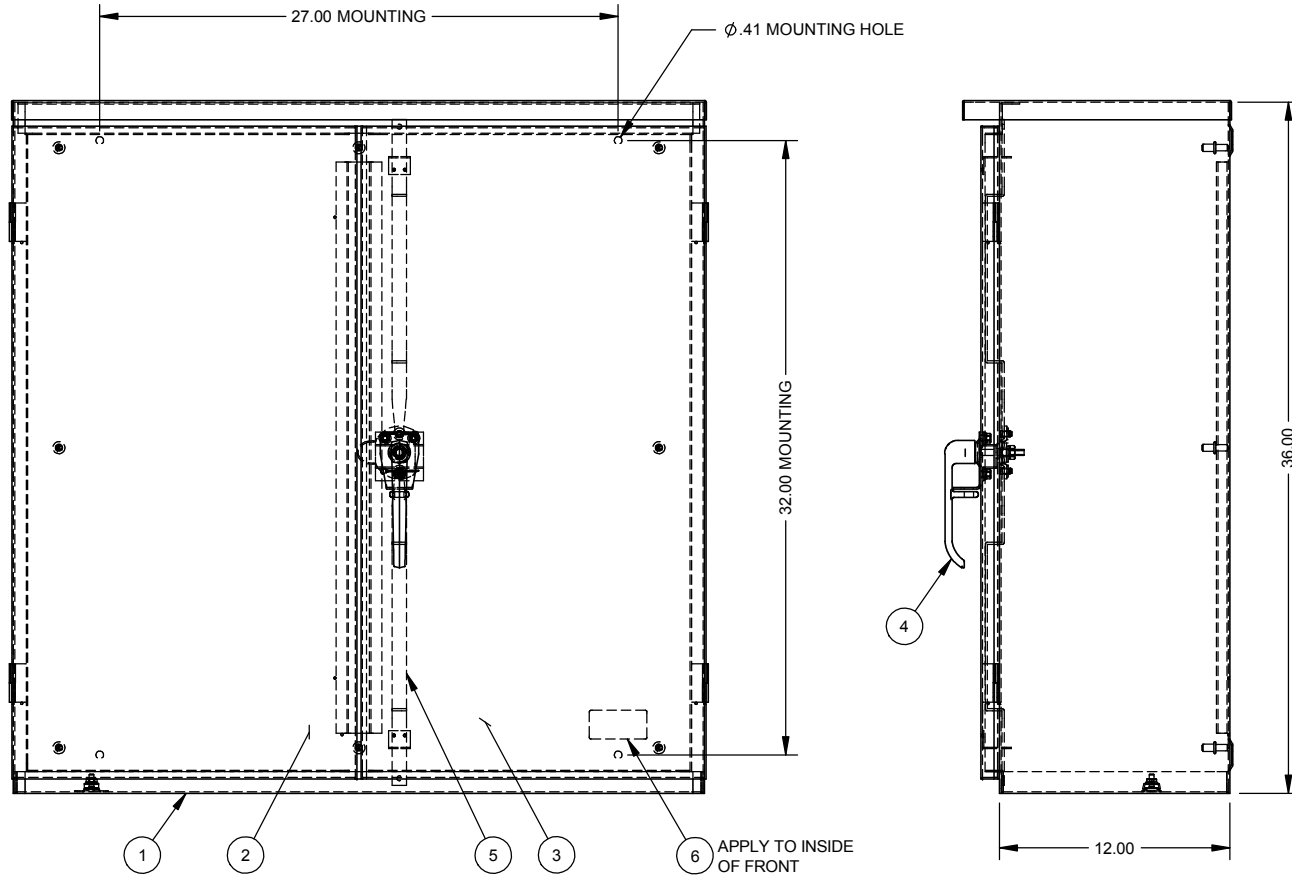

| NO. | QTY. | PART NO. | DESCRIPTION               |
|-----|------|----------|---------------------------|
| 1   | 1    | 1138438  | BACK WELDMENT             |
| 2   | 1    | 1004553  | FRONT WELDMENT, LEFT      |
| 3   | 1    | 1004554  | FRONT WELDMENT, RIGHT     |
| 4   | 1    | 1004575  | ASSY, 3PT LATCH, PADLCKBL |
| 5   | 2    | 1002051  | LATCH SLIDE               |
| 6   | 1    | 1003115  | LABEL (UL)                |
| 7   | 2    | 1002169  | BAG ASSY (NOT SHOWN)      |
| 8   | 1    | 1003466  | CARTON 1-PER (NOT SHOWN)  |

- NOTE:
- 1) PACK INSIDE ENCLOSURE (NOT SHOWN)
  2. FOR CATALOG NUMBER WITH -PI SUFFIX INSTALL 1096550 USING BAG ASSEMBLY(S) IN B.O.M.
  3. FOR CATALOG NUMBER WITH -WB SUFFIX INSTALL 1002359 USING BAG ASSEMBLY(S) IN B.O.M.
  4. WHEN SOLD AS (RC)- PREFIX USE LABEL #1125021 INSTEAD OF #1003115.
  5. SHIP ON 48" PALLET, 3 UNITS PER PALLET.

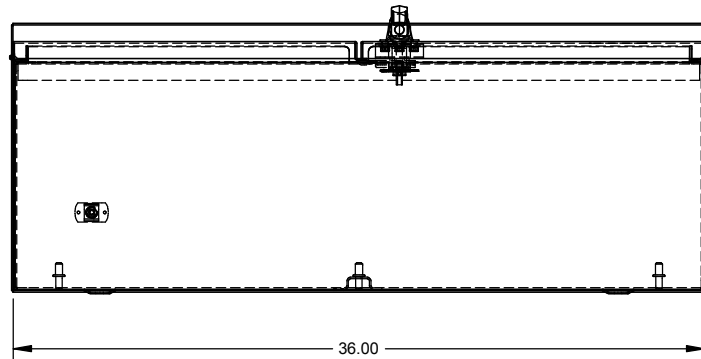

| CAT#           | MATERIAL      | FINISH       |
|----------------|---------------|--------------|
| 363612-CT3R    | GALVANIZED    | ANSI 61 GRAY |
| 363612-CT3R-PI | GALVANIZED    | ANSI 61 GRAY |
| 363612-CT3R-WB | GALVANIZED    | ANSI 61 GRAY |
| 363612-CT3RXS  | 304 STAINLESS | GRAINED      |

|  |              |   |
|--|--------------|---|
| Material:  | SEE CHART    | <p>General Offices:<br/>Kansas City, MO</p>           |
| Finish:  | SEE CHART    |   |
| <p>Tolerances:<br/>Unless Specified Otherwise<br/>X.X ±.1<br/>X.XX ±.03<br/>X.XXX ±.015<br/>X" ±2"</p> |              | Title: 36 x 36 x 12, 2 DOOR<br>TYPE 3R, FREE STANDING |
| <p>Third Angle<br/>Projection</p>  |              | Catalog No.: SEE CHART                                |
|  |              | Customer: MILBANK STANDARD                            |
|  |              | Drawing No.: <b>1001905</b>                           |
| Scale: NTS   | Checked By:  | Date: 10/22/02  |
| Drawn By: MR   | Approved By: | Sheet 1 of 1  |

NEMA DWG.: #784

|    |          |                             |     |    |          |                            |      |           |     |              |  |              |                |
|----|----------|-----------------------------|-----|----|----------|----------------------------|------|-----------|-----|--------------|--|--------------|----------------|
| K  | 12/05/14 | CHNG'D CARTON (eECR0030019) | AJS | J2 | 5/7/09   | UPDATE TO M2K (ECO #18252) | D.F. | Scale:    | NTS | Checked By:  |  | Drawing No.: | <b>1001905</b> |
| J1 | 8-22-06  | mECO #15092, ADDED NOTE #4. | CMW | J3 | 10/20/11 | ADD NOTE 5 (ECO #21474)    | D.F. | Drawn By: | MR  | Approved By: |  | Date:        | 10/22/02       |