

Iberville® FS and FD metallic covers

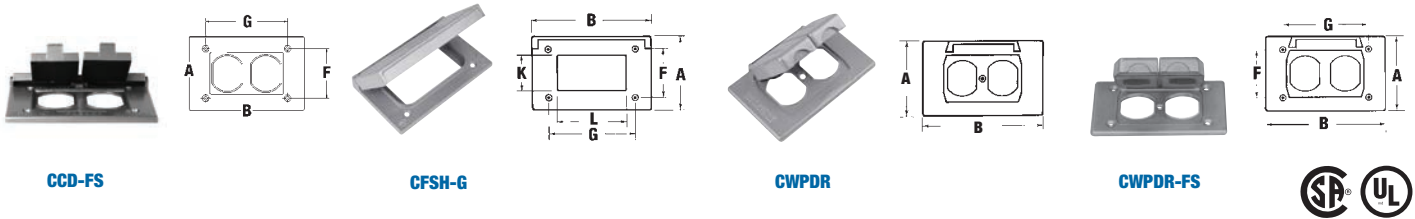

Cat. No.	Description	A (in.)	B (in.)	F (in.)	G (in.)	K (in.)	L (in.)
Single Gang Horizontal Covers (Cast Aluminum)							
CCD-FS	Silver – box mount (zinc)	2-13/16	4-9/16	1-7/8	3-1/4	–	–
CFSH-G	One GFCI receptacle – box mount	2-13/16	4-9/16	1-7/8	3-1/4	1-11/32	2-21/32
CWPDR	One duplex receptacle – device mount	2-13/16	4-9/16	–	–	–	–
CWPDR-FS	One duplex receptacle – box mount	2-13/16	4-9/16	1-7/8	3-1/4	–	–

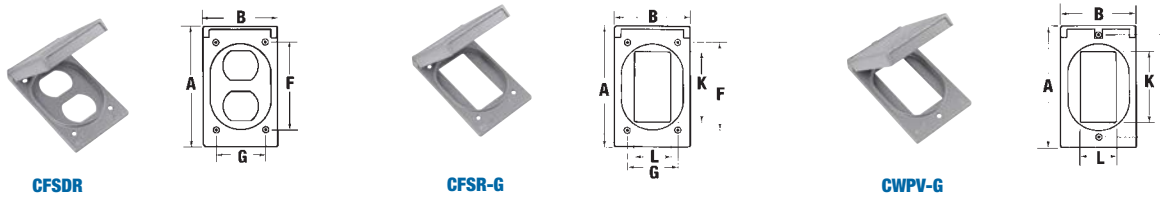

Cat. No.	Description	A (in.)	B (in.)	F (in.)	G (in.)	K (in.)	L (in.)
Single Gang Vertical Covers (Cast Aluminum)							
CFSDR	One duplex receptacle – box mount	4-9/16	2-13/16	3-1/4	1-7/8	–	–
CFSR-G	One GFCI receptacle – box mount	4-9/16	2-13/16	3-1/4	1-7/8	2-21/32	1-11/32
CWPV-G	One GFCI receptacle – device mount	4-9/16	2-13/16	3-1/4	–	2-21/32	1-11/32

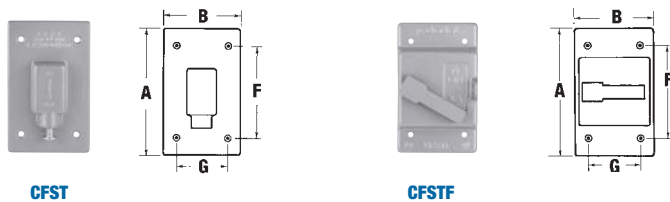

Cat. No.	Description	A (in.)	B (in.)	F (in.)	G (in.)
Single Gang Switch Covers (Cast Aluminum)					
CFST	One plunger – box mount	4-9/16	2-13/16	3-1/4	1-7/8
CFSTF	One lever switch – box mount	4-9/16	2-13/16	3-1/4	1-7/8

Iberville® FS and FD metallic covers



**CCB / CCB-AL /
DCCB-AL**

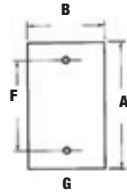

CCB-FS



CFSB

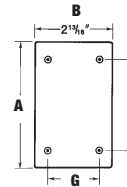

CIFS-100G



Cat. No.	Description	A (in.)	B (in.)	F (in.)	G (in.)
Single Gang Blank Covers (Cast Aluminum)					
CCB	Silver – device mount (grey paint)	4-9/16	2-13/16	3-9/32	–
CCB-FS	Silver – box mount (grey paint)	4-9/16	2-13/16	3-1/4	1-7/8
CFSB	Blank – box mount	4-9/16	2-13/16	3-1/4	1-7/8
CIFS-100G	Blank – box mount (gasket glued on cover)	4-3/8	2-14/16	3-1/4	1-7/8
CCB-AL	Blank – box mount (stamped aluminum)	4-8/16	2-13/16	3-9/32	–
DCCB-AL	Blank – box mount (stamped aluminum) Propack	4-8/16	2-13/16	3-9/32	–



CFSR Series*

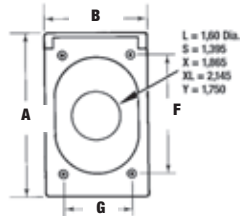

Cat. No.	Description	Nominal Size (in.)	Max. Device Face Dia.	A (in.)	B (in.)	F (in.)	G (in.)
Single Gang Vertical Covers (Cast Aluminum)							
CFSR-L	Single receptacle – box mount	1-9/16	1.600	4-9/16	2-13/16	3-1/4	1-7/8
CFSR-S	Single receptacle – box mount	1-3/8	1.395	4-9/16	2-13/16	3-1/4	1-7/8
CFSR-X	Single receptacle – box mount	1-27/32	1.865	4-9/16	2-13/16	3-1/4	1-7/8
CFSR-XL	Single receptacle – box mount	2-1/8	2.145	4-9/16	2-13/16	3-1/4	1-7/8
CFSR-Y	Single receptacle – box mount	1-3/4	1.750	4-9/16	2-13/16	3-1/4	1-7/8

*Gasket and screws included.

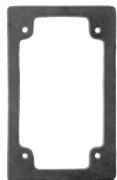

FS-GKV

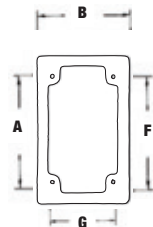

Cat. No.	Description	A (in.)	B (in.)	F (in.)	G (in.)
Single Gang Gasket					
FS-GKV	Single Gang – box mount – gasket	4-9/16	2-13/16	3-1/4	1-7/8

Iberville® FS and FD metallic covers



2CWPR-M

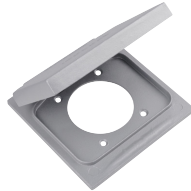
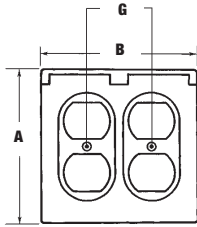

2CFSR-M

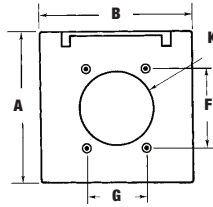

2CFST

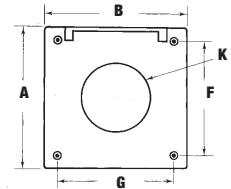

2CCB

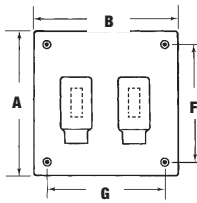

2CFSB

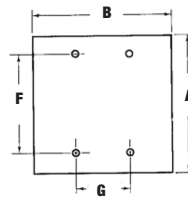

2CFSB

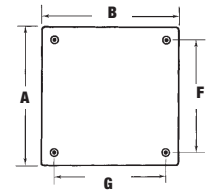

Cat. No.	Description	A (in.)	B (in.)	F (in.)	G (in.)	K (in.)
Two Gang (Cast Aluminum)						
2CWPR-M	Two duplex receptacles – device mount	4-9/16	4-5/8	–	1-13/16	–
2CFSR-M	Single receptacle – hole – device mount	4-9/16	4-5/8	2-3/8	1-13/16	2-1/4
2CFSR-M	Single receptacle – hole – box mount	4-9/16	4-5/8	3-3/4	3-3/4	2-1/4
2CFST	Plunger style cover	4-9/16	4-5/8	3-3/4	3-3/4	–
2CCB	Silver – device mount (grey paint)	4-9/16	4-5/8	3-9/32	1-13/16	–
2CCB-AL	Blank cover – box mount (stamped aluminum)	4-9/16	4-5/8	3-9/32	5-5/8	–
2CFSB	Blank cover – box mount	4-9/16	4-5/8	3-3/4	3-3/4	–

Iberville® FS and FD metallic covers



CDR

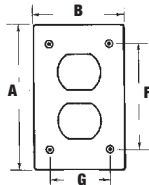

CTS

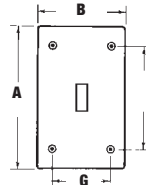

Cat. No.	Description	A (in.)	B (in.)	F (in.)	G (in.)
Single Gang (Cast Aluminum)					
CDR	One duplex receptacle – box mount	4-9/16	2-13/16	3-1/4	1-7/8
CTS	One switch receptacle – box mount	4-9/16	2-13/16	3-1/4	1-7/8



CIFS-4

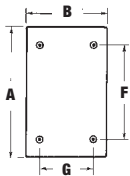

CIFS-7 / CIFS-5



CIFS-6

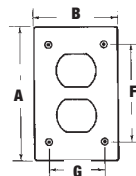

CIFS-9



CIFS-9-HV

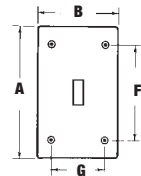

Cat. No.	Description	A (in.)	B (in.)	F (in.)	G (in.)	K (in.)
Single Gang FS Covers (Stamped Aluminum)						
CIFS-4	Blank – single gang – box mount	4-9/16	2-13/16	3-1/4	1-7/8	–
CIFS-5	15 A single receptacle – box mount	4-9/16	2-13/16	3-1/4	1-7/8	1-13/16
CIFS-6	One duplex receptacle – box mount	4-9/16	2-13/16	3-1/4	1-7/8	–
CIFS-7	20 A single locking receptacle – box mount	4-9/16	2-13/16	3-1/4	1-7/8	1-19/32
CIFS-9	One toggle switch – box mount	4-9/16	2-13/16	3-1/4	1-7/8	–
CIFS-9-HV	One toggle switch (347 V) – box mount	4-9/16	2-13/16	3-1/4	1-7/8	–



CRL

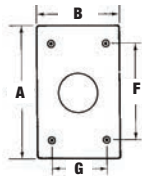

Cat. No.	Description	Nominal Size (in.)	Max. Device Face Dia.	A (in.)	B (in.)	F (in.)	G (in.)
Single Gang (Cast Aluminum)							
CRL	Single receptacle – box mount	1-9/16	1,600	4-9/16	2-13/16	3-1/4	1-7/8
CRS	Single receptacle – box mount	1-3/8	1,395	4-9/16	2-13/16	3-1/4	1-7/8

Covers are approved for dry locations only

Iberville® FS and FD metallic covers

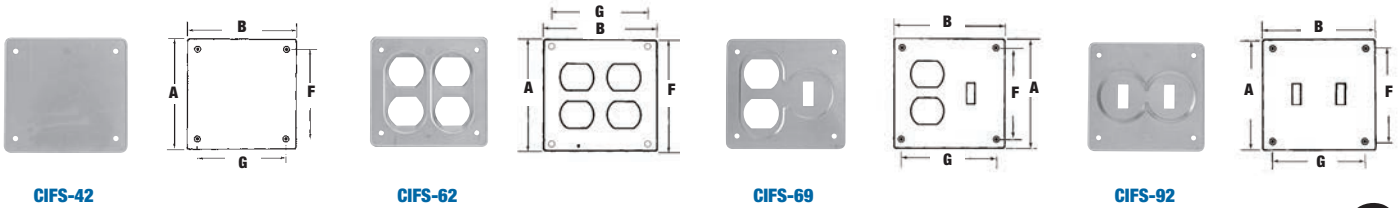

Cat. No.	Description	A (in.)	B (in.)	F (in.)	G (in.)
Two gang FS Covers* (Stamped Aluminum)					
CIFS-42*	Blank – two gang – box mount	4-5/8	4-9/16	3-1/4	3-11/16
CIFS-62*	Two duplex receptacles – box mount	4-5/8	4-9/16	3-1/4	3-11/16
CIFS-69*	One duplex receptacles, one toggle switch – box mount	4-5/8	4-9/16	3-1/4	3-11/16
CIFS-92*	Two toggle switches – box mount	4-5/8	4-9/16	3-1/4	3-11/16

* CIFS covers are CSA approved only

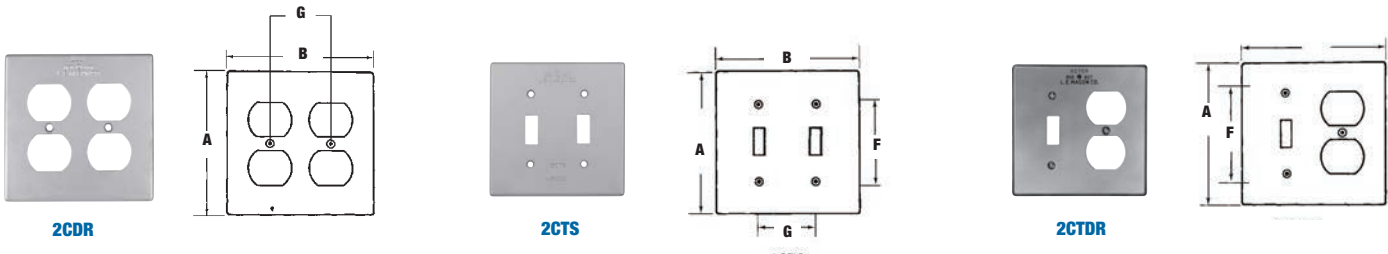

Cat. No.	Description	A (in.)	B (in.)	F (in.)	G (in.)
Two Gang (Cast Aluminum)					
2CDR	Two duplex receptacles – device mount	4-9/16	4-5/8	–	1-13/16
2CTS	Two switch – device mount	4-9/16	4-5/8	2-3/8	1-13/16
2CTDR	One switch and one duplex receptacle – device mount	4-9/16	4-5/8	2-3/8	–

Covers are approved for dry locations only

Iberville® FS and FD metallic covers

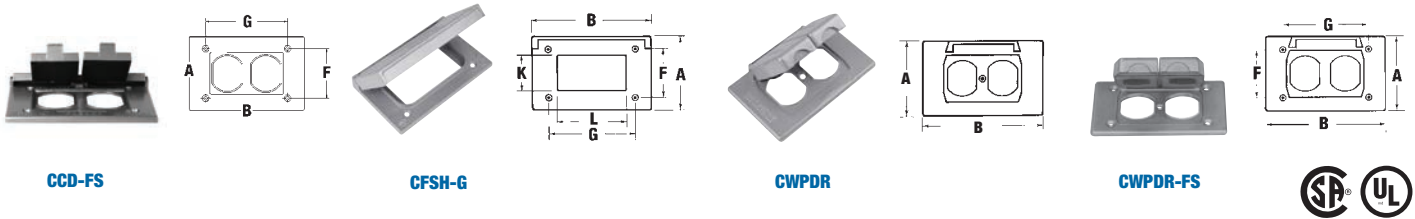

Cat. No.	Description	A (in.)	B (in.)	F (in.)	G (in.)	K (in.)	L (in.)
Single Gang Horizontal Covers (Cast Aluminum)							
CCD-FS	Silver – box mount (zinc)	2-13/16	4-9/16	1-7/8	3-1/4	–	–
CFSH-G	One GFCI receptacle – box mount	2-13/16	4-9/16	1-7/8	3-1/4	1-11/32	2-21/32
CWPDR	One duplex receptacle – device mount	2-13/16	4-9/16	–	–	–	–
CWPDR-FS	One duplex receptacle – box mount	2-13/16	4-9/16	1-7/8	3-1/4	–	–

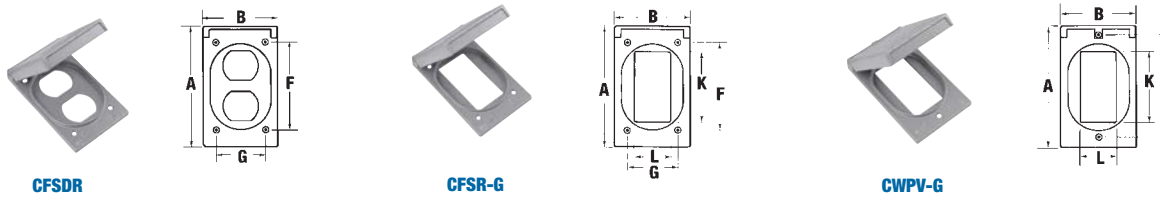

Cat. No.	Description	A (in.)	B (in.)	F (in.)	G (in.)	K (in.)	L (in.)
Single Gang Vertical Covers (Cast Aluminum)							
CFSDR	One duplex receptacle – box mount	4-9/16	2-13/16	3-1/4	1-7/8	–	–
CFSR-G	One GFCI receptacle – box mount	4-9/16	2-13/16	3-1/4	1-7/8	2-21/32	1-11/32
CWPV-G	One GFCI receptacle – device mount	4-9/16	2-13/16	3-1/4	–	2-21/32	1-11/32

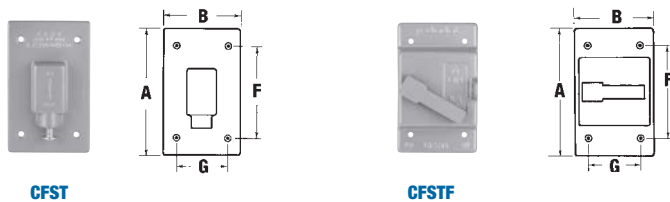

Cat. No.	Description	A (in.)	B (in.)	F (in.)	G (in.)
Single Gang Switch Covers (Cast Aluminum)					
CFST	One plunger – box mount	4-9/16	2-13/16	3-1/4	1-7/8
CFSTF	One lever switch – box mount	4-9/16	2-13/16	3-1/4	1-7/8

Iberville® FS and FD metallic covers



**CCB / CCB-AL /
DCCB-AL**

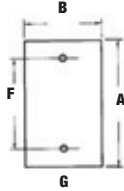

CCB-FS



CFSB

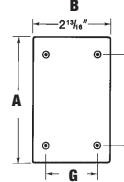

CIFS-100G



Cat. No.	Description	A (in.)	B (in.)	F (in.)	G (in.)
Single Gang Blank Covers (Cast Aluminum)					
CCB	Silver – device mount (grey paint)	4-9/16	2-13/16	3-9/32	–
CCB-FS	Silver – box mount (grey paint)	4-9/16	2-13/16	3-1/4	1-7/8
CFSB	Blank – box mount	4-9/16	2-13/16	3-1/4	1-7/8
CIFS-100G	Blank – box mount (gasket glued on cover)	4-3/8	2-14/16	3-1/4	1-7/8
CCB-AL	Blank – box mount (stamped aluminum)	4-8/16	2-13/16	3-9/32	–
DCCB-AL	Blank – box mount (stamped aluminum) Propack	4-8/16	2-13/16	3-9/32	–



CFSR Series*

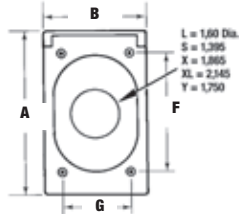

Cat. No.	Description	Nominal Size (in.)	Max. Device Face Dia.	A (in.)	B (in.)	F (in.)	G (in.)
Single Gang Vertical Covers (Cast Aluminum)							
CFSR-L	Single receptacle – box mount	1-9/16	1.600	4-9/16	2-13/16	3-1/4	1-7/8
CFSR-S	Single receptacle – box mount	1-3/8	1.395	4-9/16	2-13/16	3-1/4	1-7/8
CFSR-X	Single receptacle – box mount	1-27/32	1.865	4-9/16	2-13/16	3-1/4	1-7/8
CFSR-XL	Single receptacle – box mount	2-1/8	2.145	4-9/16	2-13/16	3-1/4	1-7/8
CFSR-Y	Single receptacle – box mount	1-3/4	1.750	4-9/16	2-13/16	3-1/4	1-7/8

*Gasket and screws included.



FS-GKV

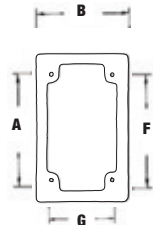

Cat. No.	Description	A (in.)	B (in.)	F (in.)	G (in.)
Single Gang Gasket					
FS-GKV	Single Gang – box mount – gasket	4-9/16	2-13/16	3-1/4	1-7/8

Iberville® FS and FD metallic covers



2CWPR-M

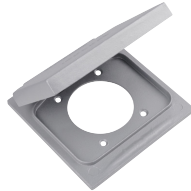
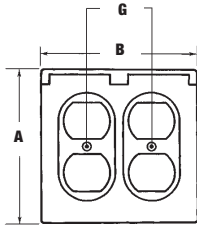

2CFSR-M

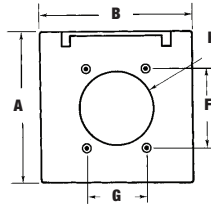

2CFST

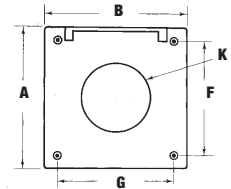

2CCB

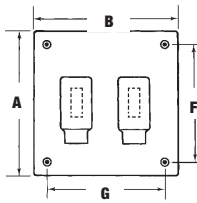

2CFSB

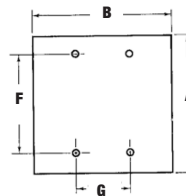

2CFSB

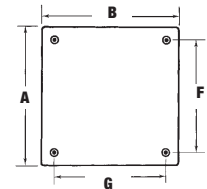

Cat. No.	Description	A (in.)	B (in.)	F (in.)	G (in.)	K (in.)
Two Gang (Cast Aluminum)						
2CWPR-M	Two duplex receptacles – device mount	4-9/16	4-5/8	–	1-13/16	–
2CFSR-M	Single receptacle – hole – device mount	4-9/16	4-5/8	2-3/8	1-13/16	2-1/4
2CFSR-M	Single receptacle – hole – box mount	4-9/16	4-5/8	3-3/4	3-3/4	2-1/4
2CFST	Plunger style cover	4-9/16	4-5/8	3-3/4	3-3/4	–
2CCB	Silver – device mount (grey paint)	4-9/16	4-5/8	3-9/32	1-13/16	–
2CCB-AL	Blank cover – box mount (stamped aluminum)	4-9/16	4-5/8	3-9/32	5-5/8	–
2CFSB	Blank cover – box mount	4-9/16	4-5/8	3-3/4	3-3/4	–

Iberville® FS and FD metallic covers



CDR

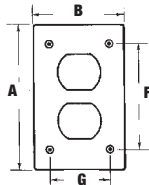

CTS

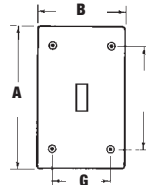

Cat. No.	Description	A (in.)	B (in.)	F (in.)	G (in.)
Single Gang (Cast Aluminum)					
CDR	One duplex receptacle – box mount	4-9/16	2-13/16	3-1/4	1-7/8
CTS	One switch receptacle – box mount	4-9/16	2-13/16	3-1/4	1-7/8



CIFS-4

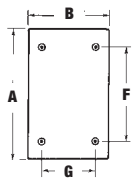

CIFS-7 / CIFS-5

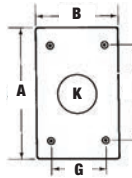

CIFS-6

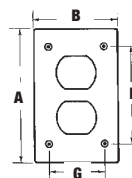

CIFS-9



CIFS-9-HV

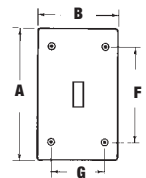

Cat. No.	Description	A (in.)	B (in.)	F (in.)	G (in.)	K (in.)
Single Gang FS Covers (Stamped Aluminum)						
CIFS-4	Blank – single gang – box mount	4-9/16	2-13/16	3-1/4	1-7/8	–
CIFS-5	15 A single receptacle – box mount	4-9/16	2-13/16	3-1/4	1-7/8	1-13/16
CIFS-6	One duplex receptacle – box mount	4-9/16	2-13/16	3-1/4	1-7/8	–
CIFS-7	20 A single locking receptacle – box mount	4-9/16	2-13/16	3-1/4	1-7/8	1-19/32
CIFS-9	One toggle switch – box mount	4-9/16	2-13/16	3-1/4	1-7/8	–
CIFS-9-HV	One toggle switch (347 V) – box mount	4-9/16	2-13/16	3-1/4	1-7/8	–



CRL

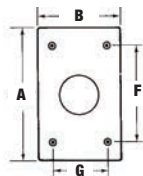

Cat. No.	Description	Nominal Size (in.)	Max. Device Face Dia.	A (in.)	B (in.)	F (in.)	G (in.)
Single Gang (Cast Aluminum)							
CRL	Single receptacle – box mount	1-9/16	1,600	4-9/16	2-13/16	3-1/4	1-7/8
CRS	Single receptacle – box mount	1-3/8	1,395	4-9/16	2-13/16	3-1/4	1-7/8

Covers are approved for dry locations only

Iberville® FS and FD metallic covers

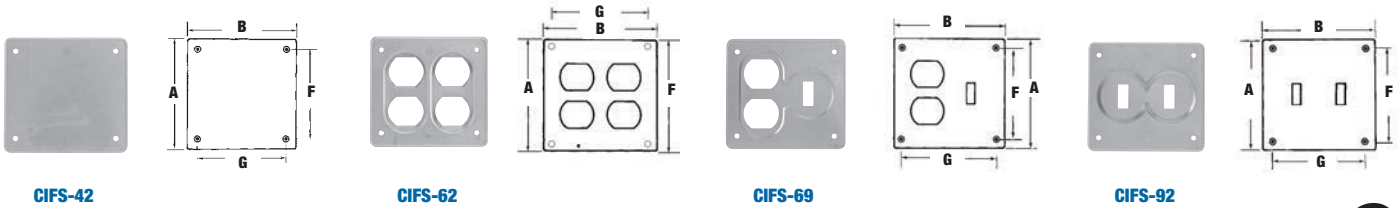

Cat. No.	Description	A (in.)	B (in.)	F (in.)	G (in.)
Two gang FS Covers* (Stamped Aluminum)					
CIFS-42*	Blank – two gang – box mount	4-5/8	4-9/16	3-1/4	3-11/16
CIFS-62*	Two duplex receptacles – box mount	4-5/8	4-9/16	3-1/4	3-11/16
CIFS-69*	One duplex receptacles, one toggle switch – box mount	4-5/8	4-9/16	3-1/4	3-11/16
CIFS-92*	Two toggle switches – box mount	4-5/8	4-9/16	3-1/4	3-11/16

* CIFS covers are CSA approved only

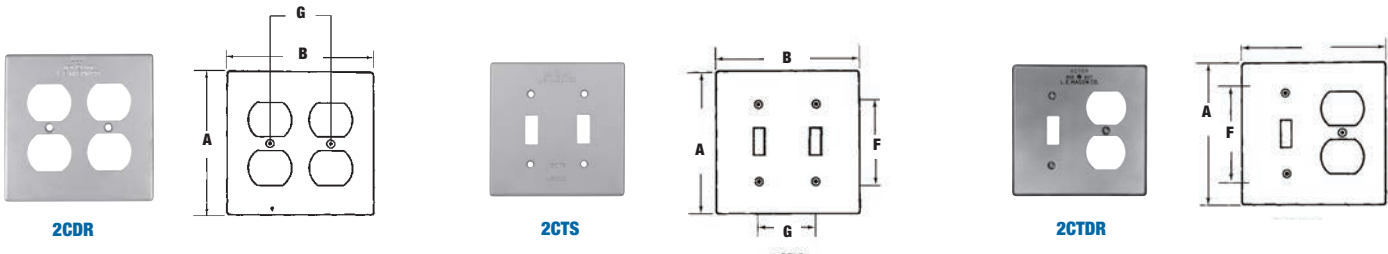

Cat. No.	Description	A (in.)	B (in.)	F (in.)	G (in.)
Two Gang (Cast Aluminum)					
2CDR	Two duplex receptacles – device mount	4-9/16	4-5/8	–	1-13/16
2CTS	Two switch – device mount	4-9/16	4-5/8	2-3/8	1-13/16
2CTDR	One switch and one duplex receptacle – device mount	4-9/16	4-5/8	2-3/8	–

Covers are approved for dry locations only