

CSA, ULI

RIGID PVC CONDUIT FITTINGS - KRALOY

ISSUE DATE:  
DATE D'EMISSION: 2001 06 30

TYPE "LR" ACCESS FITTINGS

SUPERCEDES:  
REPLACE: 2000 12 05

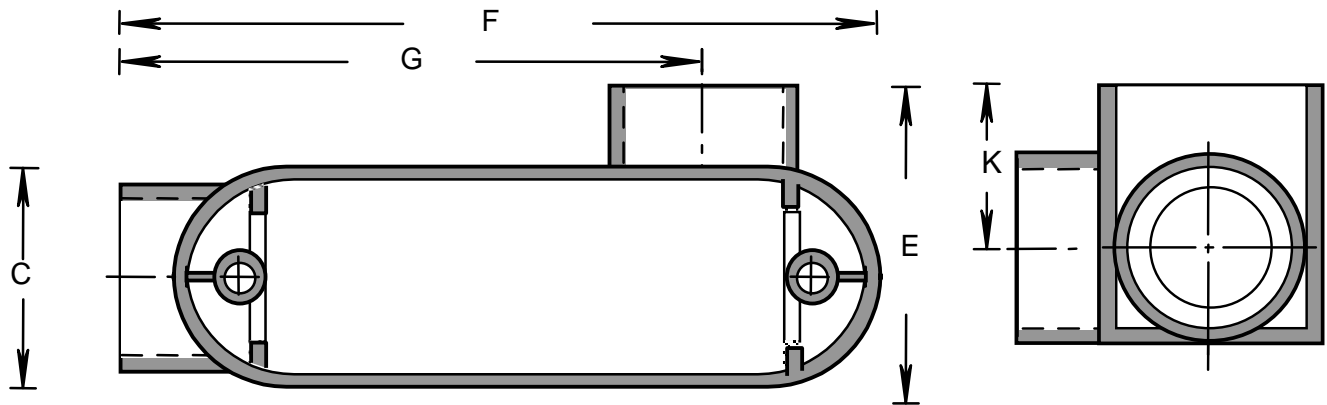

| PRODUCT CODE | PART NUMBER | NOMINAL SIZE |      | C     |      | E     |      | F      |      | G      |      |
|--------------|-------------|--------------|------|-------|------|-------|------|--------|------|--------|------|
|              |             | (in)         | (mm) | (in)  | (mm) | (in)  | (mm) | (in)   | (mm) | (in)   | (mm) |
| 078164       | LR05        | 1/2          | 16   | 1.312 | 33   | 1.898 | 48   | 4.285  | 109  | 3.290  | 84   |
| 078165       | LR07        | 3/4          | 21   | 1.500 | 38   | 2.204 | 56   | 4.970  | 126  | 3.980  | 101  |
| 078166       | LR10        | 1            | 27   | 1.750 | 44   | 2.635 | 67   | 5.900  | 150  | 4.656  | 118  |
| 078167       | LR12        | 1 1/4        | 35   | 2.450 | 62   | 3.246 | 82   | 7.650  | 194  | 6.060  | 154  |
| 078168       | LR15        | 1 1/2        | 41   | 2.468 | 63   | 3.546 | 90   | 7.812  | 198  | 6.180  | 157  |
| 078169       | LR20        | 2            | 53   | 3.062 | 78   | 4.176 | 106  | 9.970  | 253  | 8.055  | 205  |
| 078170       | LR25        | 2 1/2        | 63   | 4.625 | 117  | 5.886 | 150  | 13.750 | 349  | 11.843 | 301  |
| 078171       | LR30        | 3            | 78   | 4.625 | 117  | 5.918 | 150  | 14.250 | 362  | 11.843 | 301  |
| 078172       | LR35        | 3 1/2        | 91   | 5.445 | 138  | 7.178 | 182  | 15.500 | 394  | 12.750 | 324  |
| 078173       | LR40        | 4            | 103  | 5.445 | 138  | 7.178 | 182  | 15.500 | 394  | 12.750 | 324  |

| PRODUCT CODE | PART NUMBER | NOMINAL SIZE |      | K     |      |
|--------------|-------------|--------------|------|-------|------|
|              |             | (in)         | (mm) | (in)  | (mm) |
| 078164       | LR05        | 1/2          | 16   | 0.883 | 22   |
| 078165       | LR07        | 3/4          | 21   | 0.920 | 23   |
| 078166       | LR10        | 1            | 27   | 1.188 | 30   |
| 078167       | LR12        | 1 1/4        | 35   | 1.359 | 35   |
| 078168       | LR15        | 1 1/2        | 41   | 1.360 | 35   |
| 078169       | LR20        | 2            | 53   | 2.016 | 51   |
| 078170       | LR25        | 2 1/2        | 63   | 2.451 | 62   |
| 078171       | LR30        | 3            | 78   | 2.451 | 62   |
| 078172       | LR35        | 3 1/2        | 91   | 2.891 | 73   |
| 078173       | LR40        | 4            | 103  | 2.891 | 73   |

CSA, ULI

RIGID PVC CONDUIT FITTINGS - KRALOY

**ISSUE DATE:**  
**DATE D'EMISSION:** 2001 06 30

TYPE "LR" ACCESS FITTINGS

**SUPERCEDES:**  
**REPLACE:** 2000 12 05

| PRODUCT<br>CODE | PART<br>NUMBER | NOMINAL SIZE |      | FILL VOLUME |         | INSERT<br>CODE | SCREW<br>CODE | REDUCER<br>CODE | COVER<br>CODE | GASKET<br>CODE |
|-----------------|----------------|--------------|------|-------------|---------|----------------|---------------|-----------------|---------------|----------------|
|                 |                | (in)         | (mm) | (cu.in)     | (cu.cm) |                |               |                 |               |                |
| 078164          | LR05           | 1/2          | 16   | 4.2         | 68.9    |                | 072563        |                 | 093106        | 072421         |
| 078165          | LR07           | 3/4          | 21   | 7.6         | 124.6   |                | 072564        |                 | 093107        | 072422         |
| 078166          | LR10           | 1            | 27   | 13.1        | 214.8   |                | 072564        |                 | 093108        | 072735         |
| 078167          | LR12           | 1 1/4        | 35   | 26.6        | 436.2   |                | 072564        |                 | 093109        | 072736         |
| 078168          | LR15           | 1 1/2        | 41   | 39.0        | 639.6   |                | 072564        |                 | 093110        | 072736         |
| 078169          | LR20           | 2            | 53   | 70.9        | 1162.8  |                | 072412        |                 | 093111        | 072738         |
| 078170          | LR25           | 2 1/2        | 63   | 178.5       | 2927.4  | 072419         | 072420        | 097558          | 093112        | 072739         |
| 078171          | LR30           | 3            | 78   | 178.2       | 2922.5  | 072419         | 072420        |                 | 093113        | 072739         |
| 078172          | LR35           | 3 1/2        | 91   | 338.6       | 5553.0  | 072419         | 072420        | 097991          | 093113        | 072740         |
| 078173          | LR40           | 4            | 103  | 338.6       | 5553.0  | 072419         | 072420        |                 | 093114        | 072740         |

**MAXIMUM WIRE FILL**

| <b>1/2" + 3/4" + 1"</b><br><b>(12 + 21 + 27)</b>  |          | <b>1 1/4"</b><br><b>(35)</b> | <b>1 1/2"</b><br><b>(41)</b> | <b>2"</b><br><b>(53)</b> | <b>2 1/2"</b><br><b>(63)</b> | <b>3"</b><br><b>(78)</b> | <b>3 1/2"</b><br><b>(91)</b> | <b>4"</b><br><b>(103)</b> |
|---|----------|------------------------------|------------------------------|--------------------------|------------------------------|--------------------------|------------------------------|---------------------------|
| MAX. WIRE FILL<br>#6 AWG CONDUCTORS<br>OR SMALLER<br>FOR 1":<br>PULLING COMPOUND<br>REQUIRED FOR #4 AWG | <b>U</b> | 2.720"<br>(69.1)             | 4.480"<br>(113.8)            | 5.750"<br>(146.1)        | 7.420"<br>(188.5)            | 7.420"<br>(188.5)        | 8.940"<br>(227.1)            | 7.940"<br>(201.7)         |
|   | <b>M</b> | #2                           | #1 /0                        | #4 /0                    | #300                         | #300                     | #350                         | #350                      |
|   | <b>D</b> | 4.750"<br>(120.7)            | 5.500"<br>(139.7)            | 6.875"<br>(174.6)        | 7.750"<br>(196.9)            | 7.750"<br>(196.9)        | 9.500"<br>(241.3)            | 9.500"<br>(241.3)         |

U UL514 INVESTIGATION OF CONDUIT BODIES FOR THREE CONDUCTOR INSTALLATION WITH NO INVESTIGATION

M MAXIMUM WIRE FILL MARKED ON CONDUIT BODY

D DISTANCE BETWEEN HUBS ON CONDUIT BODY

Filename: KRALOY-08.doc  
Directory: \\Bersrvbdc\bergen\QC MANUAL  
Template: C:\Documents and Settings\joelau\Application  
Data\Microsoft\Templates\Normal.dot  
Title: SOCKET DIMENSION  
Subject:  
Author: joe lau  
Keywords:  
Comments:  
Creation Date: 1/2/2001 8:22 AM  
Change Number: 6  
Last Saved On: 6/28/2001 11:47 AM  
Last Saved By: Joe Lau  
Total Editing Time: 6 Minutes  
Last Printed On: 8/8/2005 12:37 PM  
As of Last Complete Printing  
Number of Pages: 2  
Number of Words: 368 (approx.)  
Number of Characters: 2,103 (approx.)